



27 Drumpellier Crescent, Coatbridge, ML5 1ED

Fixed Asking Price £70,000

- Lower Cottage Flat
- Fitted Kitchen
- South Facing Garden
- EER - D
- Ideal FTB Opportunity
- Large Double Bedroom
- Close to Motorway Network
- Spacious Front Facing Lounge
- Modern 3 Piece Bathroom Suite
- Walking Distance to local Amenities and Station

Approx Gross Internal Area
45 sq m / 486 sq ft

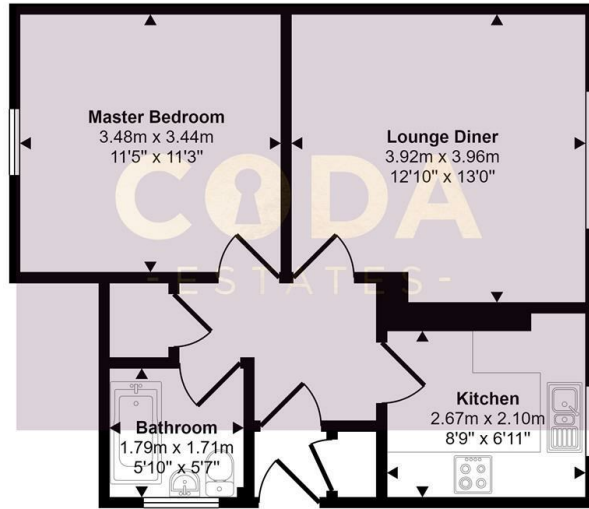

Floorplan

This floorplan is only for illustrative purposes and is not to scale. Measurements of rooms, doors, windows, and any items are approximate and no responsibility is taken for any error, omission or mis-statement. Icons of items such as bathroom suites are representations only and may not look like the real items. Made with Made Snappy 360.

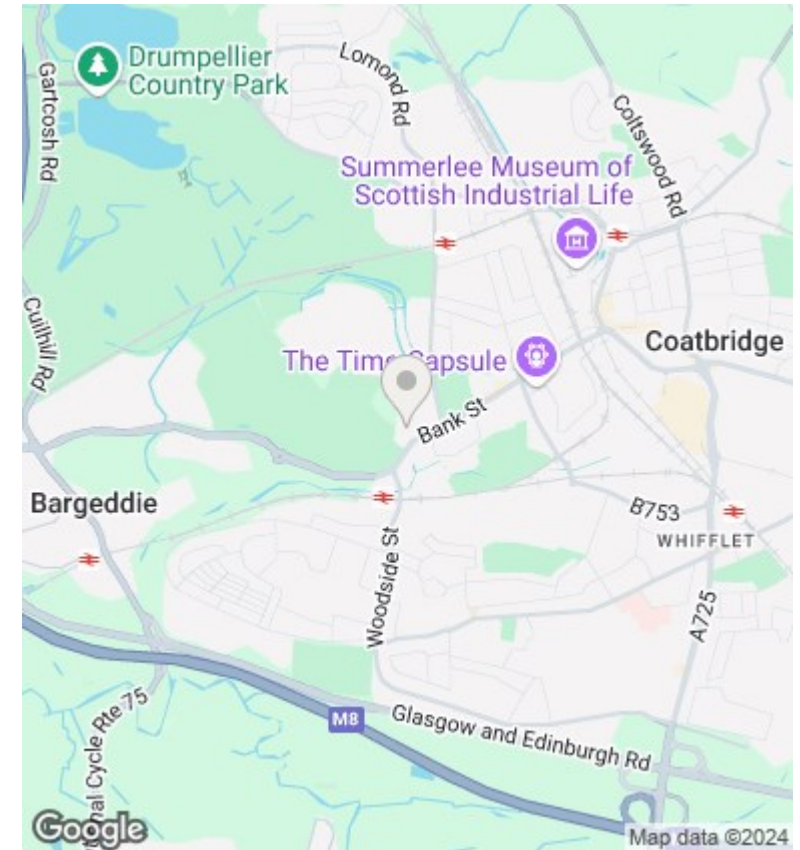

Directions

Viewings

Viewings by arrangement only. Call 01417751050 to make an appointment.

Council Tax Band

A

EPC Rating:

D

Energy Efficiency Rating		Current	Potential
<i>Very energy efficient - lower running costs</i>			
(92 plus)	A		
(81-91)	B		76
(69-80)	C	67	
(55-68)	D		
(39-54)	E		
(21-38)	F		
(1-20)	G		
<i>Not energy efficient - higher running costs</i>			
Scotland		EU Directive 2002/91/EC	