



## Whitby House, 26 Marsh Wall, , London, E14 9AX

- \*Available 8th May 2025\*
- Views from the 10th floor
- 578sqft
- Canary Wharf Station 0.5 miles
- Close to the waterways and River Thames
- One-bedroom apartment
- Lift
- Open plan living
- Close to shops & restaurants
- Situated within the Landmark East Tower development

**£2,100 Per Month**





# Whitby House, 26 Marsh Wall, , London, E14 9AX

## DESCRIPTION

Hunters Tower Bridge are pleased to present this 578sqft, one double bedroom apartment in Whitby House, situated within the Landmark East Tower development. This apartment consists of an open plan living room/kitchen, double bedroom and a white three piece suite bathroom. The apartments design features include a stylish white galley kitchen and neutral beige carpets throughout.

Large floor to ceiling windows offer daylight throughout the apartment, views across Canary Wharf can be seen from the 10th floor. Amid the skyscrapers and waterways, this properties location is perfect for riverside walks and views of the River Thames.

There is also secure bike storage in the building.

Canary Wharf is also home to a wealth of restaurants and boutique shops offering luxury fashion, jewellery and more. Many of the world's most trusted banks and corporate companies can also be reached by foot from this building.

### Transport:

Canary Wharf DLR (0.5 miles)  
Canary Wharf Underground (0.5 miles)  
Heron Quays (335ft)  
West India Quay (0.6 miles)

This properties location enables you to enjoy unparalleled transport connections, including the Jubilee Line, Thames Clipper, Docklands Light Railway and the soon to open Elizabeth line; Canary Wharf is enviably one of London's most important connection hubs.

### Schools

South Quay College - 0.2 miles  
Seven Mills Primary School - 0.3 miles  
River House Montessori School - 0.3 miles









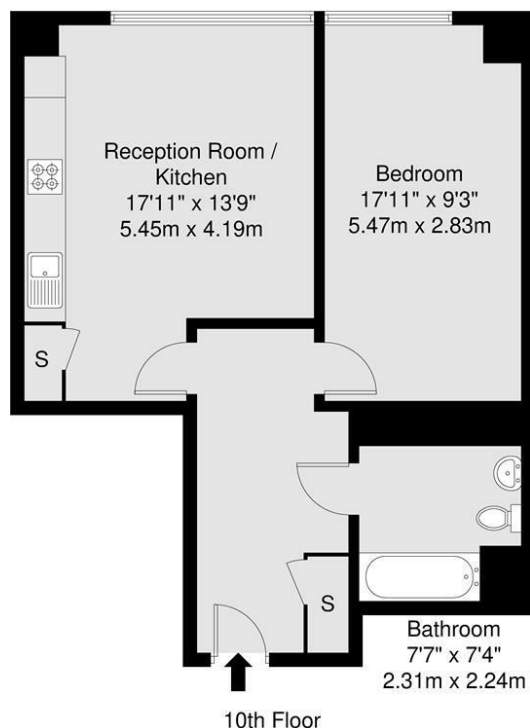

GROSS INTERNAL AREA (GIA)  
The footprint of the property  
54.5 sq m / 586 sq ft

TOTAL STORAGE SPACE  
Storage and wardrobe total area  
1.4 sq m / 15 sq ft

EXTERNAL FEATURES  
Closets, Balcony, Terrace, Verandah etc.  
0.0 sq m / 0.0 sq ft

RESTRICTED HEAD HEIGHT  
Limited use areas under 1.5m  
0.0 sq m / 0.0 sq ft

Disclaimer: Floorplan measurements are approximate and are for illustrative purposes only. While we do not doubt the floorplan accuracy and completeness, you or your advisors should conduct a careful, independent investigation of the property in respect of monetary valuation.

Maison  
VUE

### Viewings

Please contact [towerbridge@hunters.com](mailto:towerbridge@hunters.com), if you wish to arrange a viewing appointment for this property or require further information.

### Valuations

For a valuation of your property, please email the team with your property details, contact information and the times you are available.

## ENERGY PERFORMANCE CERTIFICATE

The energy efficiency rating is a measure of the overall efficacy of a home. The higher the rating the more energy efficient the home is and the lower the fuel bills will be.

Energy Efficiency Rating		
	Current	Potential
Very energy efficient - lower running costs		
(92 plus) <b>A</b>		
(81-91) <b>B</b>	83	83
(69-80) <b>C</b>		
(55-68) <b>D</b>		
(39-54) <b>E</b>		
(21-38) <b>F</b>		
(1-20) <b>G</b>		
Not energy efficient - higher running costs		
<b>England &amp; Wales</b>	EU Directive 2002/91/EC	

These particulars are intended to give a fair and reliable description of the property but no responsibility for any inaccuracy or error can be accepted and do not constitute an offer or contract. We have not tested any services or appliances (including central heating if fitted) referred to in these particulars and the purchasers are advised to satisfy themselves as to the working order and condition. If a property is unoccupied at any time there may be reconnection charges for any switched off/disconnected or drained services or appliances - All measurements are approximate.

**THINKING OF SELLING?** If you are thinking of selling your home or just curious to discover the value of your property, Hunters would be pleased to provide free, no obligation sales and marketing advice. Even if your home is outside the area covered by our local offices we can arrange a Market Appraisal through our national network of Hunters estate agents.