



Woodley Crescent, , London, NW2 2DL

- *Available 01/08/2024*
- One Bathroom
- 550 Approx sq ft
- EPC - B
- One Bedroom
- 1st Floor Apartment
- Communal gardens

£1,880 Per Month



Woodley Crescent, , London, NW2 2DL

DESCRIPTION

Welcome to this charming property located on Woodley Crescent in the heart of London, NW2. This delightful flat boasts a modern design and was purpose-built in 2018, offering a fresh and contemporary living space.

As you step into the property, you are greeted by a cosy reception room, perfect for relaxing or entertaining guests. The bedroom provides a peaceful retreat, ideal for a good night's sleep after a long day. The bathroom offers convenience and style, completing the comfort of this lovely flat.

With a total of 581 sq ft of living space, this property provides ample room for all your needs. Whether you are looking for a starter home or a cosy city retreat, this flat offers a perfect blend of comfort and style.

Situated in a prime location in London, NW2, this property provides easy access to all the amenities and attractions the city has to offer. From trendy cafes to beautiful parks, everything you need is just a stone's throw away.

Don't miss the opportunity to make this charming flat your new home. Contact us today to arrange a viewing and experience the beauty and convenience of living in Woodley Crescent.



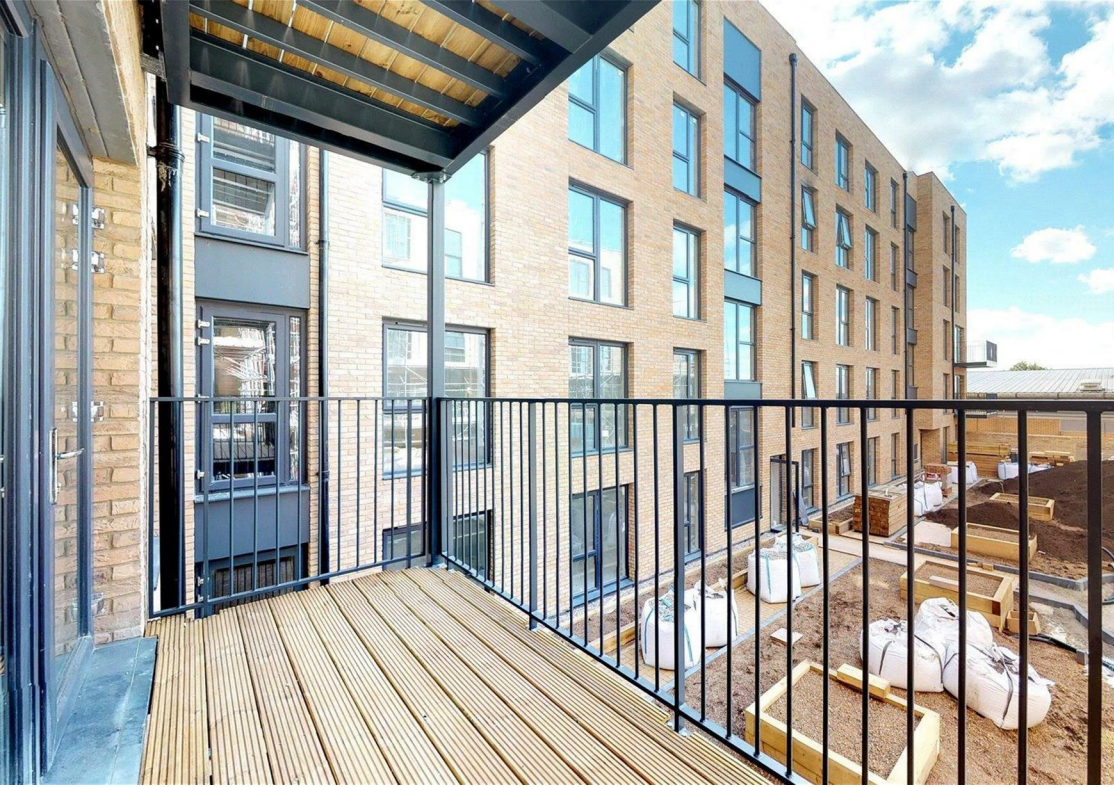



Viewings

Please contact towerbridge@hunters.com, if you wish to arrange a viewing appointment for this property or require further information.

Valuations

For a valuation of your property, please email the team with your property details, contact information and the times you are available.

ENERGY PERFORMANCE CERTIFICATE

The energy efficiency rating is a measure of the overall efficacy of a home. The higher the rating the more energy efficient the home is and the lower the fuel bills will be.

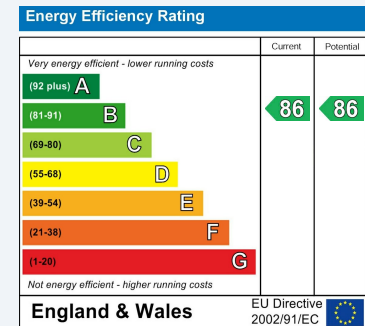

These particulars are intended to give a fair and reliable description of the property but no responsibility for any inaccuracy or error can be accepted and do not constitute an offer or contract. We have not tested any services or appliances (including central heating if fitted) referred to in these particulars and the purchasers are advised to satisfy themselves as to the working order and condition. If a property is unoccupied at any time there may be reconnection charges for any switched off/disconnected or drained services or appliances - All measurements are approximate.

THINKING OF SELLING? If you are thinking of selling your home or just curious to discover the value of your property, Hunters would be pleased to provide free, no obligation sales and marketing advice. Even if your home is outside the area covered by our local offices we can arrange a Market Appraisal through our national network of Hunters estate agents.

