

85 Royal Mint Street, , London, E1 8RD

- *AVAILABLE 27th June 2024*
- Studio Apartment
- 24 Hour Concierge
- Close to the city
- Situated near Tower Bridge
- *360 Virtual Tour Available*
- 8th Floor
- Underfloor heating and comfort cooling throughout the property
- Close to transportation
- Gym, Swimming Pool, Residents lounge, Cinema,

£2,250 Per Month



85 Royal Mint Street, , London, E1 8RD

DESCRIPTION

*AVAILABLE 27/06/2024 * *360 Virtual Tour Available*

Hunters Tower Bridge presents you with this luxurious one-bedroom apartment situated in one of London's most prestigious developments, Royal Mint Gardens E1.

This esteemed property is popular for the modernised lifestyle it offers to every resident, with its reindustrialized internal specifications such as underfloor heating, comfort cooling, engineered timber flooring and dimmer lights.

The kitchen is fitted with new Siemens appliances which incorporate a washing machine, dishwasher, induction hob, microwave, oven, extractor fans and integrated fridge freezers which all come with a Siemens. On top of everything else, this apartment also gifts you with floor-to-ceiling windows which allow you to admire the outstretching views of the city.

Sitting in the heart of history, commerce and culture, the Royal Mint Street is a desired location for many and is conveniently surrounded by stations such as Tower Hill and Tower Gateway Tube Stations (also in close proximity to the iconic Tower Bridge and Tower of London). Minutes away from St Katherine's Dock where you'll be greeted with an abundance of local amenities as well as a selection of fancy restaurants, cafes and a variety of shops and markets.

Royal Mint Gardens features a 24-hour concierge at your request and many other leisure activities such as: a fully equipped gym, a residents lounge, a cinema room, a swimming pool/jacuzzi, a yoga room and a treatment room.

Get in touch with our Hunters team in Tower Bridge for more details.





HUNTERS

JRL GROUP

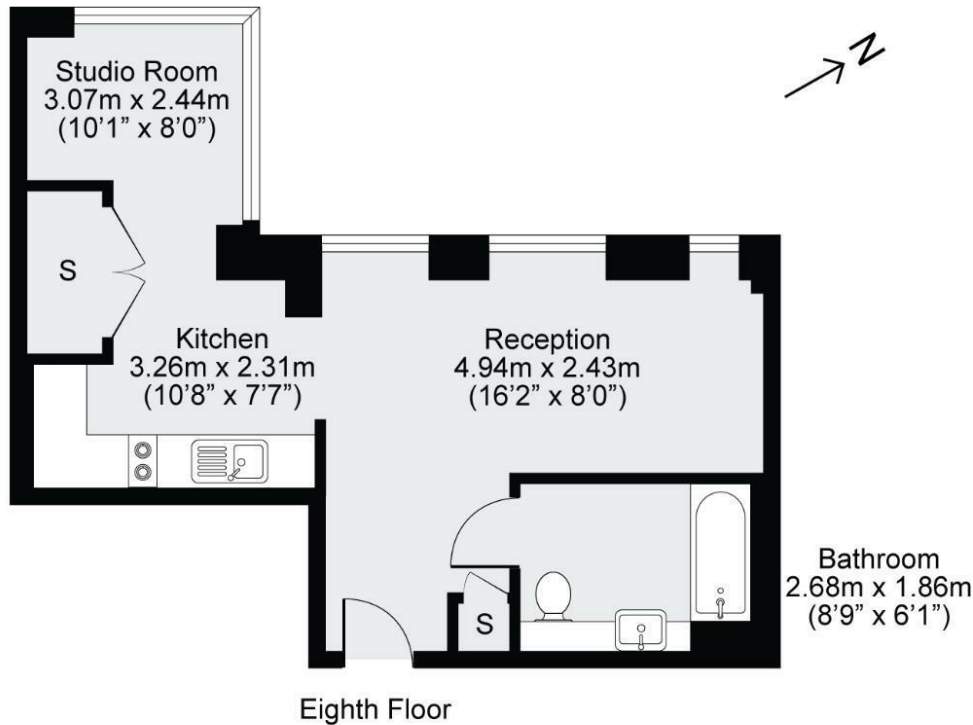

GROSS INTERNAL AREA (GIA)
The footprint of the property
40.2sqm / 432.7sqft

TOTAL STORAGE SPACE
Storage and wardrobe total area
1.8sqm / 19.4sqft

EXTERNAL STRUCTURAL FEATURES
Garden, Balcony, Terrace, Verandah etc.
0.0sqm / 0.0sqft

RESTRICTED HEAD HEIGHT
Limited use area under 1.5m
0.0 sqm / 0.0sqft

Disclaimer: Floorplan measurements are approximate and are for illustrative purposes only. While we do not doubt the floorplan accuracy and completeness, you or your advisors should conduct a careful, independent investigation of the property in respect of monetary valuation.

Maison
VUE

Viewings

Please contact towerbridge@hunters.com, if you wish to arrange a viewing appointment for this property or require further information.

Valuations

For a valuation of your property, please email the team with your property details, contact information and the times you are available.

ENERGY PERFORMANCE CERTIFICATE

The energy efficiency rating is a measure of the overall efficacy of a home. The higher the rating the more energy efficient the home is and the lower the fuel bills will be.

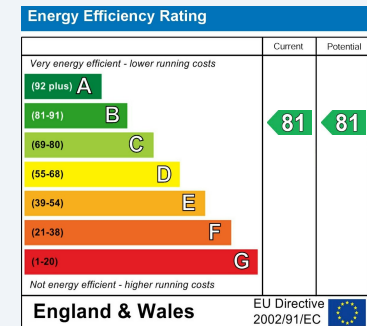

These particulars are intended to give a fair and reliable description of the property but no responsibility for any inaccuracy or error can be accepted and do not constitute an offer or contract. We have not tested any services or appliances (including central heating if fitted) referred to in these particulars and the purchasers are advised to satisfy themselves as to the working order and condition. If a property is unoccupied at any time there may be reconnection charges for any switched off/disconnected or drained services or appliances - All measurements are approximate.

THINKING OF SELLING? If you are thinking of selling your home or just curious to discover the value of your property, Hunters would be pleased to provide free, no obligation sales and marketing advice. Even if your home is outside the area covered by our local offices we can arrange a Market Appraisal through our national network of Hunters estate agents.