



3 Bed  
House - Semi-  
Detached  
located in  
Pontefract  
£230,000



**LOGIC**  
REAL ESTATE

Featherstone Lane  
Featherstone  
Pontefract  
WF7 6LS



This three bedroom semi-detached house on Featherstone Lane offers a perfect blend of comfort and convenience. With three well-proportioned bedrooms, this property is ideal for families or those seeking extra space. The location is particularly appealing, with local amenities and transport links within easy reach, making commuting and daily errands a breeze. Featherstone itself is known for its friendly community and offers a range of shops, schools, and parks, with everything you need on your doorstep. There is also A Gated Private Driveway At The Rear for extra parking.

To the ground floor you will find, the living room, kitchen, utility room, the staircase leading down to the cellar and the staircase leading to the first floor. To the first floor there are three bedrooms and the family bathroom.

To the front exterior, the property is set behind a wrought-iron gated entrance with gold accents, paired with a low brick boundary wall for both privacy and kerb appeal. A neatly kept front pathway leads to the entrance, while the surrounding homes give the street a traditional, established feel. To the rear, the property offers a generous, low-maintenance outdoor space ideal for relaxing or entertaining. A mix of paved patio areas and decorative gravel beds provides a practical layout. The garden is fully enclosed with fencing for privacy and features borders stocked with plants and shrubs along the edges. A detached garage provides useful storage or parking, while the open layout ensures plenty of natural light throughout the day. The rear elevation of the home showcases classic brickwork and a raised decking step that leads seamlessly into the garden.

#### Entrance Hall 14' x 3'3"

A composite front entrance door leads into a spacious hallway with access into the lounge and kitchen. Staircase leads to the first floor. Laminate wood-effect flooring and gas central heating radiator.

#### Lounge 11'3" x 13'8"

Decorative fireplace with hearth and surround. Feature wall lights and decorative coving and ceiling rose. Central heated radiator. UPVC double-glazed window to the front elevation.

#### Dining Kitchen 13'9" x 14'2"

Fitted with a range of shaker-style wall and base units with complementary work surfaces. Composite white sink with drainer and mixer tap. Part tiled walls. The chimney breast provides an inset space suitable for a freestanding double range-style cooker. Breakfast bar. Gas central heating radiator. UPVC double-glazed window to the rear elevation. Access into the cellar and the utility room.

#### Utility Room 9'7" x 7'9"

Fitted base units with laminate work surfaces. Space for a slimline dishwasher and freestanding washing machine. Stainless steel sink with drainer and mixer tap. Gas central heating radiator, UPVC double-glazed window to the rear elevation and UPVC double-glazed external door leading to the rear.

#### Cellar 11'1" x 6'4"

Useful storage space housing the wall-mounted boiler. Central heated radiator.

#### First Floor

##### Landing 16'1" x 5'10"

Provides access to three bedrooms and the family bathroom. Loft access. Central heated radiator. Carpeted throughout.

##### Bathroom 10'12" x 7'11"

UPVC double-glazed window to the side elevation. Fitted with a freestanding shower cubicle with wall-mounted electric shower, panelled bath with chrome mixer tap, wash basin with chrome mixer tap and vanity unit beneath, and a low-level flush WC. Part tiled walls, tiled flooring, and gas central heating radiator.

##### Bedroom One 13'11" x 11'5"

Fitted with a range of wardrobes and built-in vanity furniture. Double-glazed window to the rear elevation. Gas central heating radiator.

##### Bedroom Two 11'4" x 10'10"

UPVC double-glazed window to the front elevation. Gas central heating radiator.

##### Bedroom Three 8' x 6'4"

UPVC double-glazed window to the front elevation. Gas central heating radiator.

#### Exterior

##### Front Garden

Enclosed front garden with a side pathway leading to the rear.

##### Rear Garden

An enclosed rear garden featuring patio and decking areas, outdoor electric sockets, a brick-built garage, and rear access gate.

##### Garage

Freestanding single garage with up-and-over door.





#### Entrance Hall 14' x 3'3"

A composite front entrance door leads into a spacious hallway with access into the lounge and kitchen. Staircase leads to the first floor. Laminate wood-effect flooring and gas central heating radiator.

#### Lounge 11'3" x 13'8"

Decorative fireplace with hearth and surround. Feature wall lights and decorative coving and ceiling rose. Central heated radiator. UPVC double-glazed window to the front elevation.

#### Dining Kitchen 13'9" x 14'2"

Fitted with a range of shaker-style wall and base units with complementary work surfaces. Composite white sink with drainer and mixer tap. Part tiled walls. The chimney breast provides an inset space suitable for a freestanding double range-style cooker. Breakfast bar. Gas central heating radiator. UPVC double-glazed window to the rear elevation. Access into the cellar and the utility room.

#### Utility Room 9'7" x 7'9"

Fitted base units with laminate work surfaces. Space for a slimline dishwasher and freestanding washing machine. Stainless steel sink with drainer and mixer tap. Gas central heating radiator, UPVC double-glazed window to the rear elevation and UPVC double-glazed external door leading to the rear.

#### Cellar 11'1" x 6'4"

Useful storage space housing the wall-mounted boiler. Central heated radiator.

#### First Floor

#### Landing 16'1" x 5'10"

Provides access to three bedrooms and the family bathroom. Loft access. Central heated radiator. Carpeted throughout.

#### Bathroom 10'12" x 7'11"

UPVC double-glazed window to the side elevation. Fitted with a freestanding shower cubicle with wall-mounted electric shower, panelled bath with chrome mixer tap, wash basin with chrome mixer tap and vanity unit beneath, and a low-level flush WC. Part tiled walls, tiled flooring, and gas central heating radiator.

#### Bedroom One 13'11" x 11'5"

Fitted with a range of wardrobes and built-in vanity furniture. Double-glazed window to the rear elevation. Gas central heating radiator.

#### Bedroom Two 11'4" x 10'10"

UPVC double-glazed window to the front elevation. Gas central heating radiator.

#### Bedroom Three 8' x 6'4"

UPVC double-glazed window to the front elevation. Gas central heating radiator.

#### Exterior

##### Front Garden

Enclosed front garden with a side pathway leading to the rear.

##### Rear Garden

An enclosed rear garden featuring patio and decking areas, outdoor electric sockets, a brick-built garage, and rear access gate.

##### Garage

Freestanding single garage with up-and-over door.



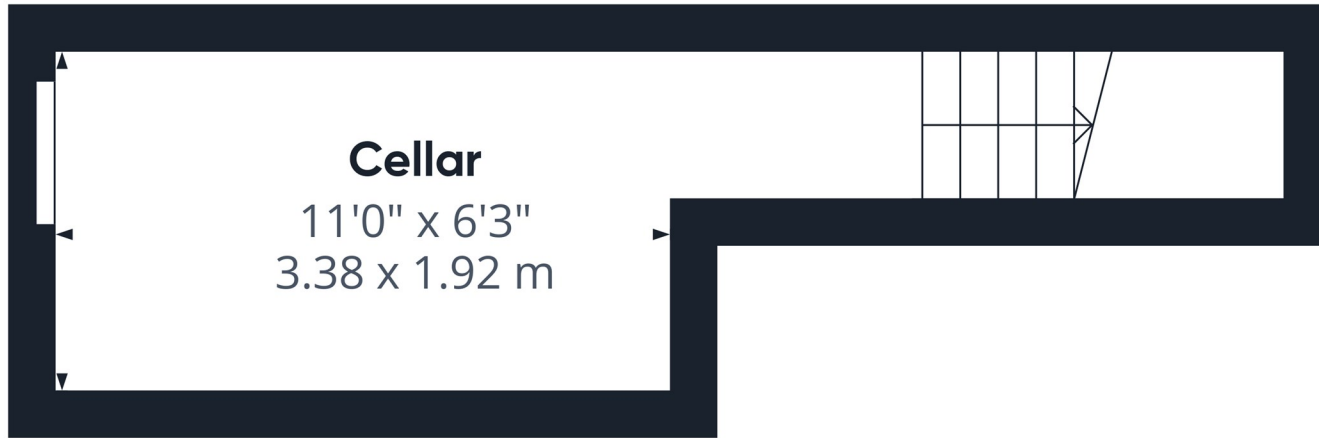

**Approximate total area<sup>(1)</sup>**  
102 ft<sup>2</sup>  
9.5 m<sup>2</sup>

(1) Excluding balconies and terraces

Calculations reference the RICS IPMS 3C standard. Measurements are approximate and not to scale. This floor plan is intended for illustration only.

GIRAFFE360



Floor -1

Energy Efficiency Rating		
	Current	Potential
Very energy efficient - lower running costs		
(92 plus) <b>A</b>		<b>81</b>
(81-91) <b>B</b>		
(69-80) <b>C</b>		
(55-68) <b>D</b>		
(39-54) <b>E</b>	<b>56</b>	
(21-38) <b>F</b>		
(1-20) <b>G</b>		
Not energy efficient - higher running costs		
England & Wales <small>EU Directive 2002/91/EC</small>		

## CONTACT

30 Newgate  
Pontefract  
West Yorkshire  
WF8 1DB

E: [info@logicrealestate.co.uk](mailto:info@logicrealestate.co.uk)  
T: 01977 700595

**LOGIC**  
REAL ESTATE