



2 Bed House - Semi-Detached

16 Castle View, Duffield, Belper DE56 4DN
Offers Around £245,000 Freehold



**Fletcher
& Company**

www.fletcherandcompany.co.uk

- Ideal for First Time Buyer/Couple – No Chain
- Popular Semi-Detached Home
- Ecclesbourne School Catchment Area
- A Short Walk to Duffield Village Amenities including Bus/Rail Services
- Lounge
- Kitchen/Dining Room
- Two Double Bedrooms & Bathroom
- South Facing Garden
- Driveway for Two/Three Cars
- Cul-de-Sac Location

ECCLESBOURNE SCHOOL CATCHMENT AREA – this two-bedroom semi-detached house offers a perfect blend of comfort and convenience. With its prime location in Duffield, residents will find themselves just a stone's throw away from local shops, as well as excellent bus and train services, making commuting and daily errands a breeze.

Upon entering the property, you are welcomed into a lounge, kitchen/dining room, two generously sized bedrooms and bathroom.

One of the standout features of this home is the south-facing garden, which bathes in sunlight throughout the day. Additionally, the property includes a driveway that accommodates up to three vehicles, providing ample parking for residents and visitors alike.

No Chain Involved.

The Location

The village of Duffield provides an excellent range of amenities including a varied selection of shops, post office, library, historic St Alkmund's Church and a selection of good restaurants, medical facilities and schools including The Meadows, William Gilbert Primary Schools and the noted Ecclesbourne Secondary School. There is a regular train service into Derby City centre which lies some 5 miles to the south of the village. Local recreational facilities within the village include squash, tennis, cricket, football, rugby and the noted Chevin Golf course. A further point to note is that the Derwent Valley, in which the village of Duffield nestles, is one of the few world heritage sites and is surrounded by beautiful countryside.

Accommodation

Ground Floor

Storm Porch

With half glazed entrance door.

Lounge

14'8" x 13'6" (4.49 x 4.12)

With fireplace with gas fire, radiator, understairs storage cupboard, sealed unit double glazed window to front and staircase leading to first floor.



Kitchen/Dining Room

13'6" x 9'3" (4.13 x 2.83)

With one and a half sink unit with mixer tap, wall and base cupboards with matching worktops, plumbing for automatic washing machine, electric oven, space for fridge/freezer, wall mounted Worcester boiler, tile flooring, radiator, two sealed unit double glazed windows to rear and half glazed door giving access to south facing rear garden.



First Floor Landing

6'1" x 3'2" (1.87 x 0.98)

With built-in storage cupboard and access to roof space.

Double Bedroom One

13'1" x 10'3" (3.99 x 3.13)

With built-in cupboard, radiator, two sealed unit double glazed windows and internal panelled door.



Double Bedroom Two

11'2" x 7'1" (3.42 x 2.17)

With radiator and sealed unit double glazed window to rear.



Bathroom

7'9" x 6'2" (2.37 x 1.88)

With bath with Mira shower over with shower screen door, pedestal wash handbasin, low level WC, tile splashbacks, radiator and sealed unit double glazed window to rear.



Garden

To the rear of the property is a south facing enclosed rear garden with patio and fencing.



Driveway

To the front and side of the property is block paved driveway providing car standing spaces for two/three vehicles.

Council Tax Band - C

Amber Valley

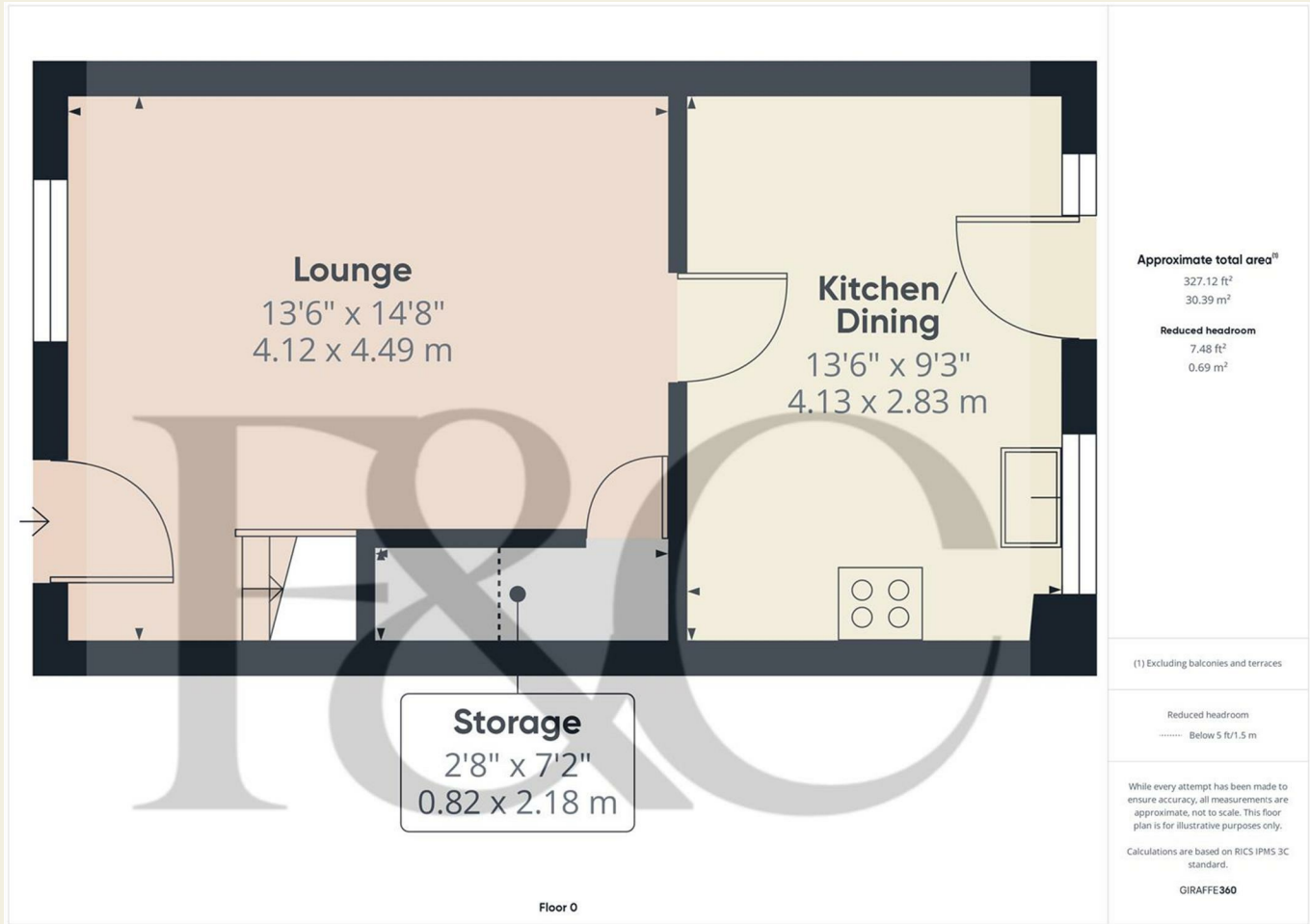

These particulars do not constitute an offer or a contract neither do they form part of an offer or contract. The vendor does not make or give and Messrs. Fletcher & Company nor any person employed has any authority to make or give any representation or warranty, written or oral, in relation to this property. Whilst we endeavour to make our sales details accurate and reliable, if there is any point which is of particular importance to you, please contact the office and we will be pleased to check the information for you, particularly if contemplating travelling some distance to view the property. None of the services or appliances to the property have been tested and any prospective purchasers should satisfy themselves as to their adequacy prior to committing themselves to purchase.

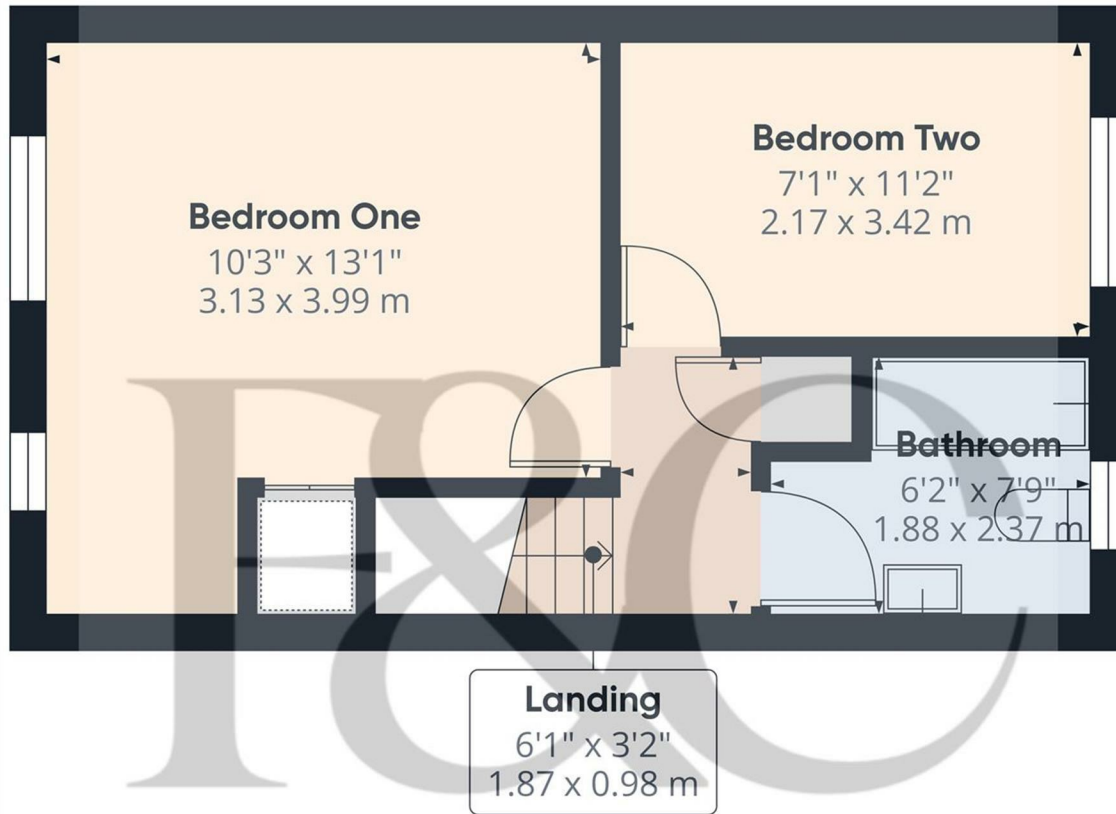

Approximate total area⁽¹⁾
300.32 ft²
27.9 m²

(1) Excluding balconies and terraces

While every attempt has been made to ensure accuracy, all measurements are approximate, not to scale. This floor plan is for illustrative purposes only.

Calculations are based on RICS IPMS 3C standard.

GIRAFFE360

Floor 1

Energy Efficiency Rating

	Current	Potential
Very energy efficient - lower running costs		
(92 plus) A		88
(81-91) B		
(69-80) C	72	
(55-68) D		
(39-54) E		
(21-38) F		
(1-20) G		
Not energy efficient - higher running costs		
England & Wales		EU Directive 2002/91/EC 

Environmental Impact (CO₂) Rating

	Current	Potential
Very environmentally friendly - lower CO2 emissions		
(92 plus) A		
(81-91) B		
(69-80) C		
(55-68) D		
(39-54) E		
(21-38) F		
(1-20) G		
Not environmentally friendly - higher CO2 emissions		
England & Wales		EU Directive 2002/91/EC 

These particulars do not constitute an offer or a contract neither do they form part of an offer or contract. The vendor does not make or give and Messrs. Fletcher & Company nor any person employed has any authority to make or give any representation or warranty, written or oral, in relation to this property. Whilst we endeavour to make our sales details accurate and reliable, if there is any point which is of particular importance to you, please contact the office and we will be pleased to check the information for you, particularly if contemplating travelling some distance to view the property. None of the services or appliances to the property have been tested and any prospective purchasers should satisfy themselves as to their adequacy prior to committing themselves to purchase.