



---

3 Bed House - Terraced

107 Institute Street  
Stanton Hill  
Sutton-In-Ashfield  
NG17 3HD

£775 Per Calendar Month

---

Fletcher  
& Company



107 Institute Street  
Sutton-In-Ashfield  
NG17 3HD



- AVAILABLE SOON AND LONG TERM
- REDECORATED
- BRAND NEW CARPETS THROUGHOUT
- NEWLY FITTED KITCHEN
- NEWLY FITTED SHOWER ROOM
- THREE BEDROOMS - TWO DOUBLE
- TWO LARGE RECEPTION ROOMS
- ON STREET PARKING
- AMAZING LOCATION, CLOSE TO AMENITIES AND TRANSPORT LINKS
- END TERRACE WITH SIDE ACCESS ALSO

A Three bedroom end-terrace property situated off High Street, close to local shopping facilities and a short drive from the amenities available in Mansfield Town Centre including Mansfield Train Station. Brierley Forest Park is also nearby.

The property has been tastefully redecorated throughout, new carpets and flooring and a brand new kitchen and and three piece shower room.

Outside: to the rear there is a good sized rear garden which is mainly laid to lawn, to the front is on street parking.

Available early October 2024. Council Tax Band A and available on a long term basis.



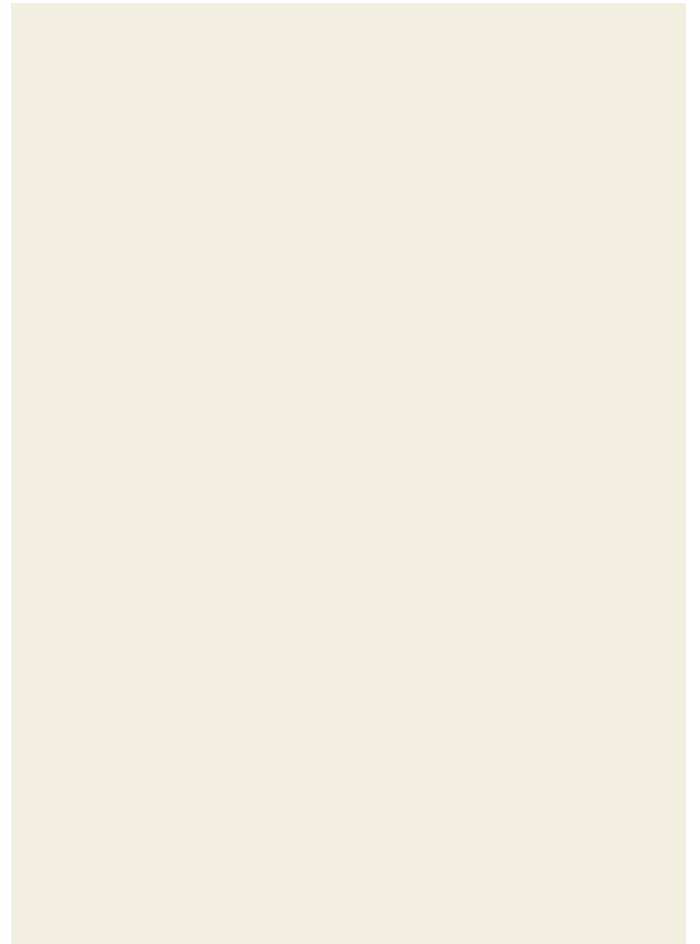
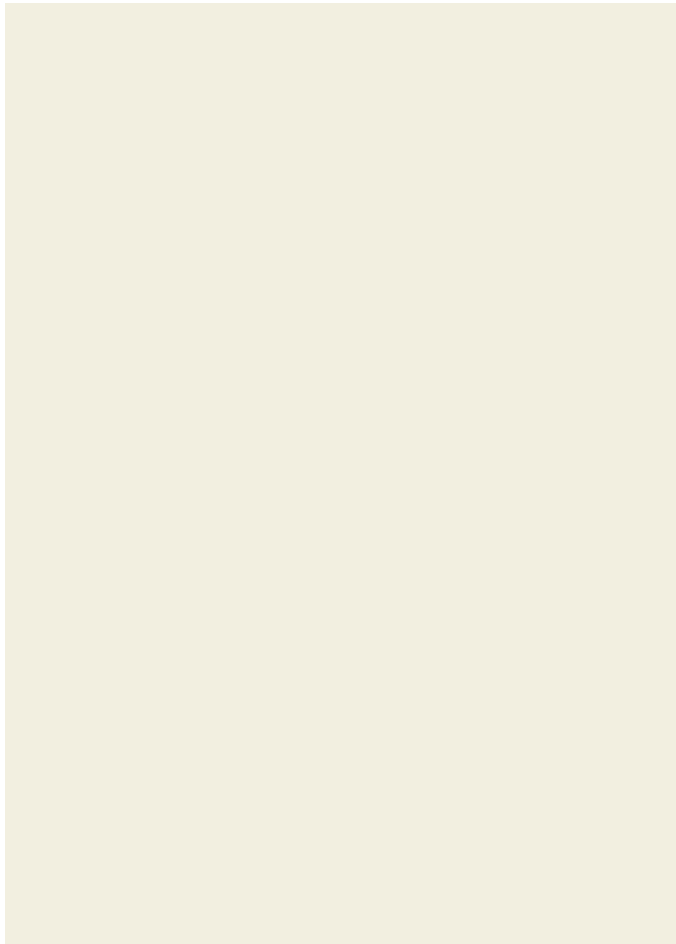
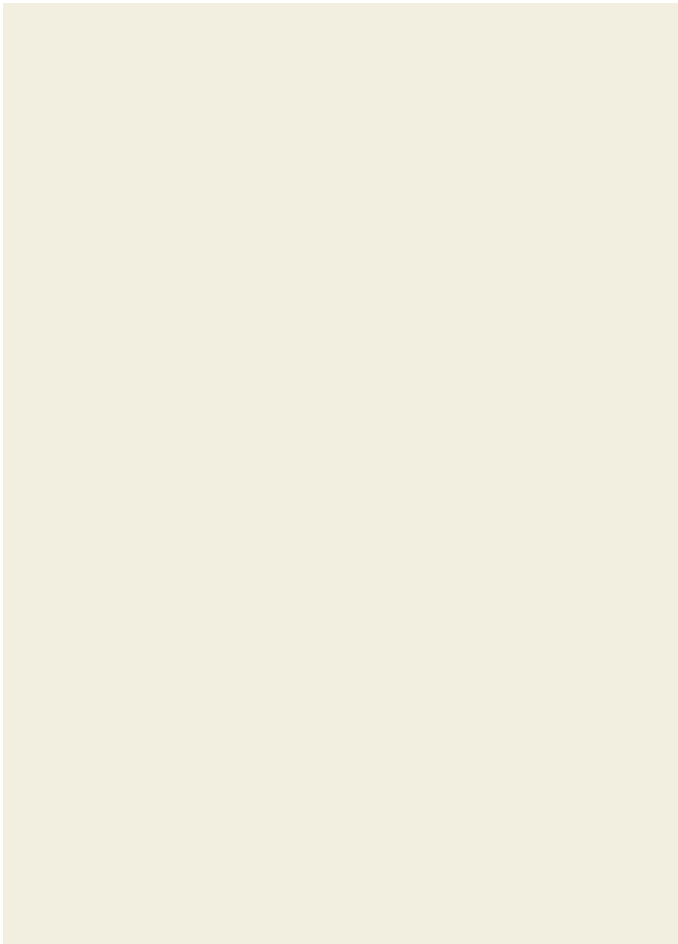



Duffield House  
 Town Street  
 Duffield  
 Derbyshire  
 DE56 4GD

T: 01332 843390

E: [duffield@fletcherandcompany.co.uk](mailto:duffield@fletcherandcompany.co.uk)  
[www.fletcherandcompany.co.uk](http://www.fletcherandcompany.co.uk)

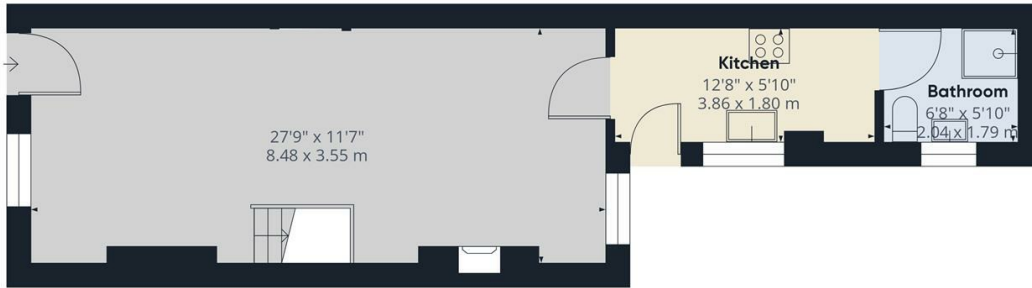
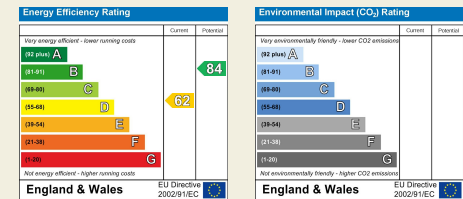

Floor 0



Floor 1

Approximate total area<sup>(1)</sup>

779.74 ft<sup>2</sup>  
 72.44 m<sup>2</sup>

(1) Excluding balconies and terraces

While every attempt has been made to ensure accuracy, all measurements are approximate, not to scale. This floor plan is for illustrative purposes only.

Calculations are based on RICS IPMS 3C standard.

GIRAFFE360

These particulars do not constitute an offer or a contract neither do they form part of an offer or contract. The vendor does not make or give and Messrs. Fletcher & Company nor any person employed has any authority to make or give any representation or warranty, written or oral, in relation to this property. Whilst we endeavour to make our sales details accurate and reliable, if there is any point which is of particular importance to you, please contact the office and we will be pleased to check the information for you, particularly if contemplating travelling some distance to view the property. None of the services or appliances to the property have been tested and any prospective purchasers should satisfy themselves as to their adequacy prior to committing themselves to purchase.

Fletcher  
 & Company