



Manor Drive North, KT3 5NY

Open To Offers £695,000



Manor Drive North, KT3 5NY

Having been enjoyed for over 50 years by my client's family, a clear a testament to a good family home.

This conveniently situated, well-proportioned 3-bedroom detached house has been extended to the rear to provide a generous reception and Kitchen breakfast room.

A great head start for those looking for a good family home to to move in to, having undergone extensive refurbishment work and ready to occupy once flooring goes down. With further potential to extend and attractively priced given the work already carried out.

- Detached
- Extended and Newly Refurbished
- New Gas Central Heating Boiler
- Rewired
- New Kitchen
- New Bathroom
- Garage and Carport
- NO FORWARD CHAIN

Well connected, a few minutes level walk of Malden Manor (zone 4) mainline station and easy reach of both Worcester Park and New Malden stations bringing London Waterloo within 1/2 hr. Good local busses and the A3 London - M25

Conveniently situated a couple of minutes of a local parade of shops including a co-op. Yet only short walk in to New Malden with it's bustling High Street, boasting Marks and Spencer and Waitrose key stores amongst an enviable diversity of retail and eateries.

Surrounded by comprehensive sports, leisure amenities, green spaces including the Hogsmill Green Belt , blessed with a deep sense of community and excellent schools makes a great location for a this long term family home. Viewing is a must!

Royal Borough Of Kingston Upon Thames C Tax Band F

Energy Performance Certified Band D



Ground Floor

Approx. 59.1 sq. metres (635.9 sq. feet)

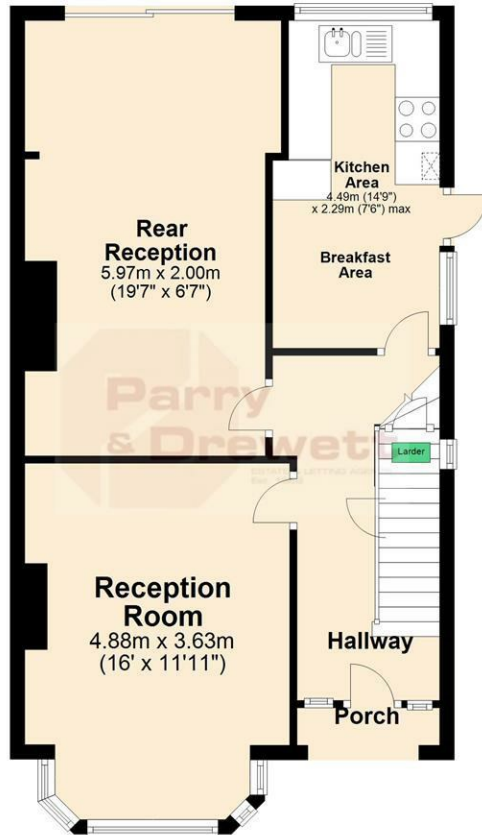

First Floor

Approx. 48.4 sq. metres (521.1 sq. feet)

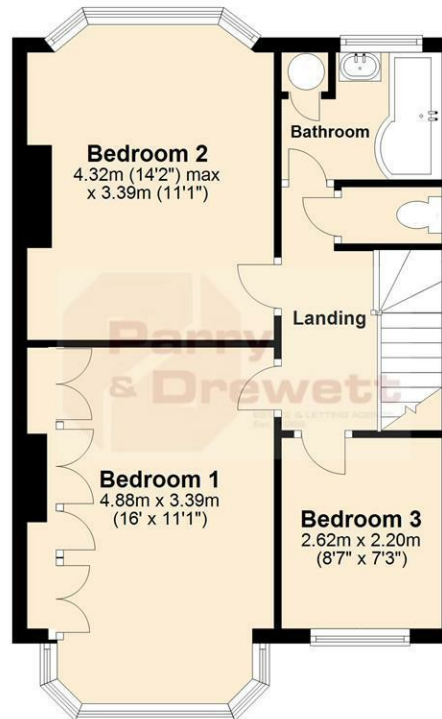

Total area: approx. 107.5 sq. metres (1157.1 sq. feet)

Whilst every effort is taken to ensure the accuracy of these details the floor plan should only be viewed as indicative and any sizes are not exact
Plan produced using PlanUp.

