



Haddon Close, KT3 6DP

Guide Price £600,000





Haddon Close, KT3 6DP

A rare opportunity to acquire a much-cherished property, in a sort after neighbourhood, having been over 50 years, in my client's family, the true testimony to home. Offering further potential to the fortunate buyer.

Haddon Close is a great secret, a quiet cu-de-sac, ultra convenient, within a few minutes level walk of New Malden's bustling High Street with its diverse retail and eateries. Renowned for which New Malden has been gaining a reputation, now with added kudos of not only Anchor store, Waitrose but the arrival of Marks and Spencer.

With comprehensive sports and leisure amenities, ready access to green space and excellent provision of both local and surrounding schools, make New Malden an appreciated growing destination to settle.

Within 15 minutes' walk of a zone 4 main line station, direct to London Waterloo (27 Mins), also provides good connections to amongst other destinations, Kingston, Surbiton Twickenham, and Teddington. With similarly comprehensive bus services to hand good access to the A3.



- Gas Central Heating
- Extended 31' 6" Living/ Dining Room
- 3 Double Bedrooms and flexible Study space
- Comfortable Southerly aspect rear garden
- NO FORWARD CHAIN
- Double Glazing and Solar Panels
- 18' Kitchen/Breakfast Room
- Detached Garage with good acces by wide driveway
- Work shop, garden sheds and sauna

Royal Borough Kingsto upon Thames Council Tax Band E

Energy Performance Certificate band C



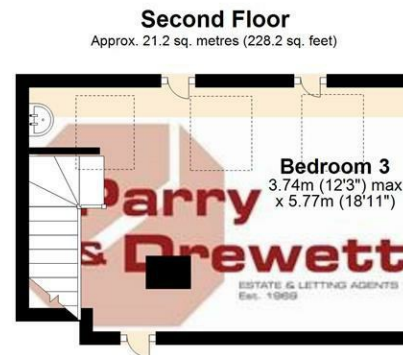
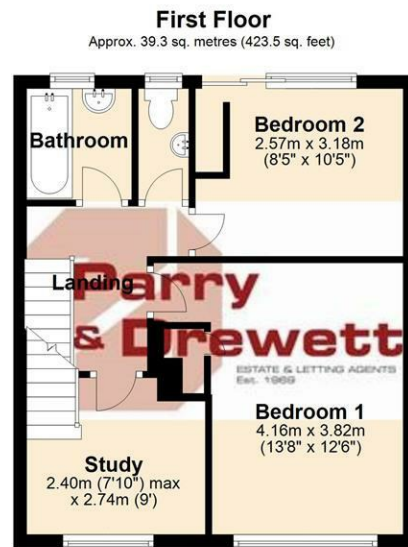
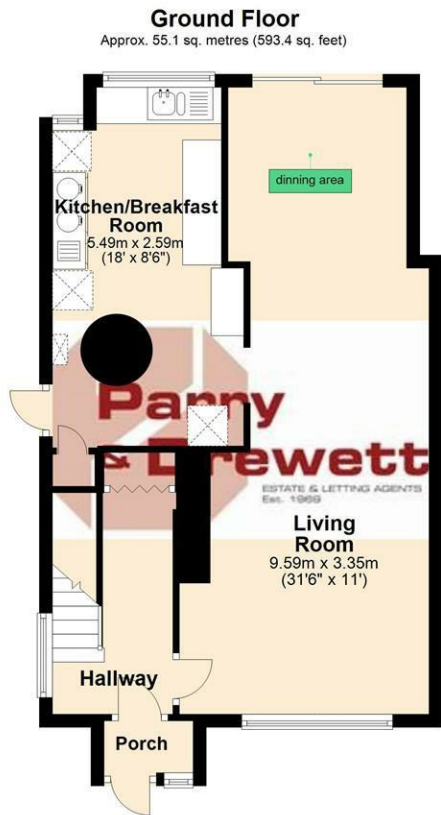

Total area: approx. 115.7 sq. metres (1245.2 sq. feet)

Whilst every effort is taken to ensure the accuracy of these details the floor plan should only be viewed as indicative and any sizes are not exact
Plan produced using PlanUp.

