

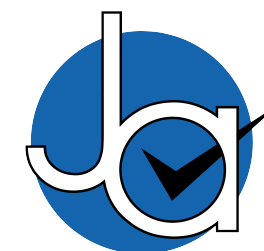

2 bedroom Mid Terraced House located in Tiptree.

Guide Price
£300,000 - £315,000

Find us on..



JOHN ALEXANDER
ESTATE AGENTS

Downton Walk Tiptree Colchester CO5 0DH



2



1



1



B



EPC

C



FULL DESCRIPTION

OVERVIEW

Guide Price £300,000 to £315,000

John Alexander are delighted to offer this beautifully presented two bedroom home. The property has been recently renovated by the currently owner and has been kept immaculate.

LOUNGE

15' 7" x 13' 9" (4.75m x 4.19m)

Window to front, under stairs cupboard, radiator, electric fire.

KITCHEN/DINER

14' x 10' (4.27m x 3.05m)

Matching eye and base units, double width oven, window to rear, sink with drainer, space for washing machine, larder style cupboard, radiator.

CONSERVATORY

11' 4" x 10' 4" (3.45m x 3.15m)

LANDING

Airing Cupboard, loft access.

BEDROOM ONE

12' 5" x 10' 8" (3.78m x 3.25m)

Window to front, built in wardrobe, radiator.

BEDROOM TWO

13' 7" x 8' 8" (4.14m x 2.64m)

Window to rear, radiator.

FAMILY BATHROOM

Window to rear, low level w.c, wash hand basin, panel bath with shower over.

GARDEN

Mainly laid to lawn, flower and shrub borders, door to garage.



FLOORPLAN

GROUND FLOOR

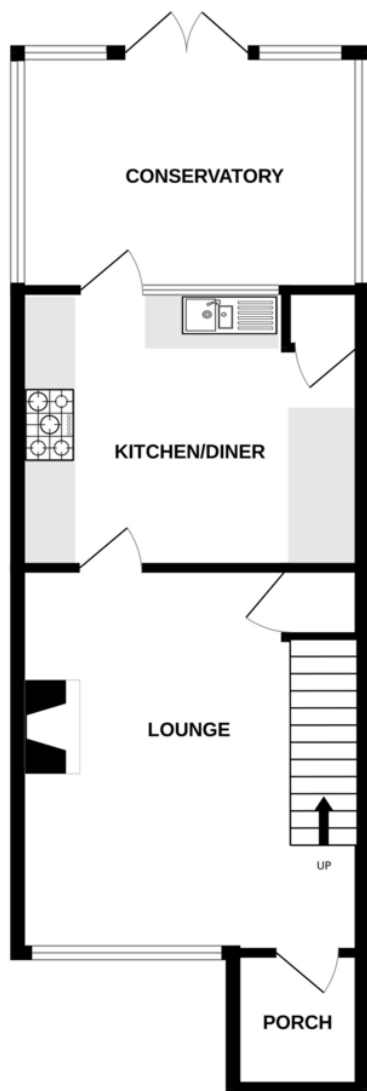

1ST FLOOR

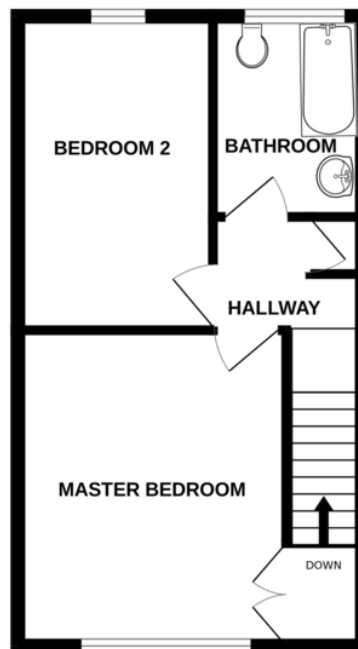

DIRECTIONS

CONTACT

**1 Church Road
Tiptree
Colchester
Essex
CO5 0LG**

E info@john-alexander.co.uk

T 01621 814334

www.john-alexander.co.uk

Find us on..

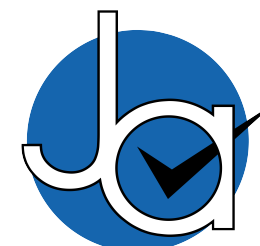

JOHN ALEXANDER
ESTATE AGENTS

Whilst every attempt has been made to ensure the accuracy of the floorplan contained here, measurements of doors, windows, rooms and any other items are approximate and no responsibility is taken for any error.