



4 Grove Road
Tiptree
Colchester
CO5 0JP



2



1



0



EPC

D



FULL DESCRIPTION

OVERVIEW

John Alexander are delighted to offer this spacious Two bedroom maisonette, located close to the high street. The property benefits from recently redecorated and has been fitted with new carpets. Available now for viewings!!

LOUNGE/DINER

18' 10" x 11' 2" (5.74m x 3.4m)

KITCHEN

9' 7" x 6' 5" (2.92m x 1.96m)

BEDROOM ONE

14' 1" x 8' 9" (4.29m x 2.67m)

BEDROOM TWO

10' 9" x 8' 9" (3.28m x 2.67m)

BATHROOM

EXTERNAL AREA

Please note there is a set of stairs to the flat from the side of the building.

There is an area by the front door with small store cupboard and parking is available to the front of the property.



FLOORPLAN

GROUND FLOOR

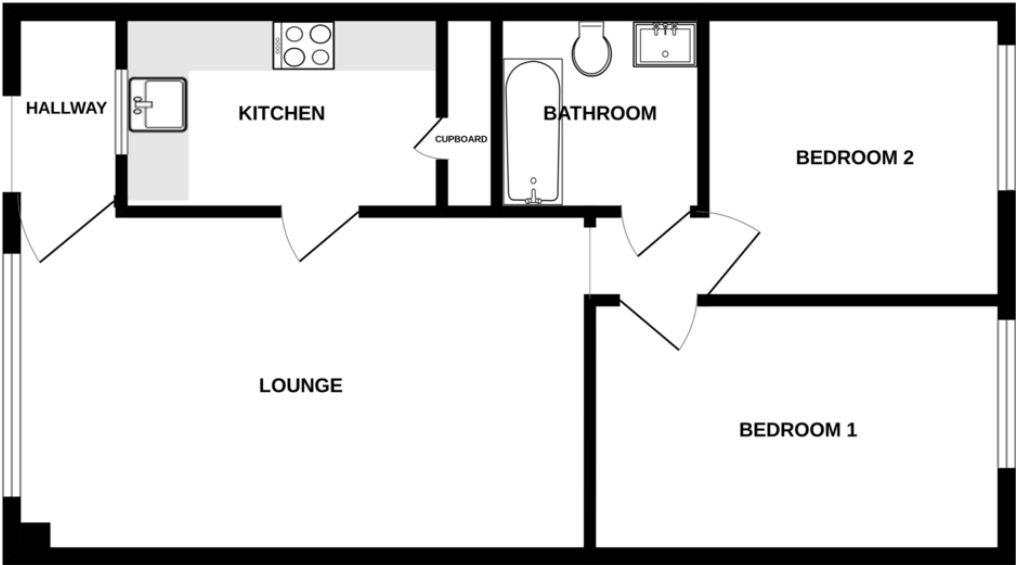

Whilst every attempt has been made to ensure the accuracy of the floorplan contained here, measurements of doors, windows, rooms and any other items are approximate and no responsibility is taken for any error, omission or mis-statement. This plan is for illustrative purposes only and should be used as such by any prospective purchaser. The services, systems and appliances shown have not been tested and no guarantee as to their operability or efficiency can be given.
Made with Metroplan ©2025