



4 Bedroom Detached House located in Little Totham.

Find us on..



JOHN ALEXANDER
ESTATE AGENTS

Field View Drive Little Totham Maldon CM9 8ND



4



2



2



E



D

FULL DESCRIPTION

OVERVIEW

We are delighted to offer for sale this beautifully presented three-bedroom detached family home, located in the charming village of Little Totham. Ideally positioned close to local amenities and just a short drive from Witham Town Centre, the property enjoys a peaceful yet convenient setting.

Upon entering, you're greeted by a welcoming hallway that leads to a spacious bay-fronted lounge/diner, a modern kitchen, a versatile family room with French doors opening onto the rear garden, and a handy ground-floor cloakroom.

Upstairs, the first floor hosts three well-proportioned bedrooms and a stylish family bathroom.

Outside, the home benefits from a private, well-kept rear garden-perfect for entertaining or relaxing-as well as a garage and driveway providing off-road parking.

ENTRANCE HALL

Stairs to the first floor, radiator, under stairs cupboard, double glazed windows to front.

CLOAKROOM

Low level WC, heated towel rail, obscure double glazed windows to side.

LOUNGE

23' 5" x 12' 6" (7.14m x 3.81m)

Double glazed windows to front, French doors to rear, 2x radiators, open fire.

KITCHEN

14' 0" x 10' 4" (4.27m x 3.15m)

One and a half stainless steel single drainer sink unit, with cupboards under matching base and eye level cupboards and roll top work surfaces, space for washing machine and dishwasher, integrated double oven, hob and extractor fan, integrated fridge and freezer, radiator, wall mounted gas boiler, double glazed windows and doors to front and rear.

DINING ROOM

12' 9" x 9' 9" (3.89m x 2.97m)

Double glazed windows to front, French doors to side, radiator.

LANDING

Double glazed windows to front, access to loft.

Guide Price
**£475,000 to
£500,000**



MASTER BEDROOM

12' 7" x 11' 10" (3.84m x 3.61m)

Double glazed windows to rear, fitted wardrobes, radiator.

BEDROOM 3

10' 4" x 7' 9" (3.15m x 2.36m)

Double glazed windows to rear, radiator.

BEDROOM 2

12' 7" x 11' 0" (3.84m x 3.35m)

Double glazed windows to front, radiator.



BATHROOM

Four piece suit, panelled bathtub and separate shower unit, wash basin, low level WC, spotlights, chrome heated towel rail, obscure double glazed windows to side.

OUTSIDE

Side access to rear garden, laid to lawn, flowers and shrubs, decking area. under cover seating and bar area, oil tank, summer house.

GARAGE

Part converted, storage area to front.

STUDIO

10' 6" x 8' 0" (3.2m x 2.44m)





Field View Drive, Little Totham CM9 8ND



FLOORPLAN

GROUND FLOOR

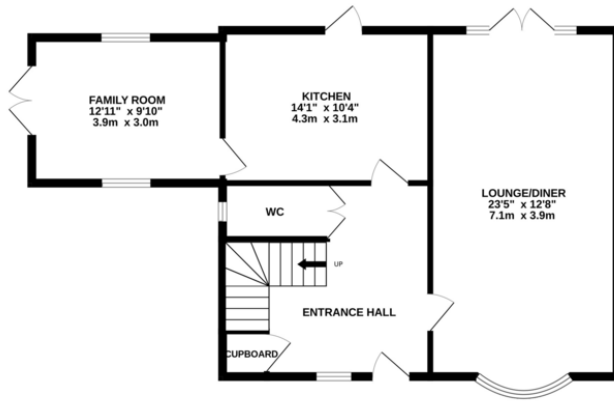

1ST FLOOR

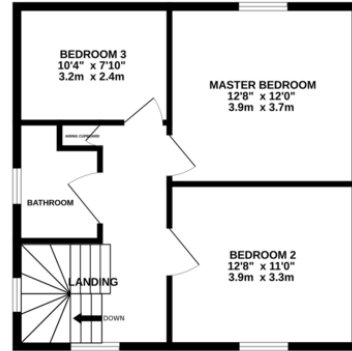

Whilst every attempt has been made to ensure the accuracy of the floorplan contained here, measurements of doors, windows, rooms and any other items are approximate and no responsibility is taken for any error, omission or mis-statement. This plan is for illustrative purposes only and should be used as such by any prospective purchaser. The services, systems and appliances shown have not been tested and no guarantee as to their operability or efficiency can be given.
Made with Metropix ©2025

CONTACT
1 Church Road
Tiptree
Colchester
Essex
CO5 0LG
E info@john-alexander.co.uk

T 01621 814334 www.john-alexander.co.uk

Find us on..



JOHN ALEXANDER
ESTATE AGENTS