



**4 bedroom
Semi-Detached
House located
in Jaspers
Green.**

£550,000

Find us on..



JOHN ALEXANDER
ESTATE AGENTS

Jaspers Green Shalford Essex CM7 5AX



4



3



1



E



B



1399
sq ft

FULL DESCRIPTION

OVERVIEW

We are delighted to offer this unique semi detached family home in the rarely available Jaspers Green. Built in 2020 the home is in great condition but has been thoughtfully designed with plenty of character too. Call now to book a viewing

STEP INSIDE

The entrance hallway has been stylishly designed with striking yellow panelling, incorporating a cloakroom and door leading to the kitchen. The whole ground floor benefits from underfloor heating, fired by the Air Source heat pump outside. The high spec kitchen diner has a variety of fitted wall and base units, a Bosch Induction hob, undercounter electric oven, mid-height second electric oven/ microwave combi, dishwasher, washing machine and tumble dryer. There is also space for a freestanding American style fridge freezer and dining table. Double doors lead to the rear garden. The spacious living room is dual aspect.

On the first floor there are three double bedrooms and a family bathroom, with the master bedroom also benefitting from an en-suite shower room. the second floor boasts a further double bedroom and bathroom plus eaves storage

STEP OUTSIDE

There is a driveway to the front to accommodate four cars with a gate leading to the rear garden. There is a patio area with covered pergola and outdoor kitchen, raised planters, a grassed area plus a summerhouse and shed. The summerhouse is fully powered and presently set as an office

KITCHEN DINER

18' 8" x 18' 8" (5.69m x 5.69m)

LOUNGE

18' 8" x 9' 7" (5.69m x 2.92m)

FIRST FLOOR

BEDROOM ONE

13' 10" x 11' 11" (4.22m x 3.63m)

ENSUITE

8' 3" x 4' 3" (2.51m x 1.3m)

BEDROOM THREE

10' 11" x 9' 8" (3.33m x 2.95m)

BEDROOM FOUR

9' 6" x 8' 9" (2.9m x 2.67m)

BATHROOM

8' 9" x 5' 8" (2.67m x 1.73m)

SECOND FLOOR

BEDROOM TWO

13' 5" x 12' 9" (4.09m x 3.89m)

SHOWER ROOM

7' 8" x 4' 7" (2.34m x 1.4m)

SUMMER HOUSE

12' 0" x 8' 10" (3.66m x 2.69m)



FLOORPLAN

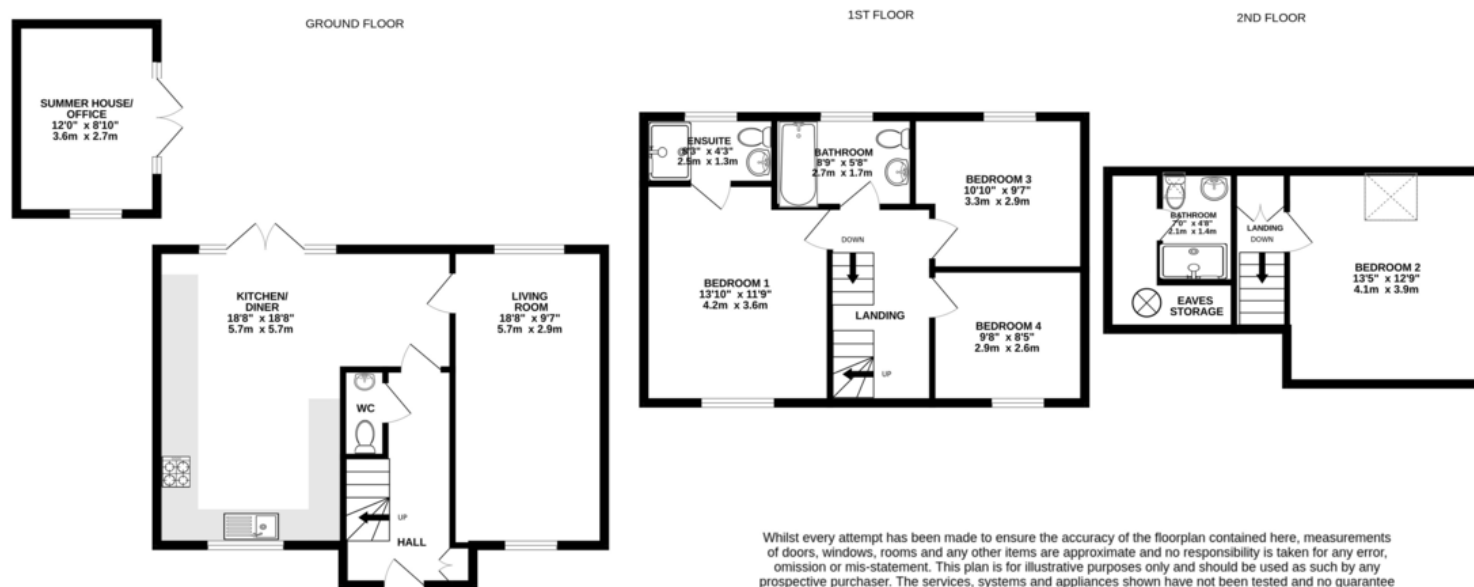

Whilst every attempt has been made to ensure the accuracy of the floorplan contained here, measurements of doors, windows, rooms and any other items are approximate and no responsibility is taken for any error, omission or mis-statement. This plan is for illustrative purposes only and should be used as such by any prospective purchaser. The services, systems and appliances shown have not been tested and no guarantee as to their operability or efficiency can be given.

Made with Metropix ©2025

CONTACT

1 Church Road
Tiptree
Colchester
Essex
CO5 0LG

E info@john-alexander.co.uk

T 01621 814334

www.john-alexander.co.uk

Find us on..



JOHN ALEXANDER