



2 Bedroom Semi-Detached House located in Tiptree.

Find us on..



JOHN ALEXANDER
ESTATE AGENTS

Maldon Road
Tiptree
Colchester
CO5 0LL



2



1



2

Guide Price
£300,000 to
£325,000

FULL DESCRIPTION

OVERVIEW

We are delighted to offer this extended TWO double bedroom semi-detached house. Requiring some light modernisation, this spacious home offers bundles of opportunities to put your own stamp on it with plenty of scope to extend. The property is located close to the village centre, with off street parking and is currently offered with NO ONWARD CHAIN.

LOUNGE

14' 7" x 11' 6" (4.44m x 3.51m)

Window to front, radiator.

KITCHEN/BREAKFAST ROOM

14' 10" x 10' 11" (4.52m x 3.33m)

Window to rear, base and eye level cupboards, stainless steel sink unit, space for appliance's, pantry style cupboard housing gas boiler.

DINING ROOM

9' 4" x 7' 5" (2.84m x 2.26m)

Window to side, double glazed door to garden.

BEDROOM ONE

11' 6" x 11' 6" (3.51m x 3.51m)

Window to front, radiator, built in wardrobe.

BEDROOM TWO

Window to rear, radiator.

WET ROOM

Double glazed frosted window to rear, wall mounted radiator, low level WC, shower, hand basin, tiled walls.

GARDEN STORE

Two sperate garden stores.

OUTSIDE

The front of the property is block paved, offering off road parking. Side access which is gated and secure for access to the rear garden.

The rear garden is mainly laid to lawn with a patio area., with fenced surround.



FLOORPLAN

GROUND FLOOR
434 sq.ft. (40.4 sq.m.) approx.

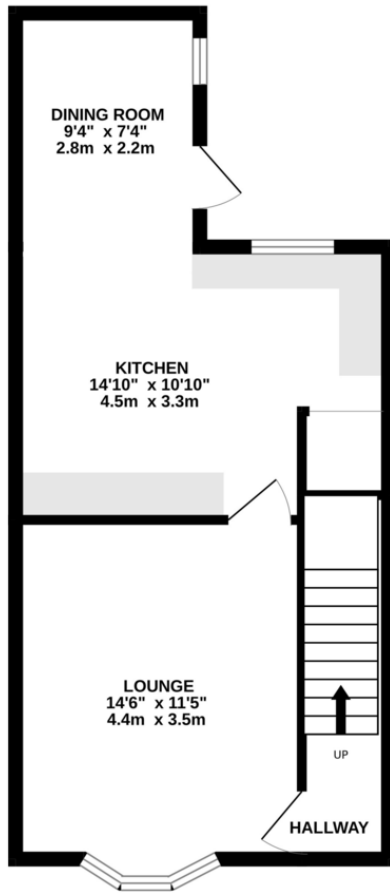

1ST FLOOR
358 sq.ft. (33.2 sq.m.) approx.

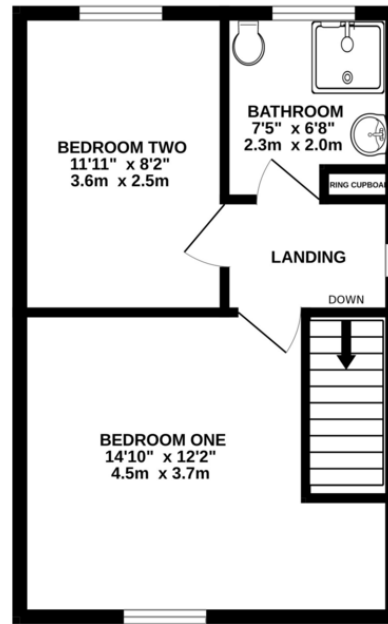

TOTAL FLOOR AREA : 792 sq.ft. (73.6 sq.m.) approx.

Whilst every attempt has been made to ensure the accuracy of the floorplan contained here, measurements of doors, windows, rooms and any other items are approximate and no responsibility is taken for any error, omission or mis-statement. This plan is for illustrative purposes only and should be used as such by any prospective purchaser. The services, systems and appliances shown have not been tested and no guarantee as to their operability or efficiency can be given.
Made with Metropix ©2024

DIRECTIONS

CONTACT
1 Church Road
Tiptree
Colchester
Essex
CO5 0LG

E info@john-alexander.co.uk

T 01621 814334 www.john-alexander.co.uk

Find us on..

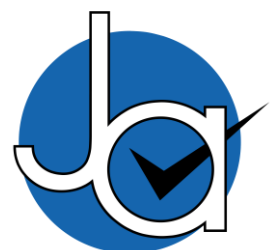

JOHN ALEXANDER
ESTATE AGENTS