



JOHN ALEXANDER  
ESTATE AGENTS



JOHN ALEXANDER



JOHN ALEXANDER

## 2 Bedroom Semi-Detached House located in Silver End.

Find us on..



JOHN ALEXANDER  
ESTATE AGENTS

# Broadway, Silver End, CM8 3XN



2



1



1



B



C



614  
sq ft

## £280,000

## FULL DESCRIPTION

### OVERVIEW

We are pleased to offer this two bedroom semi-detached house, situated towards the end of a quiet cul-de-sac in Silver End. Benefitting from a South East facing garden, conservatory, car-port and driveway plus two good sized bedrooms. Viewing recommended

### ENTRANCE HALL

**10' 11" x 5' 9" (3.33m x 1.75m)**

Stairs to first floor and storage cupboard

### KITCHEN

**10' 11" x 5' 10" (3.33m x 1.78m)**

Dual aspect windows to front and side. Fitted wall and base units and space for appliances

### LOUNGE

**11' 10" x 13' 9" (3.61m x 4.19m)**

Double doors to conservatory, fireplace with electric fire

### CONSERVATORY

**11' 3" x 10' 6" (3.43m x 3.2m)**

Double doors to South East facing garden

### FIRST FLOOR

#### BEDROOM ONE

**10' 2" x 8' 11" (3.1m x 2.72m)**

Window to rear aspect and built in wardrobes

#### BEDROOM TWO

**8' 6" x 9' 2" (2.59m x 2.79m)**

Window to rear aspect, built in wardrobe and cupboard

#### BATHROOM

**6' 1" x 5' 6" (1.85m x 1.68m)**

Window to side aspect, bath with shower over, wash basin and WC

#### OUTSIDE

Carport and driveway to front. South East facing rear garden mainly laid to lawn with patio

#### LOCATION

The property sits at the end of a quiet cul-de-sac in the popular village of Silver End. Broadway has four "Good" rated primary schools within 2 miles, an "outstanding" rated secondary school just under 2.5 miles away. There is a group of local shops within walking distance. Silver End offers all the daily amenities you'll need, but also sits within a short distance from Kelvedon (4.3 miles), Witham (4.6 miles) and Braintree (5.1 miles), making it a great central Essex location with of services nearby.







**167 Broadway, Silver End CM8 3XN**



# FLOORPLAN

GROUND FLOOR

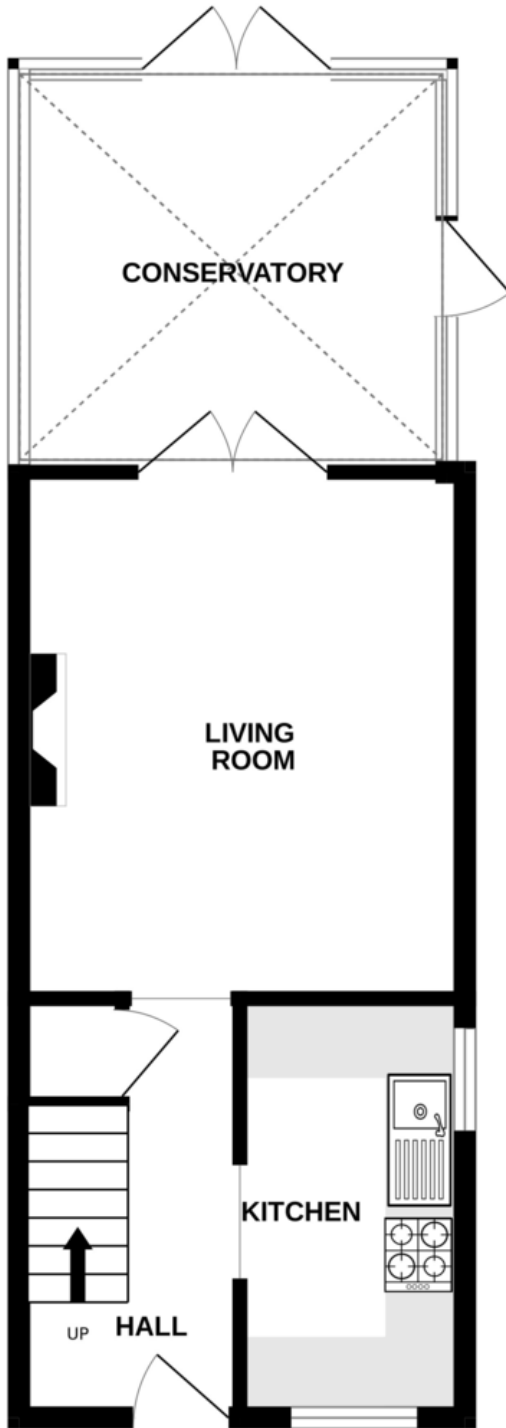

1ST FLOOR

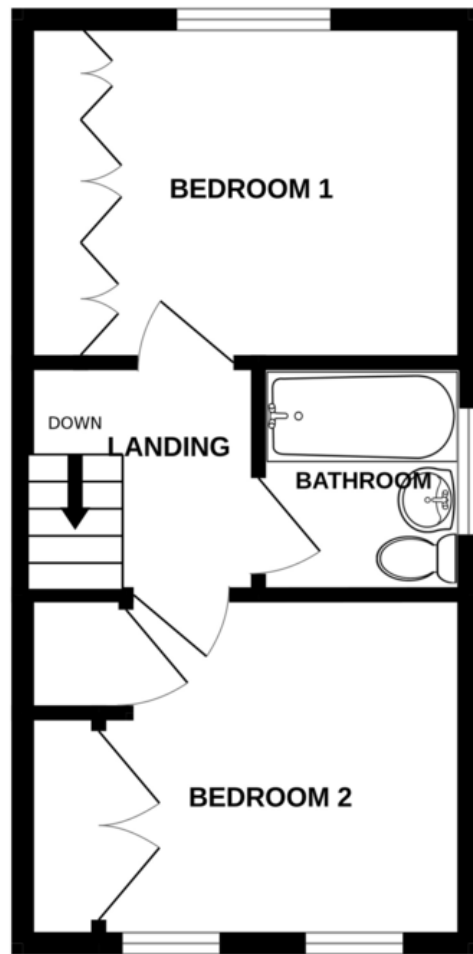

Whilst every attempt has been made to ensure the accuracy of the floorplan contained here, measurements of doors, windows, rooms and any other items are approximate and no responsibility is taken for any error, omission or mis-statement. This plan is for illustrative purposes only and should be used as such by any prospective purchaser. The services, systems and appliances shown have not been tested and no guarantee as to their operability or efficiency can be given.  
Made with Metropix ©2024

CONTACT  
1 Church Road  
Tiptree  
Essex  
CO5 0LG

E [info@john-alexander.co.uk](mailto:info@john-alexander.co.uk)  
T 01621 814334 [www.john-alexander.co.uk](http://www.john-alexander.co.uk)

Find us on..



**JOHN ALEXANDER**  
ESTATE AGENTS