

2 Bedroom Apartment located in Witham.

Find us on..

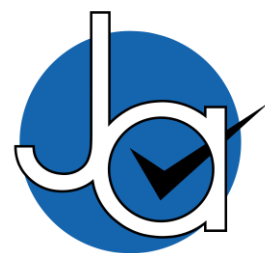

JOHN ALEXANDER
ESTATE AGENTS

Crittall Road
Witham
CM8 3FA

FLOORPLAN

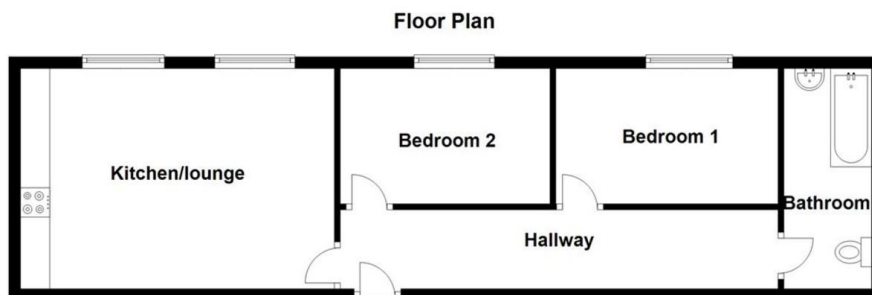

The floor plan is for guidance purposes only and has been produced merely to illustrate the relative position of rooms within a building. It is not to scale.
Plan produced using PlanUp.

CONTACT
1 Church Road
Colchester
Tiptree
Essex
CO5 0LG

EMAIL
info@john-alexander.co.uk

TEL
01621 814334

www.john-alexander.co.uk

£170,000

SUMMARY

We're delighted to present this attractive two-bedroom apartment conveniently located near Witham town centre. This property boasts generous living spaces with high ceilings and modern, stylish fixtures. It includes double glazing and electric heating for your comfort, as well as well-equipped kitchens with appliances. Additionally, there is one designated parking space for residents and ample visitor parking.