



24 Oxcroft View, Stanfree

Chesterfield

£495,000





## 24 Oxcroft View

Stanfree, Chesterfield

Exceptional 6-bed detached house in semi-rural Stanfree, featuring, 6 double bedrooms, 4 baths, study, garden room, double garage, ample storage, EV charge point, and elegant decor throughout. Gardens to front and rear. Ideal family retreat near urban amenities.

Council Tax band: E

Tenure: Freehold

- SEMI RURAL LOCATION
- SIX DOUBLE BEDROOMS
- FOUR BATHROOMS
- STUDY WITH FITTED FURNITURE
- GLASS & OAK STAIRCASE
- PLEASANT GARDEN ROOM
- DOUBLE GARAGE WITH BOARDED LOFT SPACE
- GENEROUS DRIVEWAY WITH EV CHARGE POINT









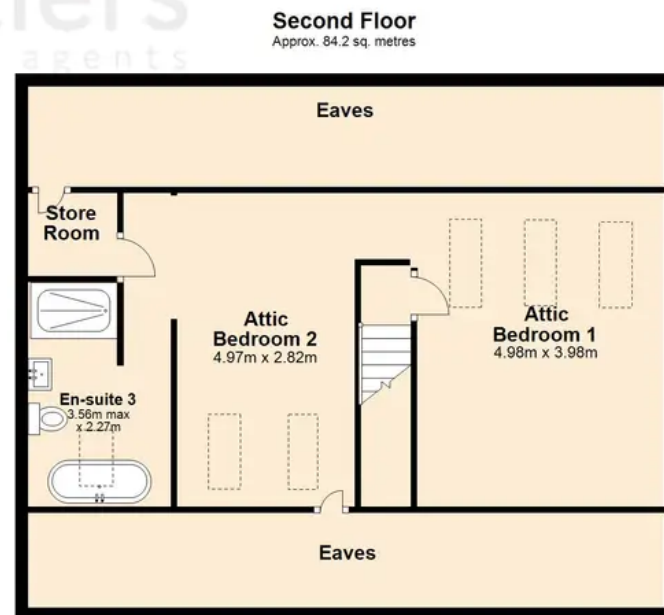

Total area: approx. 262.2 sq. metres

Whilst every attempt has been made to ensure the accuracy of this floorplan, all measurements and items on the plan should not be relied upon and no responsibility will be taken for any errors or omissions. The floorplan is owned by Butlers Estate Agents Ltd and should not be copied or reproduced without relevant authority. Plan produced using PlanUp.

24 Oxcroft View, Stanfree, Chesterfield



**butlers**  
estate agents

estate agents



**butlers**  
estate agents