

A modern living room with two light grey sofas, a wooden coffee table, and a large window with grey curtains. The room has a grey carpet and a white wall with a framed picture. A side table with a lamp and a tray is visible on the right. The room opens up to a garden through the large window.

## The Gosford 3 bedroom

**karbon**  
homes

For more information please contact us on:  
**[salesandmarketing@karbonhomes.co.uk](mailto:salesandmarketing@karbonhomes.co.uk) / 0191 223 8749**

With 3 bedrooms, the Gosford, built by Taylor Wimpey, is perfect for anyone looking for a little extra space. Downstairs, the open plan kitchen/dining area has double doors that open out onto the garden, with a separate living room at the front of the home as well as a handy downstairs W.C. and storage cupboard. Upstairs, there are two double bedrooms and a further single bedroom which would also make a perfect home office.

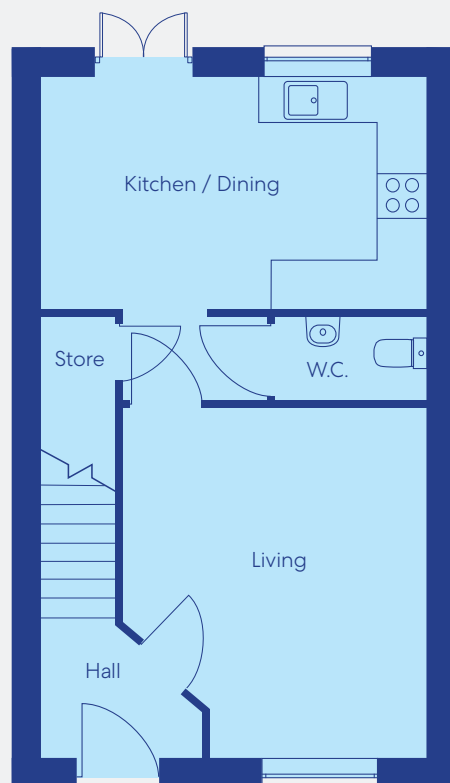

#### Ground Floor

##### Kitchen/Dining Area

4.72m x 2.89m

15' 6" x 9' 6"

##### Living Area

4.28m x 3.69m

14' 1" x 12' 1"

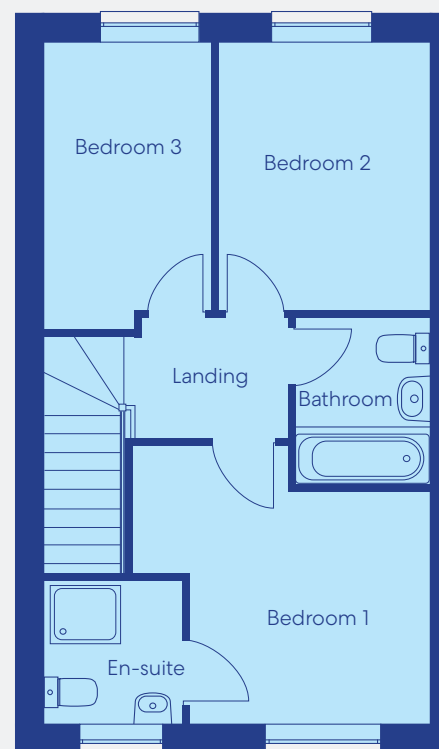

#### First Floor

##### Bedroom 1

2.96m x 2.84m

9' 9" x 9' 4"

##### Bedroom 2

3.32m x 2.63m

10' 11" x 8' 8"

##### Bedroom 3

3.56m x 2.01m

11' 8" x 6' 7"