

A wide-angle photograph of a bright, modern living and dining area. In the foreground, a glass-topped dining table is set with three place settings, each featuring a white plate, a patterned napkin, and a small bowl of fruit. A large, ornate silver candle holder sits on the table. In the background, a grey sofa and a light-colored armchair are positioned around a glass coffee table. The room has large windows with white frames and a white door leading to a garden. The walls are white, and the floor is covered in light-colored carpeting. A blue circular graphic in the top right corner contains the text 'The Portland 2 bedroom home'.

The Portland 2 bedroom home

karbon
homes

For more information please contact us on:
salesandmarketing@karbonhomes.co.uk / 0191 223 8749

The Portland is a two bedroom home perfect for couples and young families alike. It features a spacious kitchen to the front of the home with a large living room to the rear and a downstairs W.C.

To the first floor, there are two double bedrooms and a family bathroom. Externally, there is a rear garden and allocated parking.

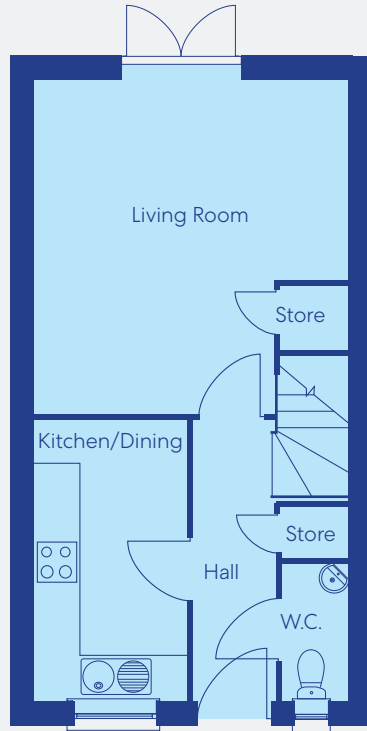

Ground Floor

Living Room
4.56m x 4.33m

Kitchen
3.66m x 2.11m

W.C.
1.88m x 0.9m

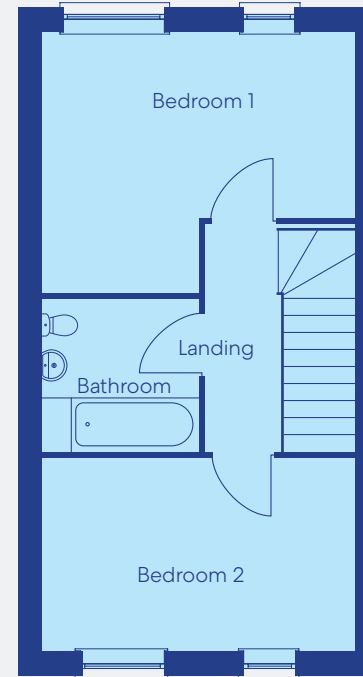

First Floor

Bedroom 1
4.33m x 3.6m

Bedroom 2
4.33m x 2.66m

Bathroom
2.16m x 2.1m