



167 Moorgate Road Moorgate Road

, Rotherham, S60 3AP

£1,300 Per Month

A Charming 2-Bedroom Detached Residence. Nestled at the former entrance to Sitwell House's driveway, ideally suited to a couple or single occupant. UNFURNISHED AND AVAILABLE 12TH AUGUST 2025.

- A superbly modernised 2 bedroom period Lodge House
- En suite shower rooms to both double bedrooms
- Highly desirable location
- Rear parking
- Superbly appointed dining kitchen with integrated appliances
- Ground floor WC & lower ground floor cellar
- Rear patio area
- UNFURNISHED AND AVAILABLE 12TH AUGUST 2025
- Internal viewing highly recommended
- Council Tax Band D

Viewing

Please contact our ELR Europa Link Office on 01142689900 if you wish to arrange a viewing appointment for this property or require further information.



2



2



1



Floor Plan

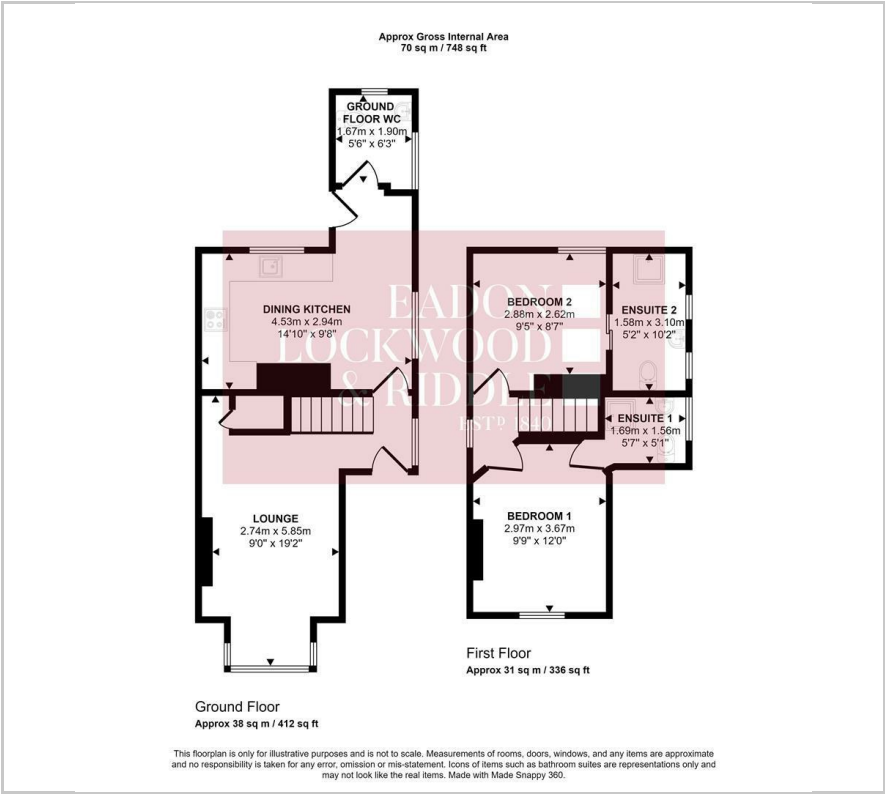

Area Map



Energy Efficiency Graph

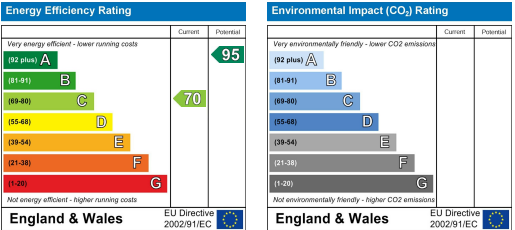

These particulars, whilst believed to be accurate are set out as a general outline only for guidance and do not constitute any part of an offer or contract. Intending purchasers should not rely on them as statements of representation of fact, but must satisfy themselves by inspection or otherwise as to their accuracy. No person in this firms employment has the authority to make or give any representation or warranty in respect of the property.