



30 King Edwards
Rivelin, Sheffield, S6 5SQ
£3,000 Per Month

A beautiful four bedroom residence situated in the tranquil setting of King Edwards which is a grade II listed building situated in the highly desirable Rivelin Valley. Part furnished. The property benefits from a washing machine and also a pressurised water system in the kitchen and also a boiling tap with instant hot water. The property benefits from being close to local hospitals and universities. AVAILABLE FROM SEPTEMBER 2024

- A beautiful four bedroom home
- Two Reception rooms
- Stunning modern kitchen with island
- Garden room with views over the Chelsea style courtyard
- Master bedroom with fitted wardrobes and en-suite
- Tranquil location in the beautiful Rivelin Valley
- Communal grounds with tennis court and gym
- COUNCIL TAX BAND: G
- FURNISHED
- Available SEPTEMBER 2024

Viewing

Please contact our ELR Europa Link Office on 01142689900 if you wish to arrange a viewing appointment for this property or require further information.



Floor Plan

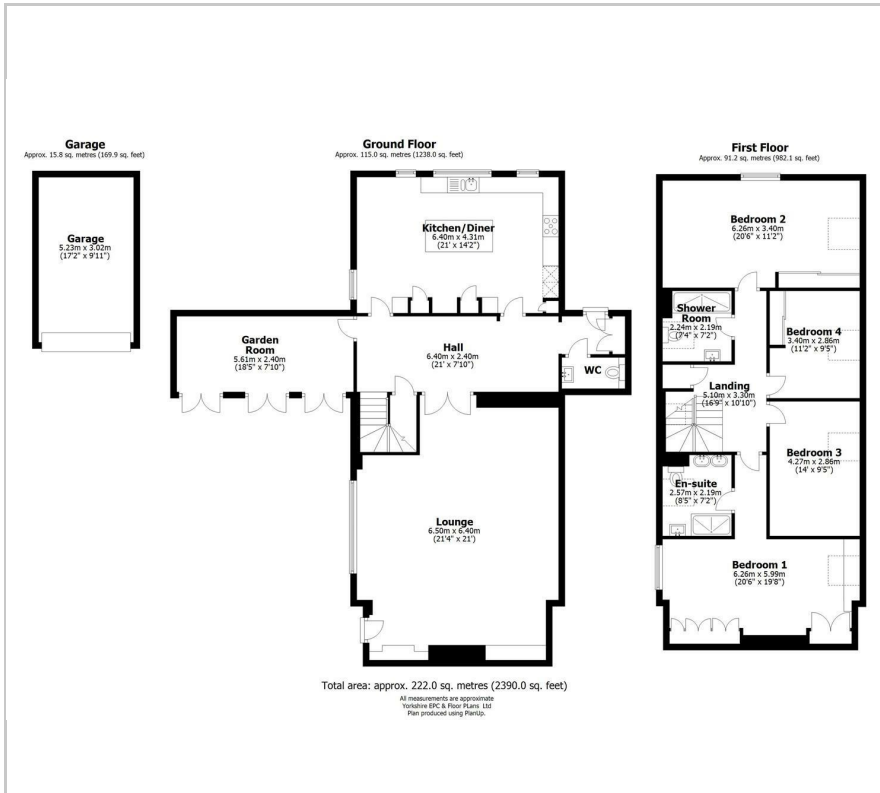

Area Map



Energy Efficiency Graph

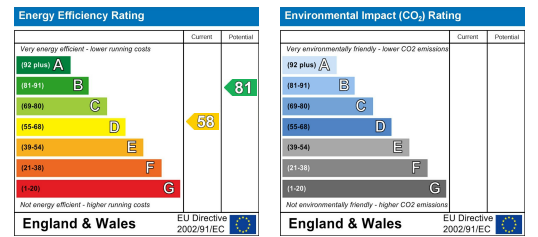

These particulars, whilst believed to be accurate are set out as a general outline only for guidance and do not constitute any part of an offer or contract. Intending purchasers should not rely on them as statements of representation of fact, but must satisfy themselves by inspection or otherwise as to their accuracy. No person in this firm's employment has the authority to make or give any representation or warranty in respect of the property.