



See More Online

KFB: Key Facts For Buyers

A Guide to This Property & the Local Area

Tuesday 23rd September 2025

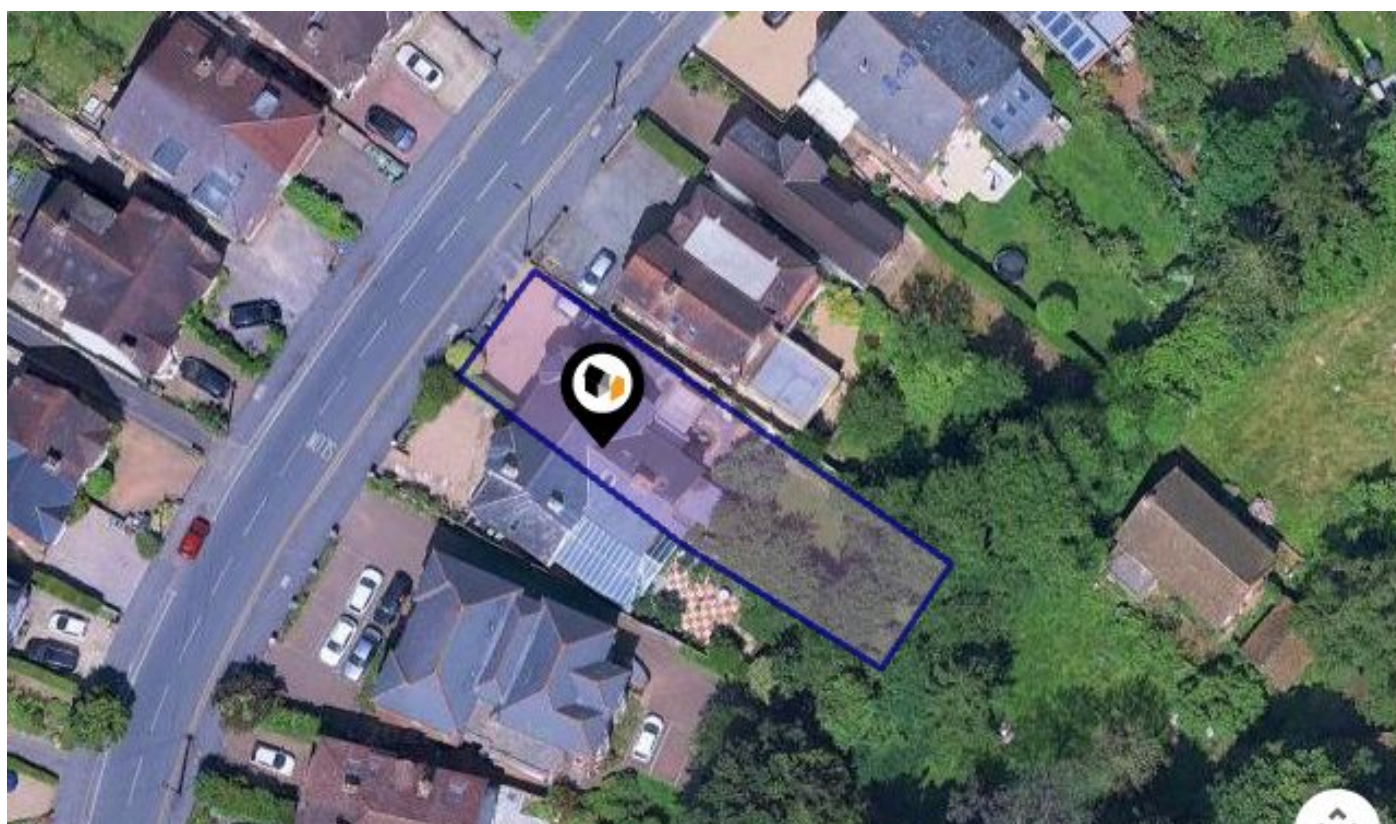

UPPER GROSVENOR ROAD, TUNBRIDGE WELLS, TN1

Martin & Co Tunbridge Wells

11 Vale Road Tunbridge Wells Kent TN1 1BS

01892 543856

david.rogers@martinco.com

www.martinco.com/estate-agents-and-letting-agents/branch/tunbridge-wells



Property

Type:	Property Shell
Bedrooms:	1
Floor Area:	688 ft ² / 64 m ²
Plot Area:	0.12 acres
Council Tax :	Band C
Annual Estimate:	£2,086
Title Number:	K796247

Tenure: Freehold

Local Area

Local Authority:	Kent
Conservation Area:	No
Flood Risk:	
• Rivers & Seas	Very low
• Surface Water	Very low

Estimated Broadband Speeds
(Standard - Superfast - Ultrafast)

15	51	10000
mb/s	mb/s	mb/s

Mobile Coverage:
(based on calls indoors)

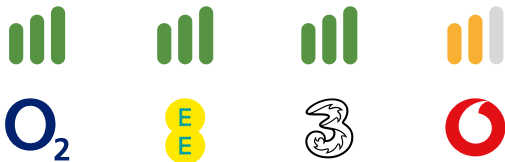

Satellite/Fibre TV Availability:



UPPER GROSVENOR ROAD, TUNBRIDGE WELLS, TN1

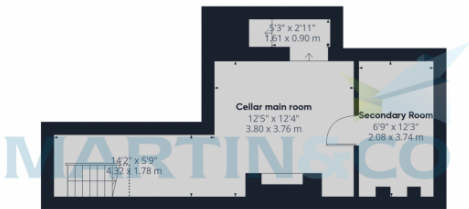

Approximate total area[®]
1558 ft²
144.7 m²

Reduced headroom
12 ft²
1.1 m²

Ground Floor

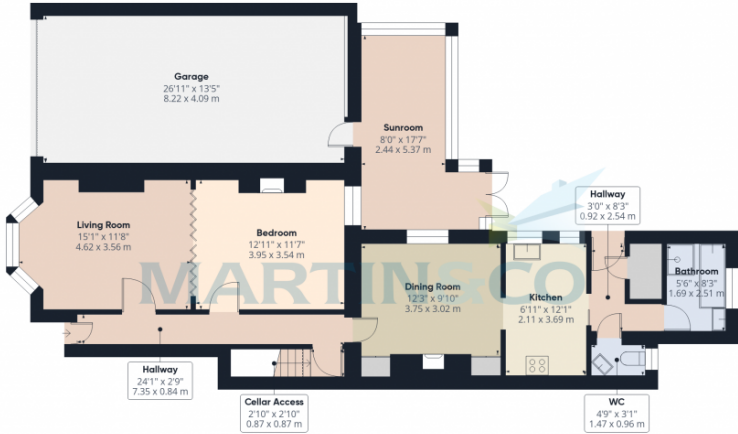

Floor 1

(1) Excluding balconies and terraces

Reduced headroom
Below 5 ft/1.5 m

Calculations reference the RICS IPMS 3C standard. Measurements are approximate and not to scale. This floor plan is intended for illustration only.

GIRAFFE360

UPPER GROSVENOR ROAD, TUNBRIDGE WELLS, TN1

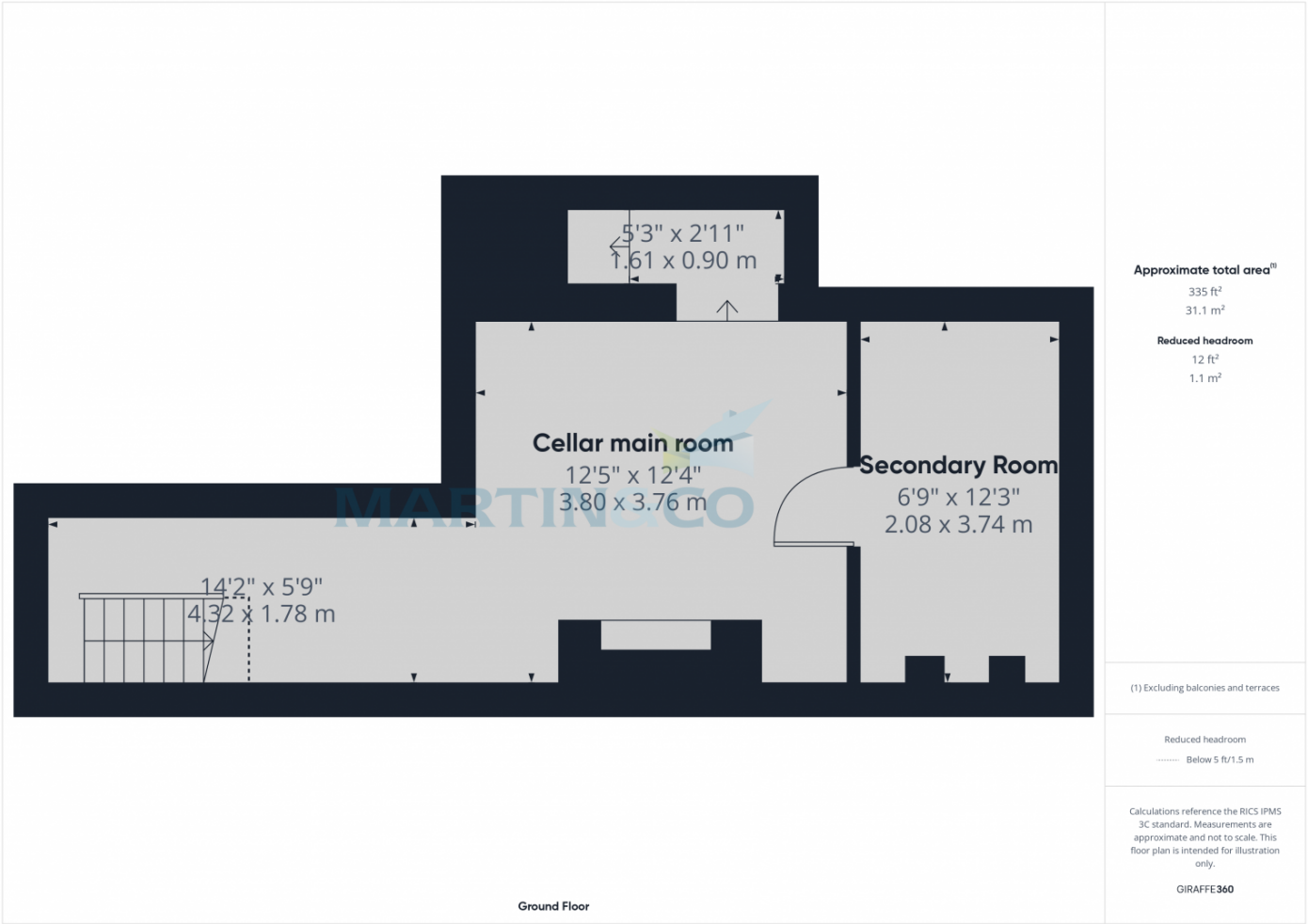

UPPER GROSVENOR ROAD, TUNBRIDGE WELLS, TN1



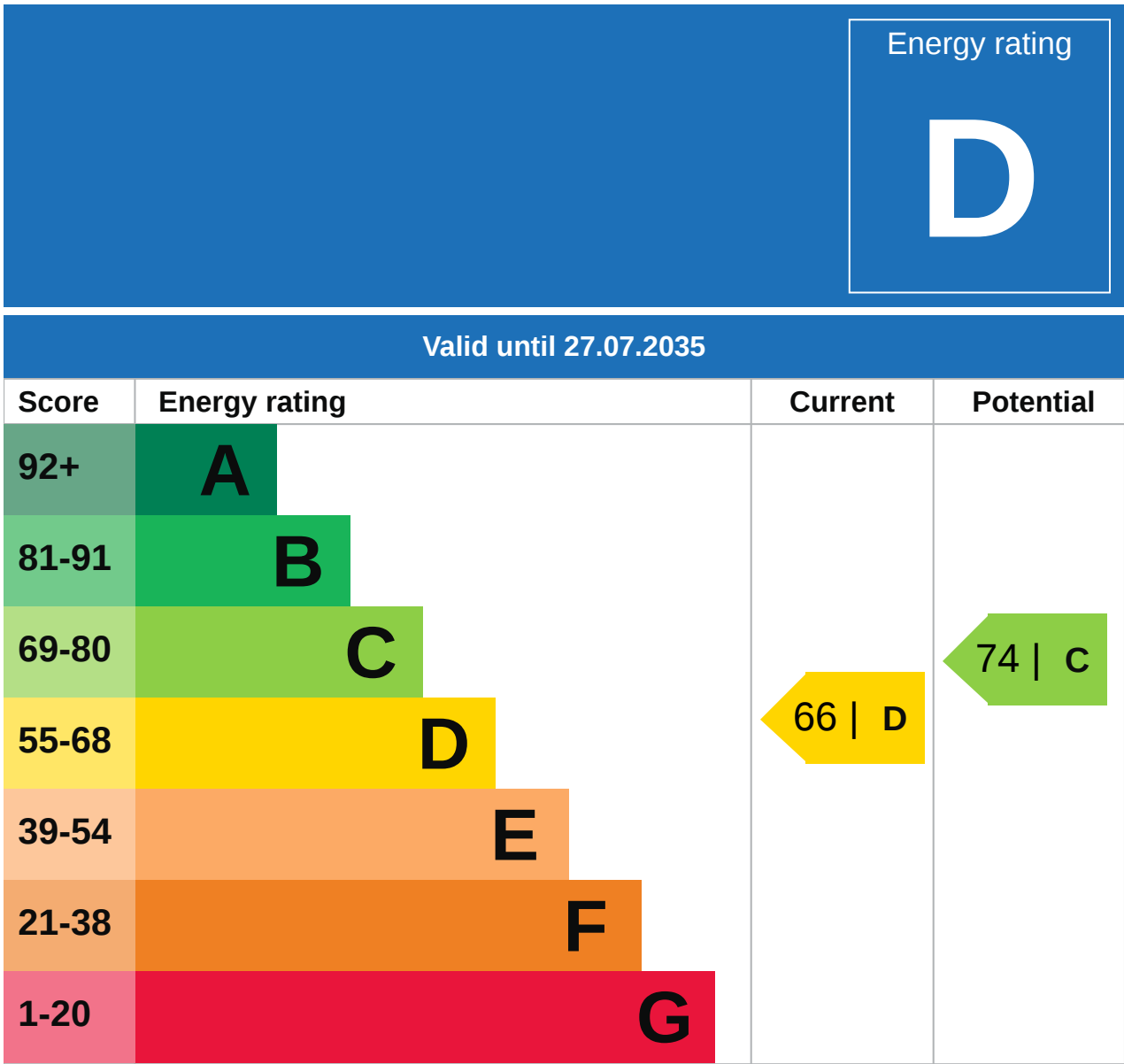

Additional EPC Data

Property Type:	Ground-floor flat
Flat Top Storey:	No
Top Storey:	0
Previous Extension:	0
Open Fireplace:	0
Walls:	Solid brick, as built, no insulation (assumed)
Walls Energy:	Solid brick, as built, no insulation (assumed)
Roof:	Flat, insulated
Roof Energy:	Flat, insulated
Main Heating:	Boiler and radiators, mains gas
Main Heating Controls:	Programmer, room thermostat and TRVs
Hot Water System:	From main system
Hot Water Energy Efficiency:	From main system
Lighting:	Good lighting efficiency
Floors:	Suspended, no insulation (assumed)
Total Floor Area:	64 m ²

10 Year History of Average House Prices by Property Type in TN1

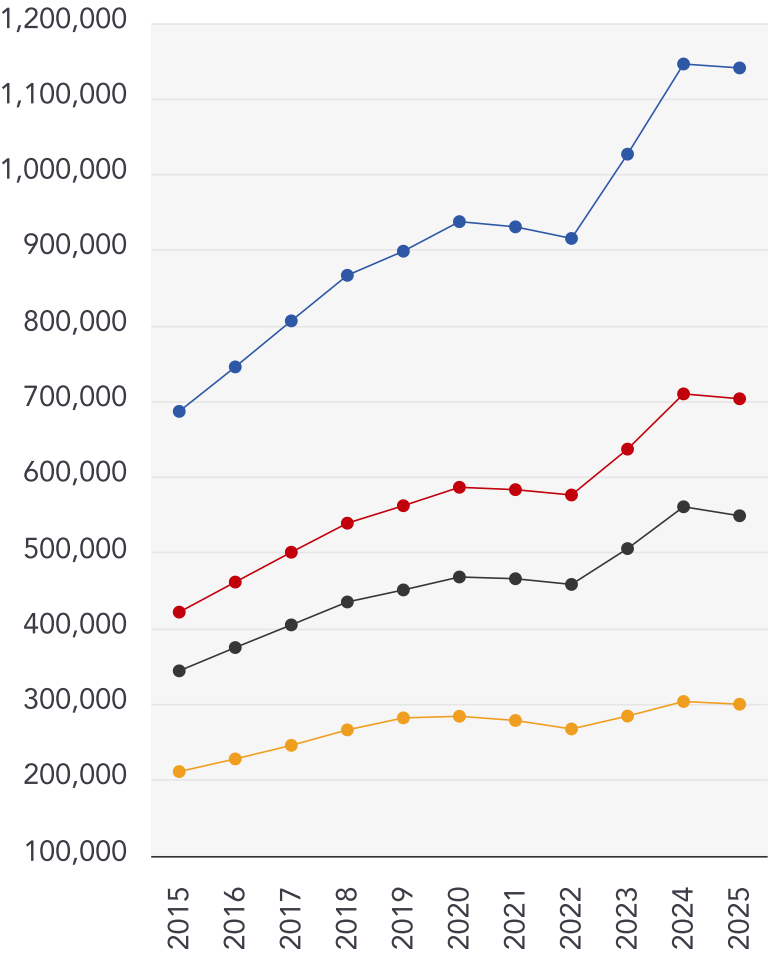

Detached

+66.01%

Semi-Detached

+66.77%

Terraced

+59.45%

Flat

+42.08%

This map displays nearby coal mine entrances and their classifications.

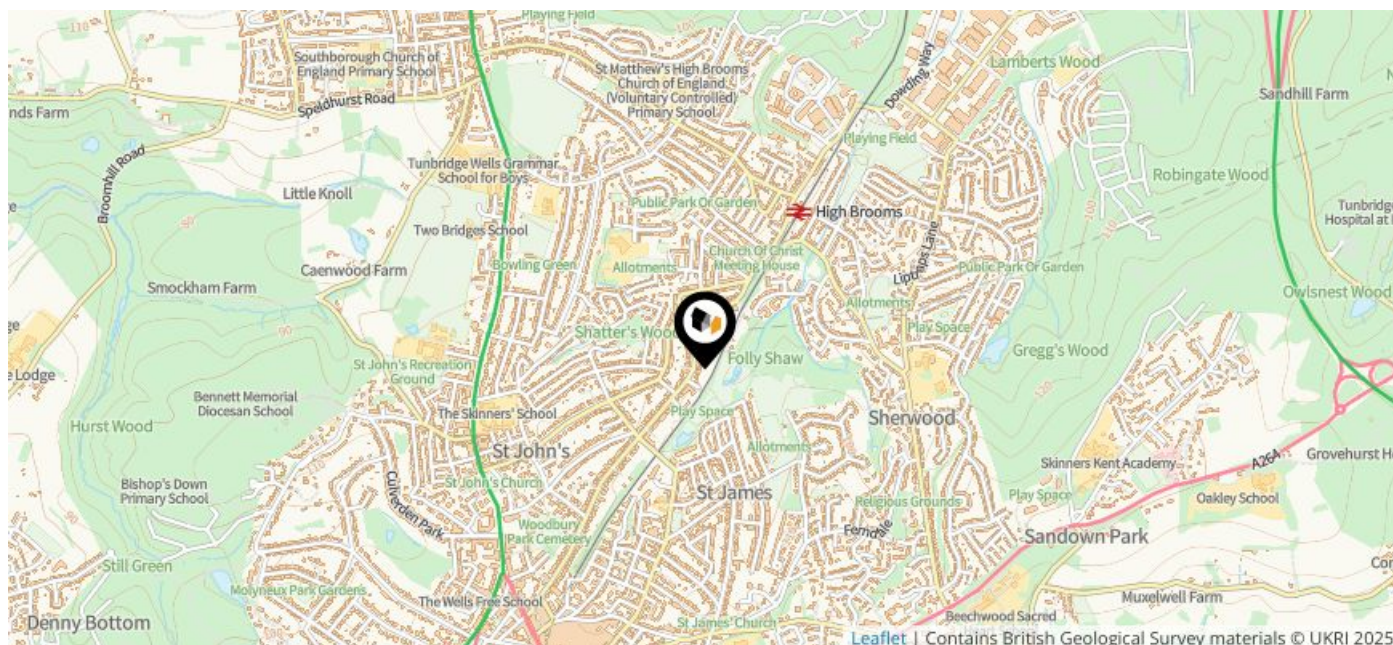

Mine Entry

- ✕ Adit
- ✕ Gutter Pit
- ✕ Shaft

The Coal Authority has records of over 175,000 mine entries within the UK captured in the National Coal Mining database, derived from sources including abandonment plans, geological and topographical plans.

Coal mining activity is recorded as far back as the 13th century, but prior to 1872 there was no requirement to deposit abandonment plans. It is therefore believed there may be many unrecorded mine entries of which the Authority has no information or knowledge. These entries do not, therefore, appear within the Authority's national dataset as shown on this map.

This map displays nearby official conservation areas. Every local authority in England has at least one conservation area. Most are designated by the Council as the local planning authority, though Historic England and the Secretary of State also have the power to create them.

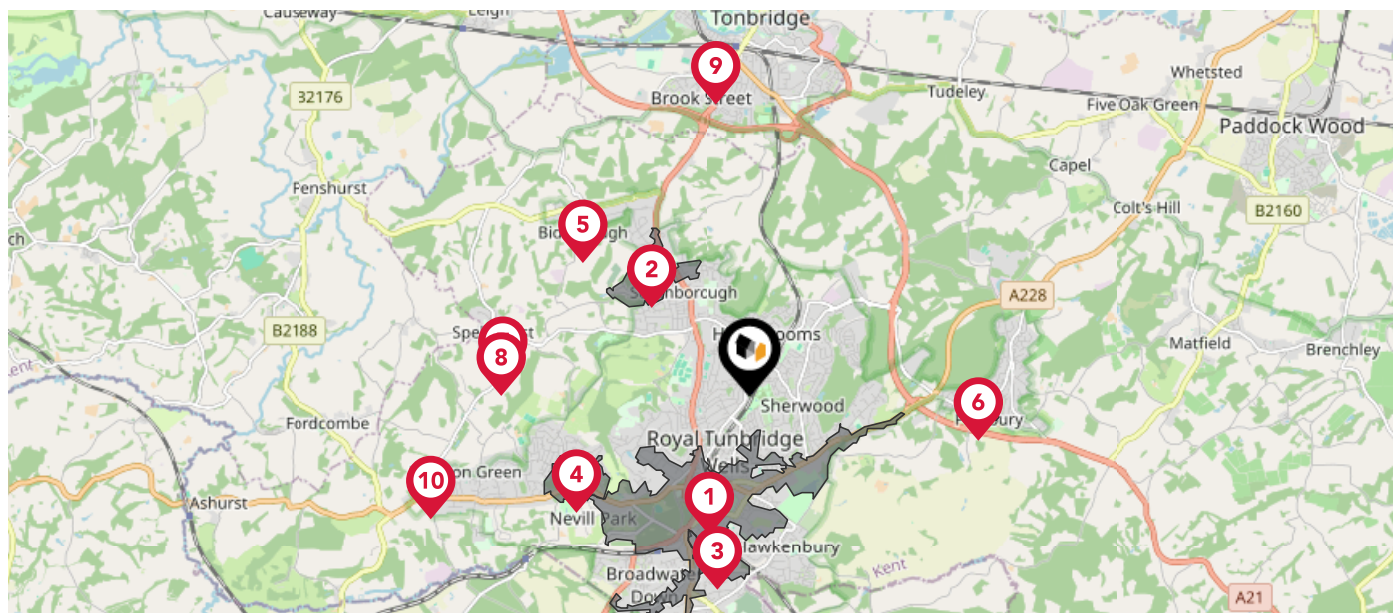

Nearby Conservation Areas

- 1 Tunbridge Wells Conservation Area
- 2 Southborough Conservation Area
- 3 Madeira Park & Warwick Park Conservation Area
- 4 Rusthall Conservation Area
- 5 Bidborough Conservation Area
- 6 Pembury Conservation Area
- 7 Speldhurst Conservation Area
- 8 Speldhurst Conservation Area
- 9 Quarry Hill, Tonbridge
- 10 Langton Green Conservation Area

The UK is divided into wards that are used for local elections to elect local government councillors. Sometimes these are known as 'electoral divisions'. Population counts can vary substantially between wards, but the national average is about 5,500

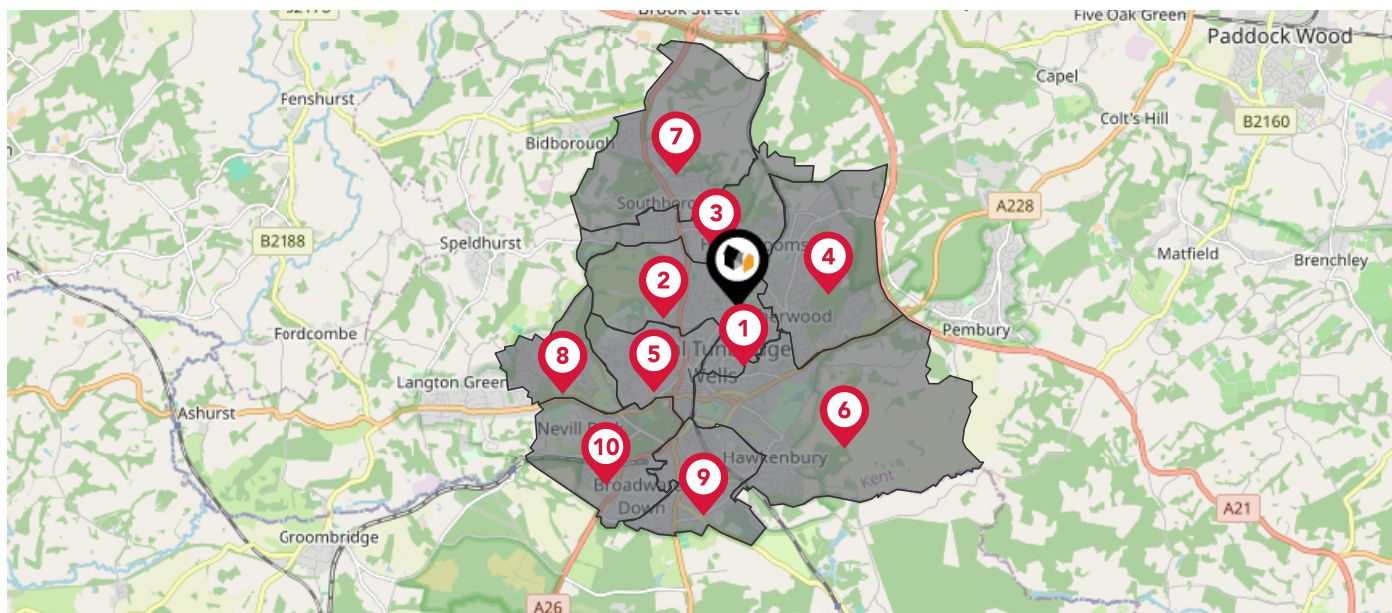

Nearby Council Wards

1

St. James' Ward

2

St. John's Ward

3

Southborough and High Brooms Ward

4

Sherwood Ward

5

Culverden Ward

6

Park Ward

7

Southborough North Ward

8

Rusthall Ward

9

Pantiles and St. Mark's Ward

10

Broadwater Ward

This map displays the noise levels from nearby network rail and HS1 railway routes that affect this property...

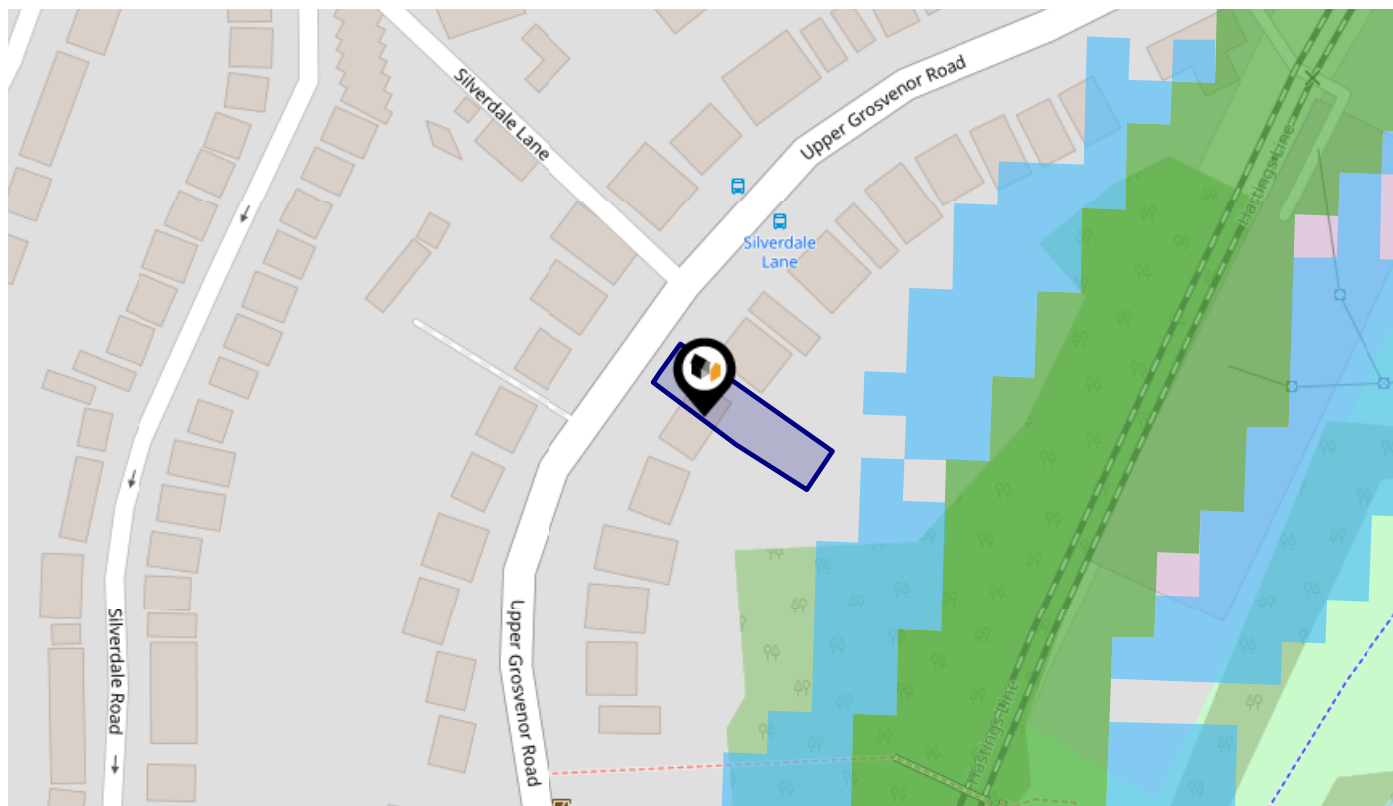

Rail Noise Data

This data indicates the level of noise according to the strategic noise mapping of rail sources within areas with a population of at least 100,000 people (agglomerations) and along Network Rail and HS1 traffic routes.

The data indicates the annual average noise levels for the 16-hour period between 0700 - 2300.

Noise levels are modelled on a 10m grid at a receptor height of 4m above ground, polygons are then produced by merging neighbouring cells within the following noise classes:

5		75.0+ dB	■
4		70.0-74.9 dB	■
3		65.0-69.9 dB	■
2		60.0-64.9 dB	■
1		55.0-59.9 dB	■

Flood Risk

Rivers & Seas - Flood Risk

This map shows the chance of flooding from rivers and / or the sea, taking into account flood defences and their condition.

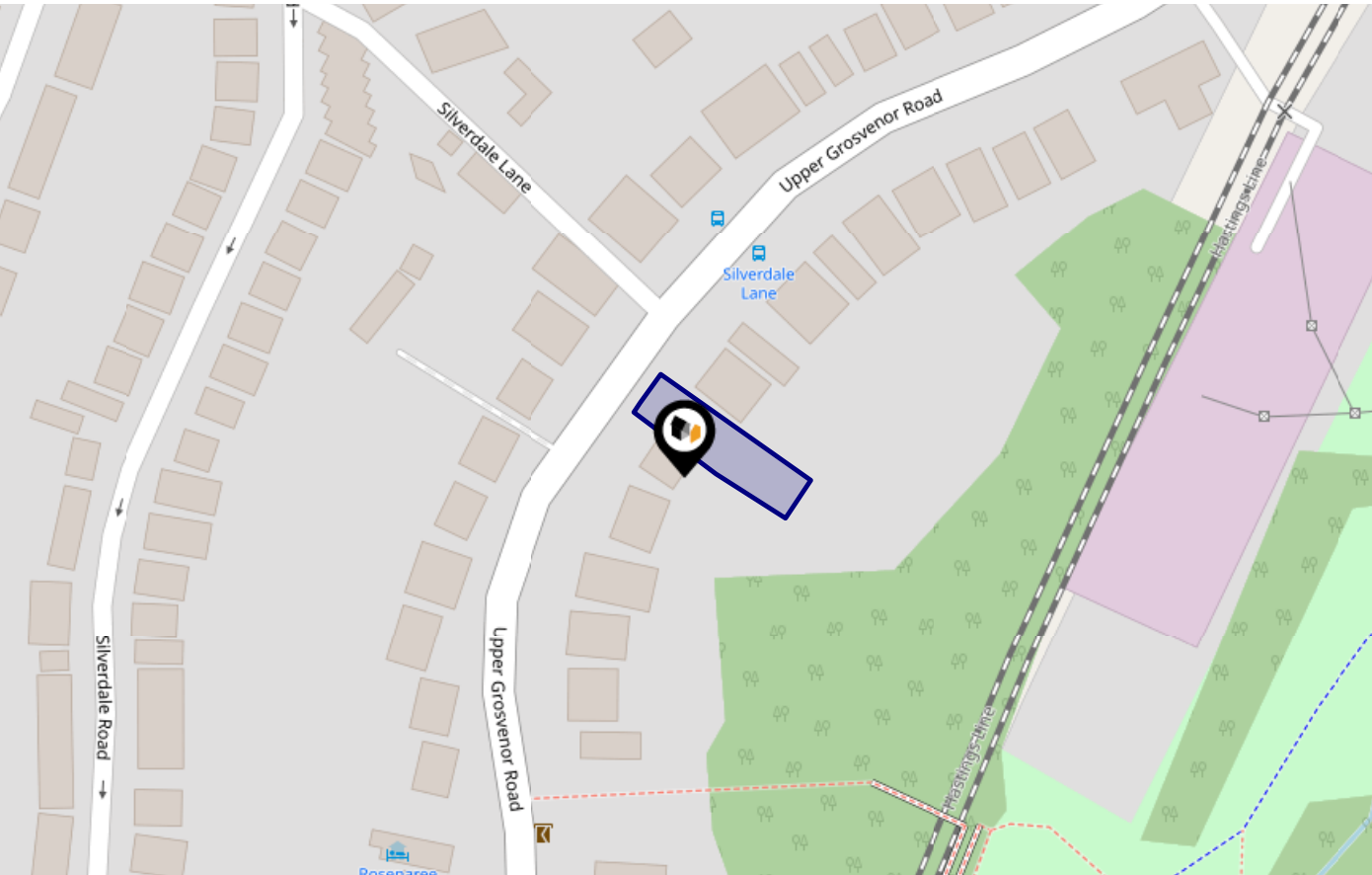

Risk Rating: Very low

The map does not contain sufficient information for it to be used to determine flood risk to individual properties, but it does give you an indication of whether your area may be affected by surface water flooding at this risk level.

- High Risk** - an area which has a chance of flooding of greater than 1 in 30 (3.3%) in any one year.
- Medium Risk** - an area which has a chance of flooding of greater than 1 in 100 (1.0%) in any one year.
- Low Risk** - an area which has a chance of flooding of greater than 1 in 1000 (0.1%) in any one year.
- Very Low Risk** - an area in which the risk is below 1 in 1000 (0.1%) in any one year.

Chance of flooding to the following depths at this property:

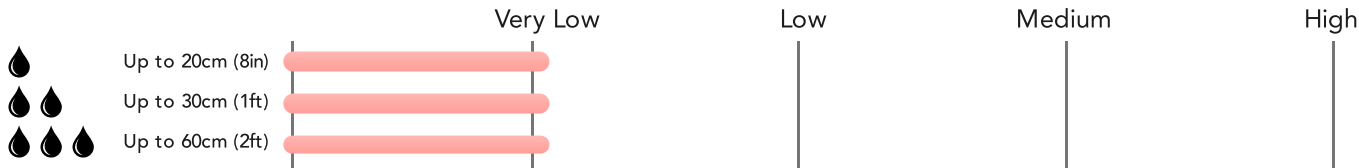

Flood Risk

Rivers & Seas - Climate Change

This map shows the future chance of flooding from rivers and / or the sea **between 2036 and 2069**, taking into account flood defences and their condition. The government climate change models cannot predict exactly when the chance of flooding will go up. It could happen at any time during the time period.

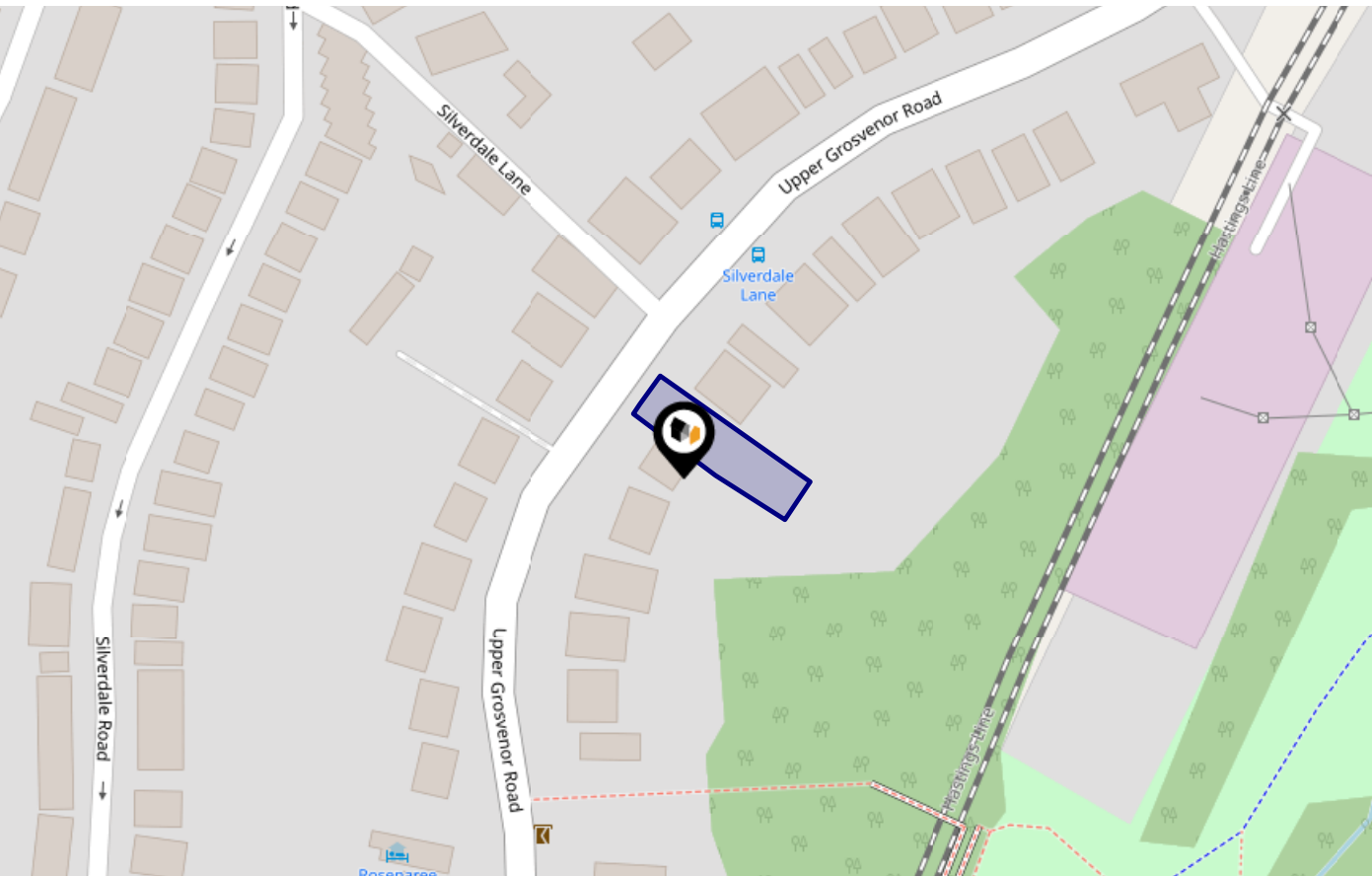

Risk Rating: **Very low**

The map does not contain sufficient information for it to be used to determine flood risk to individual properties, but it does give you an indication of whether your area may be affected by surface water flooding at this risk level.

- High Risk** - an area which has a chance of flooding of greater than 1 in 30 (3.3%) in any one year.
- Medium Risk** - an area which has a chance of flooding of greater than 1 in 100 (1.0%) in any one year.
- Low Risk** - an area which has a chance of flooding of greater than 1 in 1000 (0.1%) in any one year.
- Very Low Risk** - an area in which the risk is below 1 in 1000 (0.1%) in any one year.

Chance of flooding to the following depths at this property:

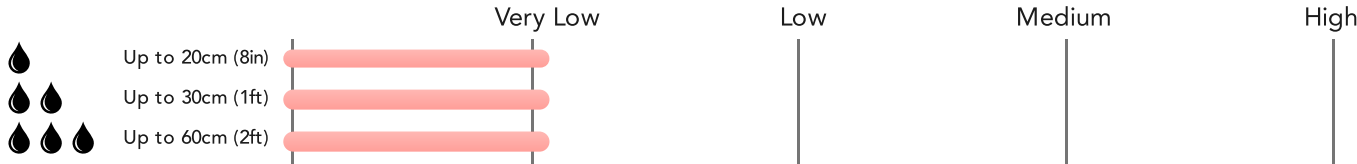

Flood Risk

Surface Water - Flood Risk

This map shows the chance of flooding where rainwater has nowhere to drain. This kind of flooding can occur far from rivers or seas.

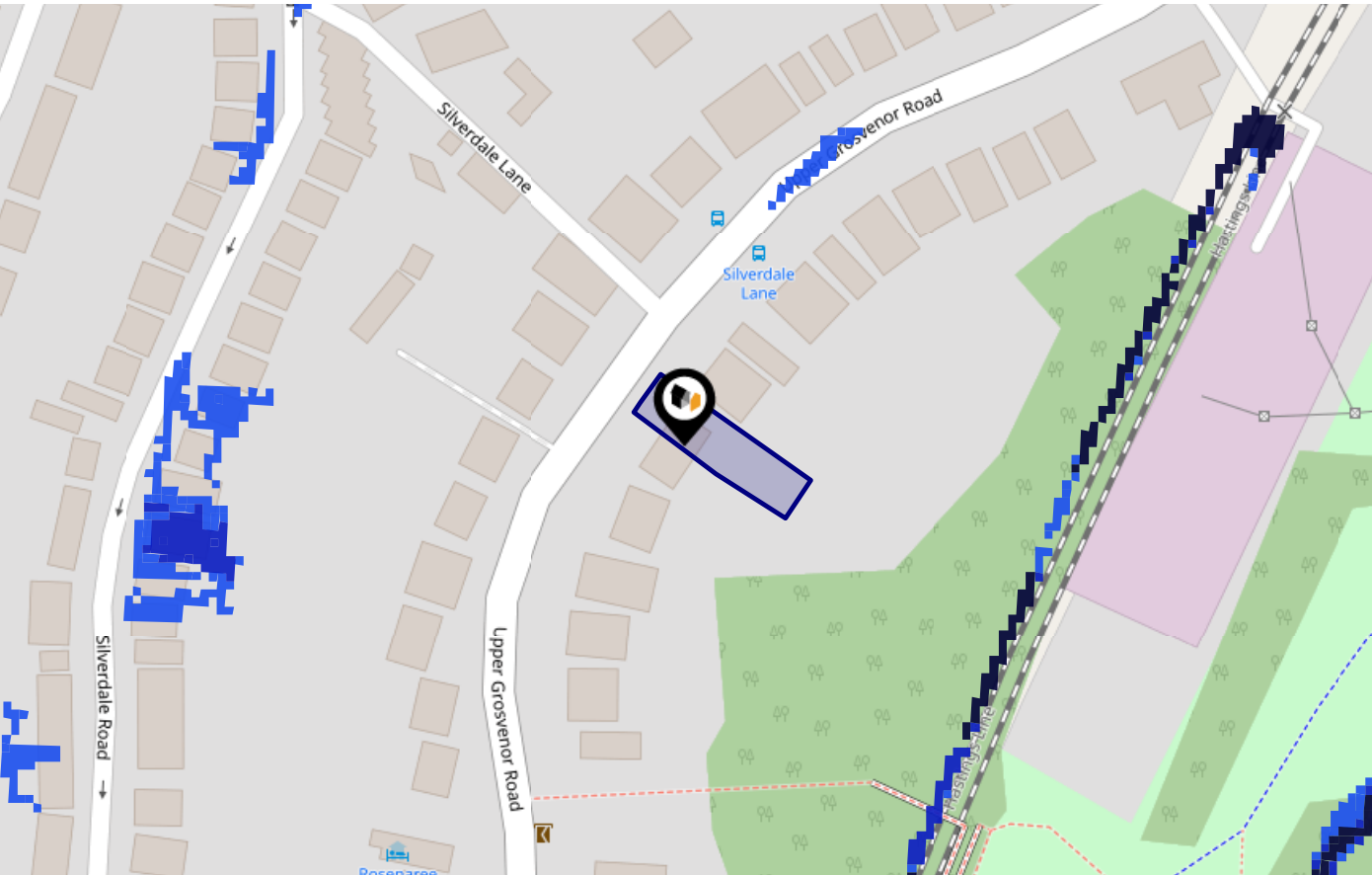

Risk Rating: Very low

The map does not contain sufficient information for it to be used to determine flood risk to individual properties, but it does give you an indication of whether your area may be affected by surface water flooding at this risk level.

- High Risk** - an area which has a chance of flooding of greater than 1 in 30 (3.3%) in any one year.
- Medium Risk** - an area which has a chance of flooding of greater than 1 in 100 (1.0%) in any one year.
- Low Risk** - an area which has a chance of flooding of greater than 1 in 1000 (0.1%) in any one year.
- Very Low Risk** - an area in which the risk is below 1 in 1000 (0.1%) in any one year.

Chance of flooding to the following depths at this property:

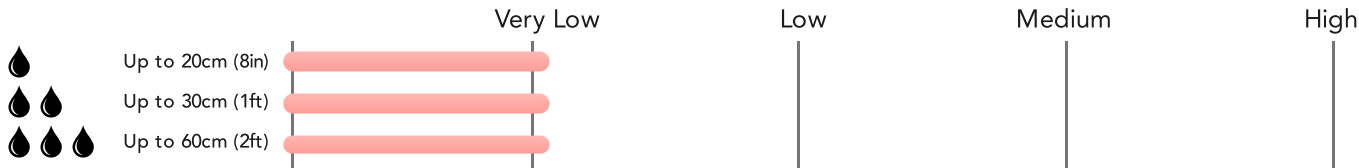

This map shows the future chance of flooding **between 2040 and 2060** where rainwater has nowhere to drain. This kind of flooding can occur far from rivers or seas. The government climate change models cannot predict exactly when the chance of flooding will go up. It could happen at any time during the time period.

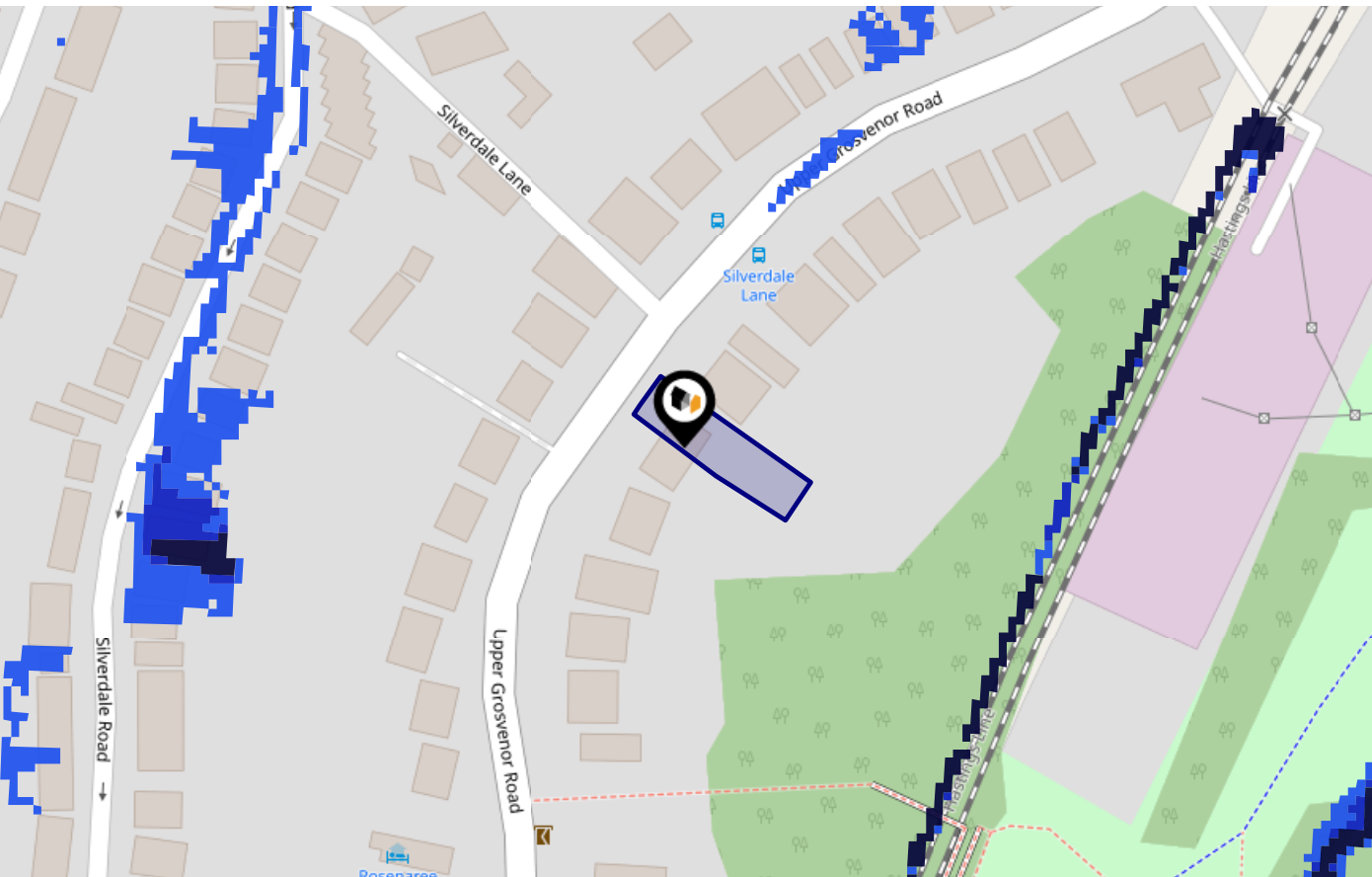

Risk Rating: Very low

The map does not contain sufficient information for it to be used to determine flood risk to individual properties, but it does give you an indication of whether your area may be affected by surface water flooding at this risk level.

- High Risk** - an area which has a chance of flooding of greater than 1 in 30 (3.3%) in any one year.
- Medium Risk** - an area which has a chance of flooding of greater than 1 in 100 (1.0%) in any one year.
- Low Risk** - an area which has a chance of flooding of greater than 1 in 1000 (0.1%) in any one year.
- Very Low Risk** - an area in which the risk is below 1 in 1000 (0.1%) in any one year.

Chance of flooding to the following depths at this property:

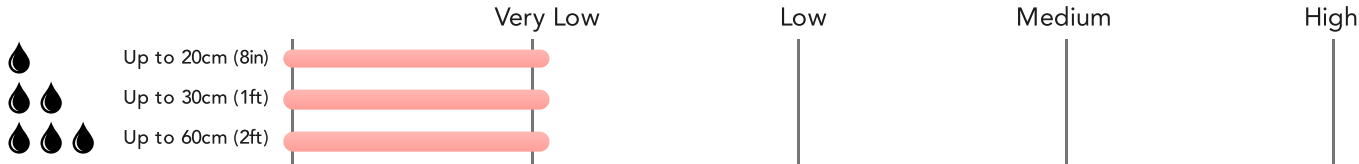

This map displays nearby areas that have been designated as Green Belt...

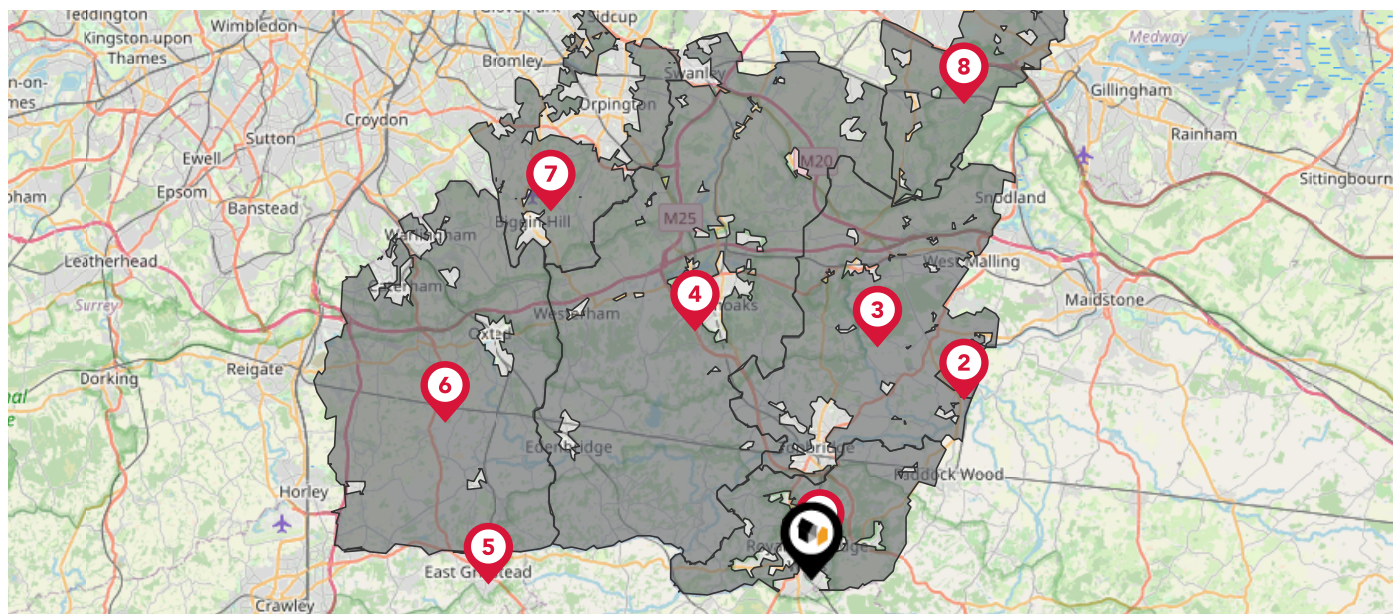

Nearby Green Belt Land



London Green Belt - Tunbridge Wells



London Green Belt - Maidstone



London Green Belt - Tonbridge and Malling



London Green Belt - Sevenoaks



London Green Belt - Mid Sussex



London Green Belt - Tandridge



London Green Belt - Bromley



London Green Belt - Gravesham

This map displays the location of known landfill sites. Historic sites are where there is no environmental permit in force. Active sites are currently authorised by the Environment Agency under Environmental Permitting Regulations.

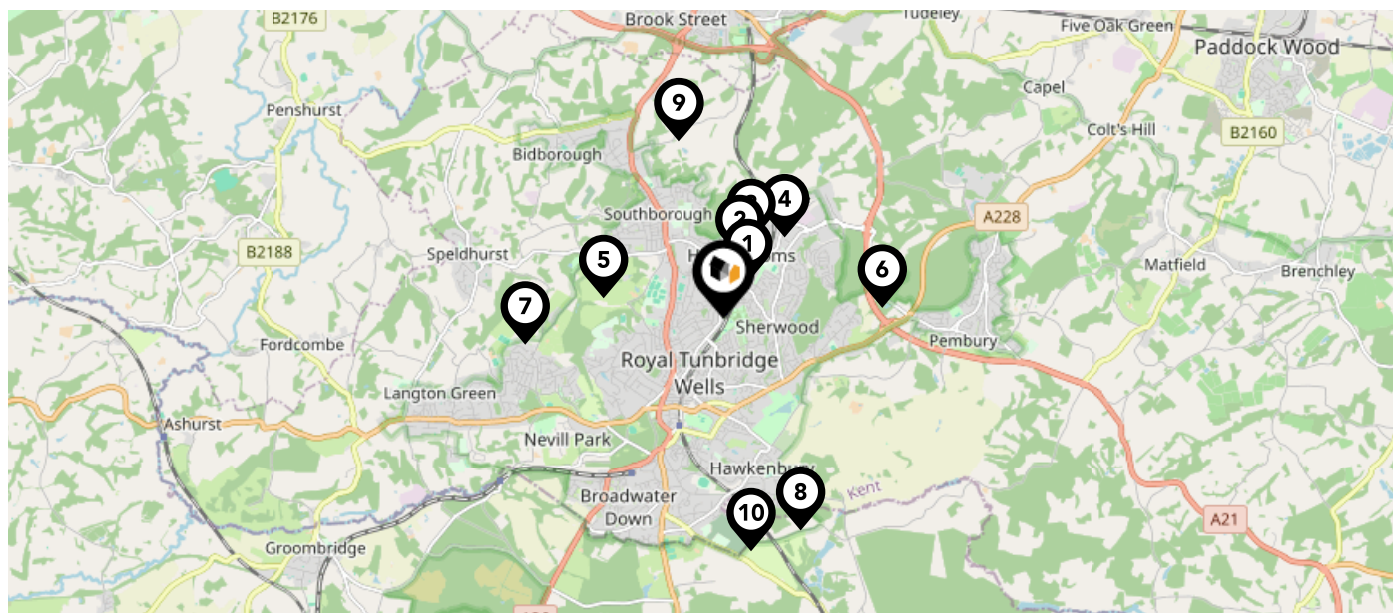

Nearby Landfill Sites

1	Chapmans Quarry-Chapman Way, High Brooms Industrial Park, Tunbridge Wells, Kent	Historic Landfill	
2	Highbrooms-Powder Mill Lane, Southborough, Tunbridge Wells, Kent	Historic Landfill	
3	Barnetts-Off Powder Mill Lane, High Brooms, Tunbridge Wells, Kent	Historic Landfill	
4	North Farm-North Farm Lane, High Brooms, Tunbridge Wells, Kent	Historic Landfill	
5	Southborough-Broomhill Road, Southborough, Tunbridge Wells, Kent	Historic Landfill	
6	Sandhill Quarry-Pembury, Tunbridge Wells, Kent	Historic Landfill	
7	Harwarton Farm-Off Lower Green Road, Rusthall, Tunbridge Wells, Kent	Historic Landfill	
8	Tutty's Hawkenbury-Hawkenbury Road, Hawkenbury, Kent	Historic Landfill	
9	Nightingale Farm-Tunbridge Wells, Kent	Historic Landfill	
10	Little Mount Farm-Benhall Mill Road, Frant	Historic Landfill	

This map displays nearby listed buildings and protected structures, as well as their listed tier and distance from the target property...

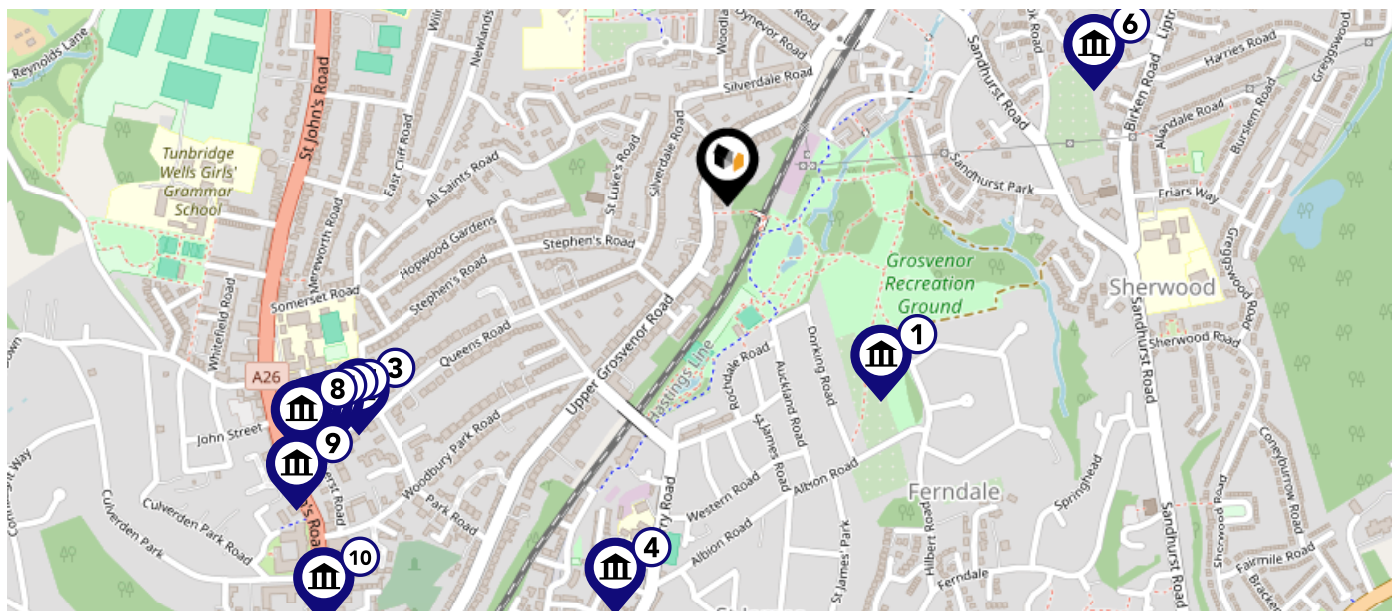



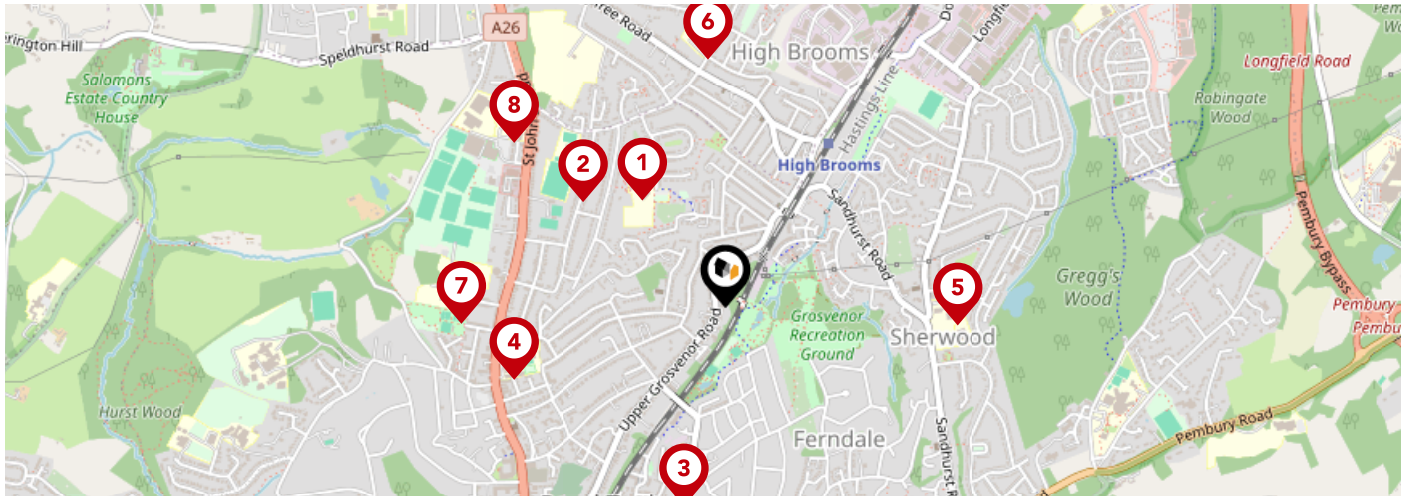



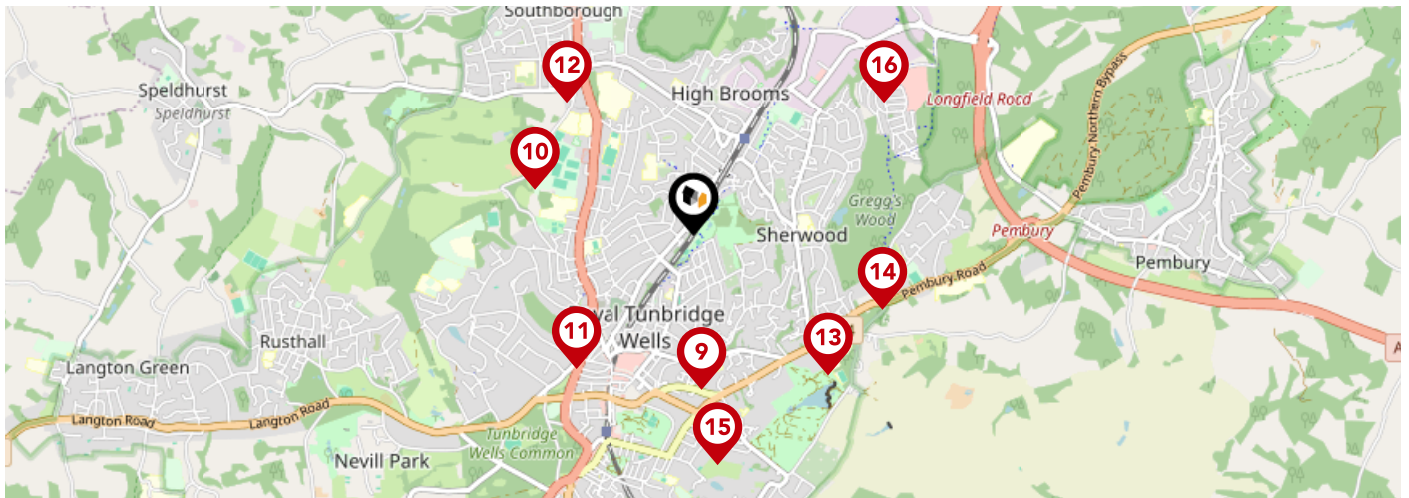

Listed Buildings in the local district		Grade	Distance
	1338822 - Packs In The Wood	Grade II	0.3 miles
	1431337 - Nos. 14 And 16 Newcomen Road	Grade II	0.5 miles
	1431344 - Nos. 26 And 28 Newcomen Road	Grade II	0.5 miles
	1338860 - Parish Church Of St Barnabas	Grade II	0.5 miles
	1431339 - Nos. 18 And 20 Newcomen Road	Grade II	0.5 miles
	1061387 - Liptraps House	Grade II	0.5 miles
	1431333 - Nos. 10 And 12 Newcomen Road	Grade II	0.6 miles
	1431309 - Nos. 6 And 8 Newcomen Road	Grade II	0.6 miles
	1065904 - Church Of St John	Grade II	0.6 miles
	1338859 - 32 And 34, St John's Road	Grade II	0.7 miles



		Nursery	Primary	Secondary	College	Private
1	St John's Church of England Primary School Ofsted Rating: Good Pupils: 630 Distance:0.32	<input type="checkbox"/>	<input checked="" type="checkbox"/>	<input type="checkbox"/>	<input type="checkbox"/>	<input type="checkbox"/>
2	St Augustine's Catholic Primary School Ofsted Rating: Good Pupils: 273 Distance:0.41	<input type="checkbox"/>	<input checked="" type="checkbox"/>	<input type="checkbox"/>	<input type="checkbox"/>	<input type="checkbox"/>
3	St Barnabas CofE VA Primary School Ofsted Rating: Good Pupils: 204 Distance:0.47	<input type="checkbox"/>	<input checked="" type="checkbox"/>	<input type="checkbox"/>	<input type="checkbox"/>	<input type="checkbox"/>
4	The Skinners' School Ofsted Rating: Good Pupils: 1118 Distance:0.52	<input type="checkbox"/>	<input type="checkbox"/>	<input checked="" type="checkbox"/>	<input type="checkbox"/>	<input type="checkbox"/>
5	Temple Grove Academy Ofsted Rating: Good Pupils: 197 Distance:0.54	<input type="checkbox"/>	<input checked="" type="checkbox"/>	<input type="checkbox"/>	<input type="checkbox"/>	<input type="checkbox"/>
6	St Matthew's High Brooms Church of England Voluntary Controlled Primary School Ofsted Rating: Requires improvement Pupils: 358 Distance:0.58	<input type="checkbox"/>	<input checked="" type="checkbox"/>	<input type="checkbox"/>	<input type="checkbox"/>	<input type="checkbox"/>
7	Tunbridge Wells Girls' Grammar School Ofsted Rating: Outstanding Pupils: 1042 Distance:0.62	<input type="checkbox"/>	<input type="checkbox"/>	<input checked="" type="checkbox"/>	<input type="checkbox"/>	<input type="checkbox"/>
8	Tunbridge Wells Grammar School for Boys Ofsted Rating: Good Pupils: 1730 Distance:0.62	<input type="checkbox"/>	<input type="checkbox"/>	<input checked="" type="checkbox"/>	<input type="checkbox"/>	<input type="checkbox"/>





		Nursery	Primary	Secondary	College	Private
	St James' Church of England Voluntary Aided Primary School Ofsted Rating: Good Pupils: 629 Distance:0.71	<input type="checkbox"/>	<input checked="" type="checkbox"/>	<input type="checkbox"/>	<input type="checkbox"/>	<input type="checkbox"/>
	St Gregory's Catholic School Ofsted Rating: Outstanding Pupils: 1313 Distance:0.77	<input type="checkbox"/>	<input type="checkbox"/>	<input checked="" type="checkbox"/>	<input type="checkbox"/>	<input type="checkbox"/>
	The Wells Free School Ofsted Rating: Good Pupils: 210 Distance:0.83	<input type="checkbox"/>	<input checked="" type="checkbox"/>	<input type="checkbox"/>	<input type="checkbox"/>	<input type="checkbox"/>
	Two Bridges School Ofsted Rating: Special Measures Pupils: 1 Distance:0.86	<input type="checkbox"/>	<input type="checkbox"/>	<input checked="" type="checkbox"/>	<input type="checkbox"/>	<input type="checkbox"/>
	Beechwood School Ofsted Rating: Not Rated Pupils: 354 Distance:0.9	<input type="checkbox"/>	<input type="checkbox"/>	<input checked="" type="checkbox"/>	<input type="checkbox"/>	<input type="checkbox"/>
	Skinners' Kent Academy Ofsted Rating: Good Pupils: 1036 Distance:0.94	<input type="checkbox"/>	<input type="checkbox"/>	<input checked="" type="checkbox"/>	<input type="checkbox"/>	<input type="checkbox"/>
	St Peter's Church of England Primary School Ofsted Rating: Outstanding Pupils: 210 Distance:1.07	<input type="checkbox"/>	<input checked="" type="checkbox"/>	<input type="checkbox"/>	<input type="checkbox"/>	<input type="checkbox"/>
	Skinners' Kent Primary School Ofsted Rating: Good Pupils: 210 Distance:1.08	<input type="checkbox"/>	<input checked="" type="checkbox"/>	<input type="checkbox"/>	<input type="checkbox"/>	<input type="checkbox"/>

Local Area

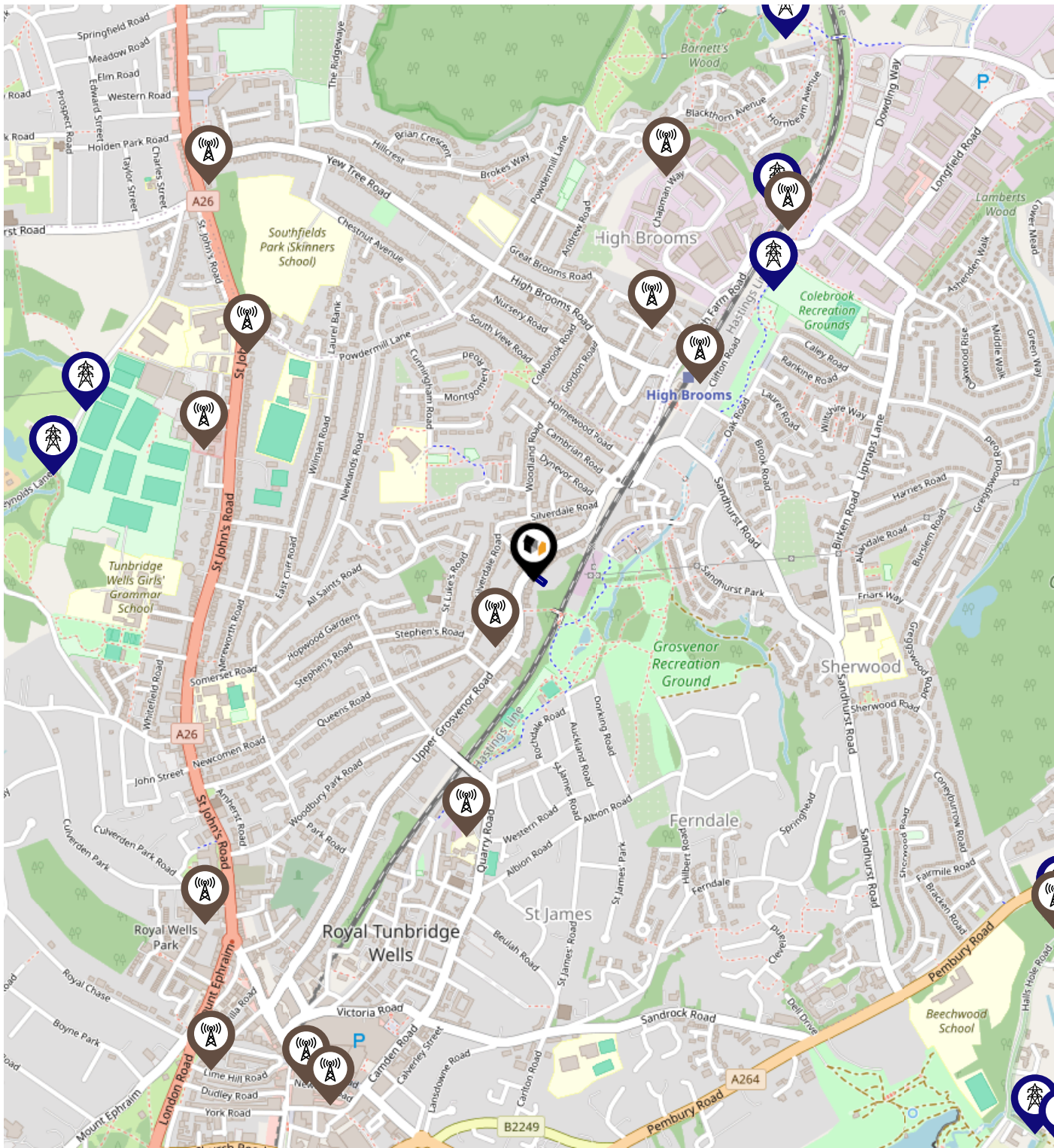
Masts & Pylons



Key:

-  Power Pylons
-  Communication Masts

What is Radon?

Radon is a natural radioactive gas, which enters buildings from the ground. Exposure to high concentrations increases the risk of lung cancer. The UK Health Security Agency (UKHSA) recommends that radon levels should be reduced in homes where the annual average is at or above 200 becquerels per cubic metre (200 Bq/m³).

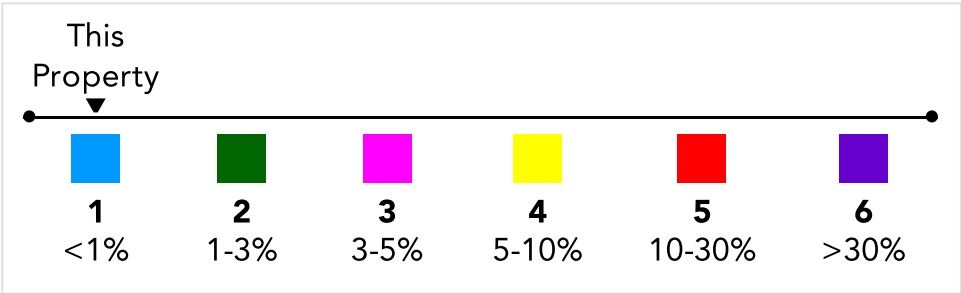
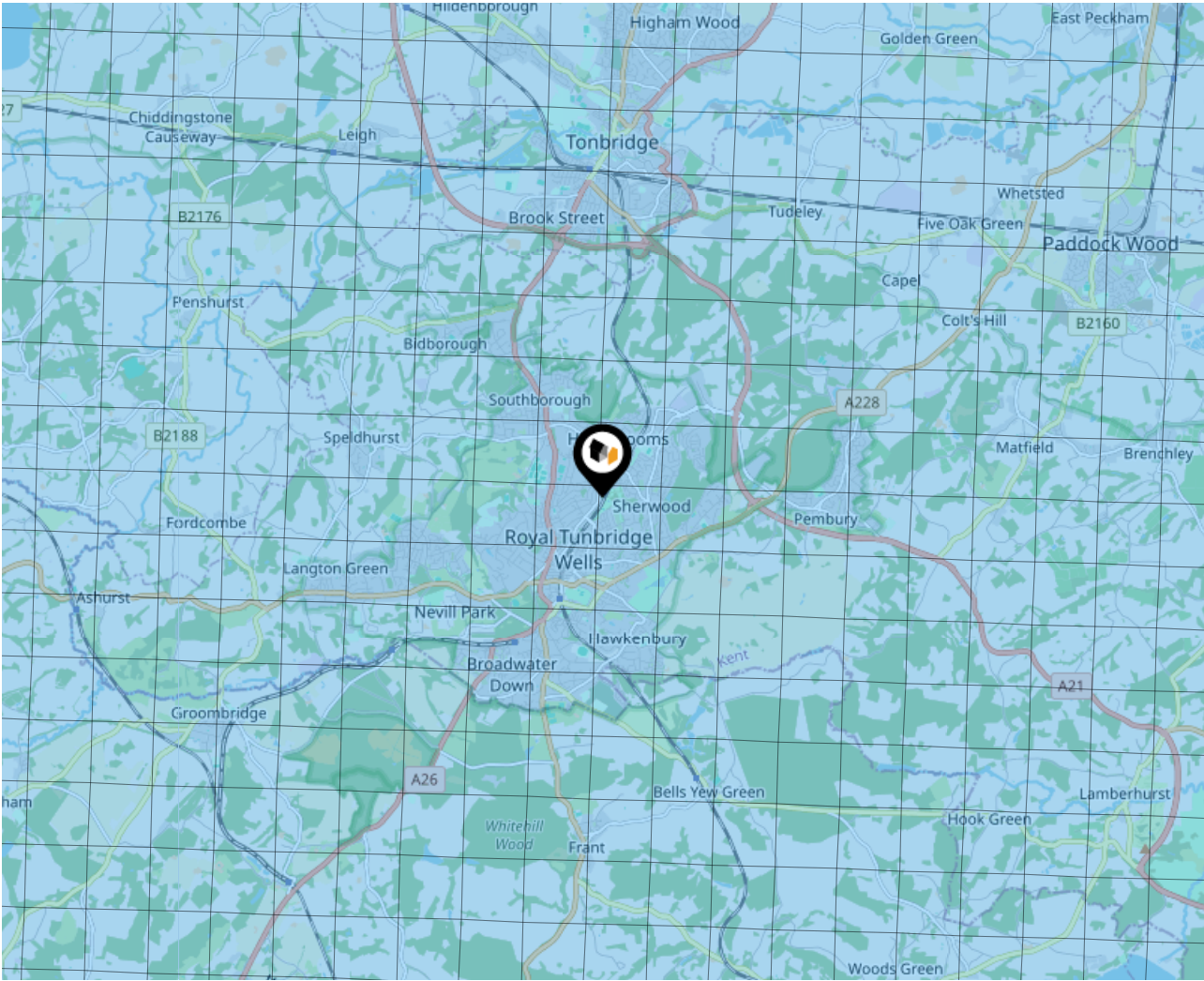

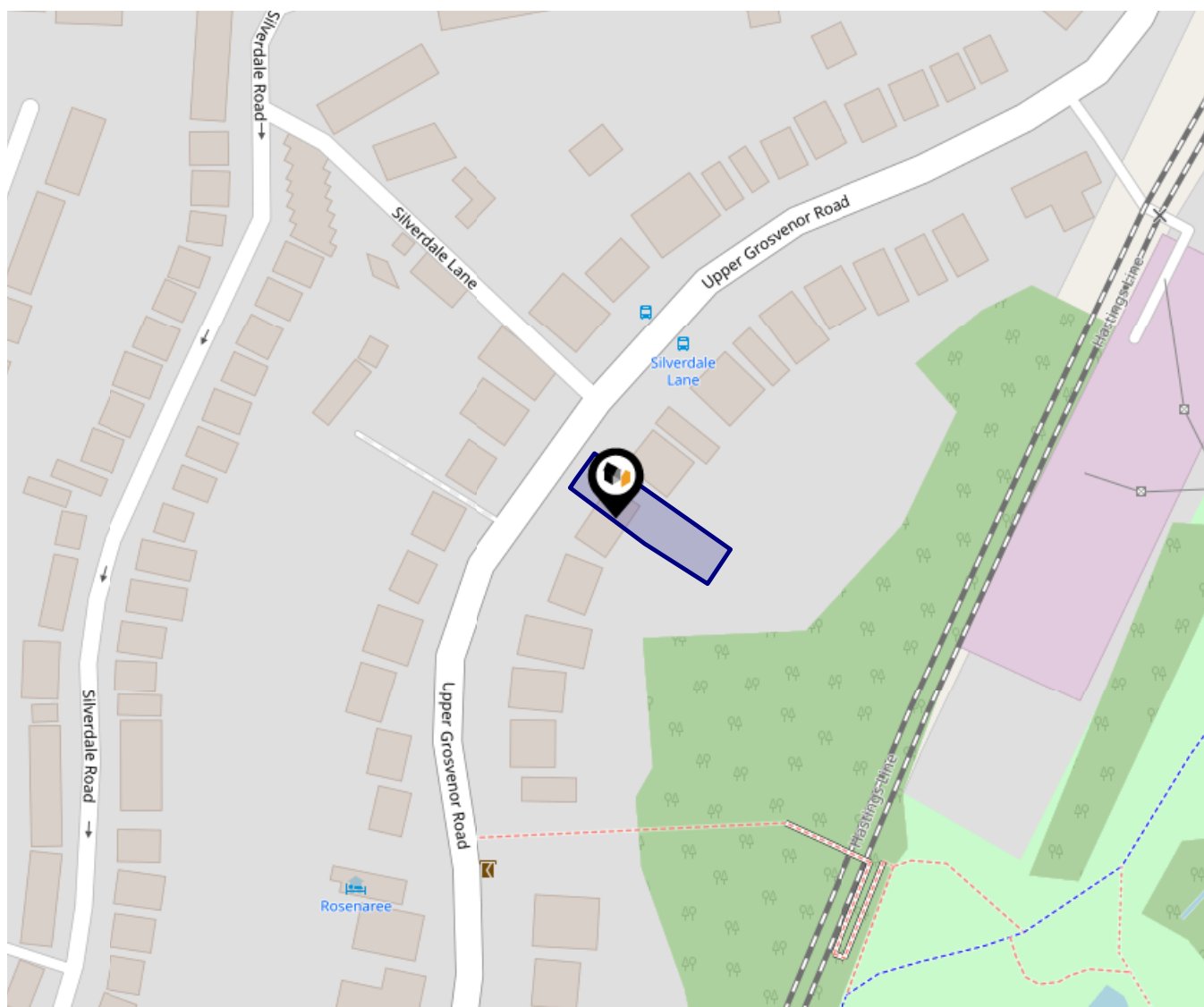

This data indicates the level of noise according to the strategic noise mapping of road sources within areas with a population of at least 100,000 people (agglomerations) and along major traffic routes. This indicates a 24 hour annual average noise level with separate weightings for the evening and night periods.

Noise levels are modelled on a 10m grid at a receptor height of 4m above ground, polygons are then produced by merging neighbouring cells within the following noise classes:

- 75.0+ dB
- 70.0-74.9 dB
- 65.0-69.9 dB
- 60.0-64.9 dB
- 55.0-59.9 dB

Ground Composition for this Address (Surrounding square kilometer zone around property)

Carbon Content:	NONE	Soil Texture:	SILTY LOAM
Parent Material Grain:	ARGILLIC - ARENACEOUS	Soil Depth:	DEEP-INTERMEDIATE
Soil Group:	MEDIUM(SILTY)		

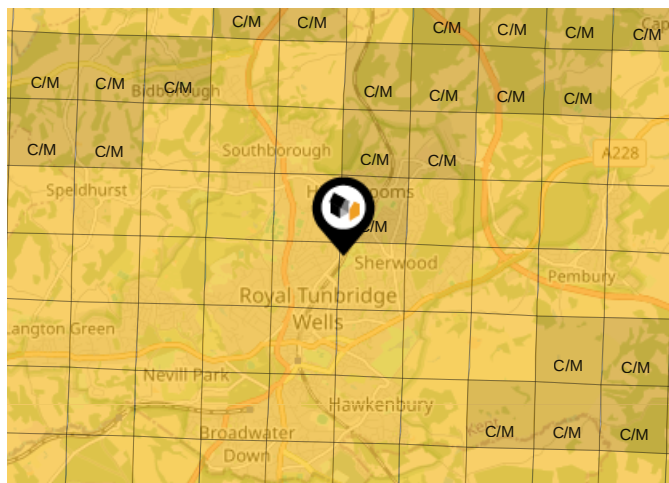

Primary Classifications (Most Common Clay Types)

C/M	Claystone / Mudstone
FPC,S	Floodplain Clay, Sand / Gravel
FC,S	Fluvial Clays & Silts
FC,S,G	Fluvial Clays, Silts, Sands & Gravel
PM/EC	Prequaternary Marine / Estuarine Clay / Silt
QM/EC	Quaternary Marine / Estuarine Clay / Silt
RC	Residual Clay
RC/LL	Residual Clay & Loamy Loess
RC,S	River Clay & Silt
RC,FS	Riverine Clay & Floodplain Sands and Gravel
RC,FL	Riverine Clay & Fluvial Sands and Gravel
TC	Terrace Clay
TC/LL	Terrace Clay & Loamy Loess



National Rail Stations

Pin	Name	Distance
1	High Brooms Rail Station	0.34 miles
2	High Brooms Rail Station	0.36 miles
3	Tunbridge Wells Rail Station	1.13 miles

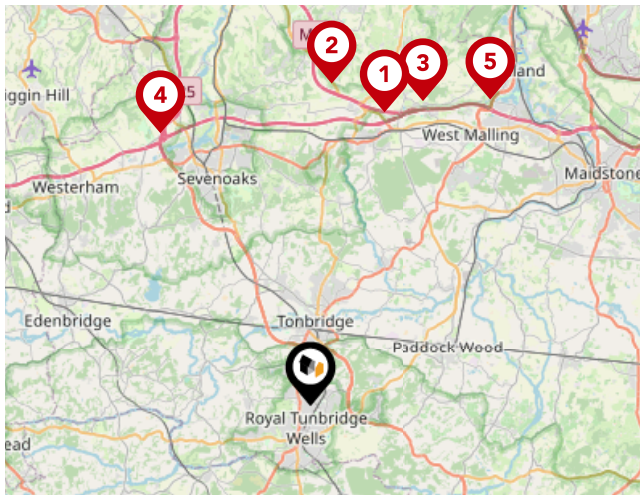

Trunk Roads/Motorways

Pin	Name	Distance
1	M26 J2A	11.18 miles
2	M20 J2	11.93 miles
3	M20 J3	12.04 miles
4	M25 J5	11.56 miles
5	M20 J4	13.12 miles



Airports/Helipads

Pin	Name	Distance
1	Leaves Green	16.59 miles
2	Silvertown	26.57 miles
3	Gatwick Airport	18.95 miles
4	Lydd Airport	31.66 miles

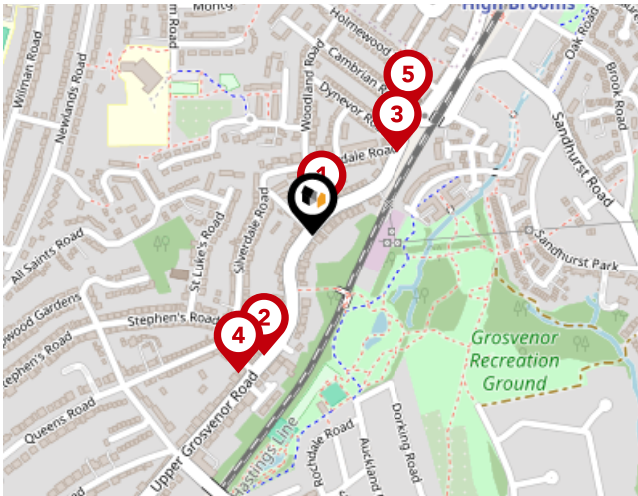

Bus Stops/Stations

Pin	Name	Distance
1	Silverdale Lane	0.03 miles
2	Queen's Road	0.15 miles
3	Silverdale Road	0.14 miles
4	Queen's Road	0.18 miles
5	Silverdale Road	0.18 miles

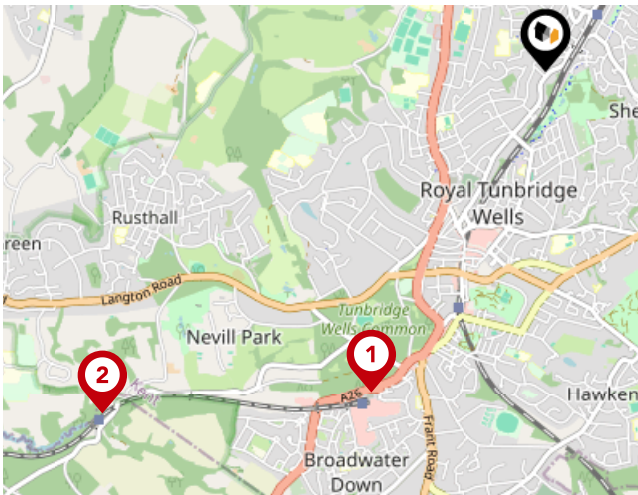

Local Connections

Pin	Name	Distance
1	Tunbridge Wells West (Spa Valley Railway)	1.7 miles
2	High Rocks (Spa Valley Railway)	2.61 miles

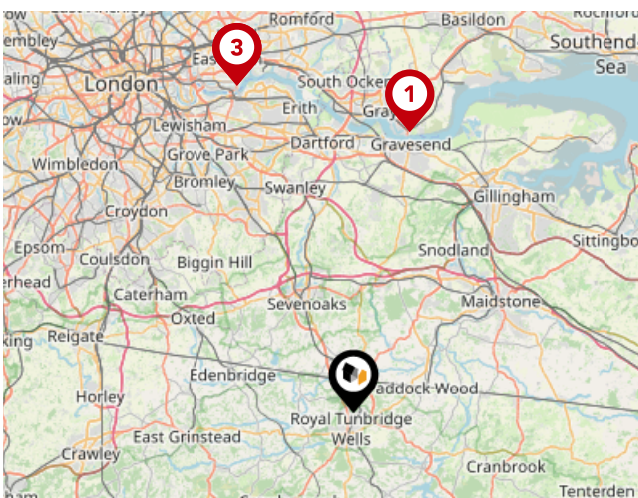

Ferry Terminals

Pin	Name	Distance
1	West Street Pier	21.15 miles
2	Woolwich Arsenal Pier	25.72 miles
3	Woolwich Royal Arsenal Pier	25.73 miles

Martin & Co Tunbridge Wells

Data Quality

We are committed to comprehensive property data being made available upfront to make the home buying and selling process quicker, easier and cheaper. This is why we have partnered with Sprift, the UK's leading supplier of property-specific data.



Contains public sector information licensed under the Open Government License v3.0

The information contained within this report is for general information purposes only.

Sprift Technologies Ltd aggregate this data from a wide variety of sources and while we endeavour to keep the information up to date and correct, we make no representations or warranties of any kind, express or implied, about the completeness, accuracy, reliability, of the information or related graphics contained within this report for any purpose.

Any reliance you place on such information is therefore strictly at your own risk. In no event will we be liable for any loss or damage including without limitation, indirect or consequential loss or damage, or any loss or damage whatsoever arising from loss of data or profits arising out of, or in connection with, the use of this report.



Martin & Co Tunbridge Wells

11 Vale Road Tunbridge Wells Kent TN1

1BS

01892 543856

david.rogers@martinco.com

www.martinco.com/estate-agents-and-letting-agents/branch/tunbridge-wells

