



**Front Street, Churchill**

**£585,000**



**debbie fortune**

ESTATE AGENTS

[www.debbiefortune.co.uk](http://www.debbiefortune.co.uk)





**Bedrooms: 5**

**Bathrooms: 3**

**Receptions: 4**

Discover Yew Tree House, a wonderfully spacious and versatile five bedroom detached home tucked away in a peaceful, private setting in the heart of the sought after village of Churchill. Thoughtfully designed for comfortable, flexible living, this nearly 2,000 sq ft property offers generous room proportions, modern finishes, and fantastic outdoor space—making it ideal for growing families, multi generational living, or those seeking a quieter lifestyle without compromising on convenience.

**A Home Designed for Modern Living:** At its heart is a superb contemporary kitchen, opening into an inviting dining/snug area—perfect for everyday family life or relaxed entertaining. The large sitting room, filled with natural light, features sliding doors that open directly onto the garden, extending your living space and creating an effortless indoor outdoor flow.





### **Flexible Accommodation for Every Lifestyle:**

With four to five bedrooms and three well appointed bathrooms, the layout offers excellent adaptability. Whether you need guest accommodation, a home office, hobby room, or space for teenagers, the home's arrangement suits a wide range of needs now and for the future.

### **Enjoy Outdoor Living & Scenic Views:**

The beautifully landscaped south west facing garden provides a tranquil retreat, complete with views towards the Mendip Hills—ideal for alfresco dining, gardening enthusiasts, or simply unwinding at the end of the day. Generous off street parking and a single garage add further practicality.

### **A Superb Village Location:**

Positioned in a discreet yet central location, the home is wonderfully placed for access to local amenities and sits within easy reach of the highly regarded Churchill Academy and Sixth Form, making it an excellent choice for families prioritising education. Mature buyers looking to downsize to a quieter, well connected village will also appreciate the peaceful setting and manageable outdoor areas.





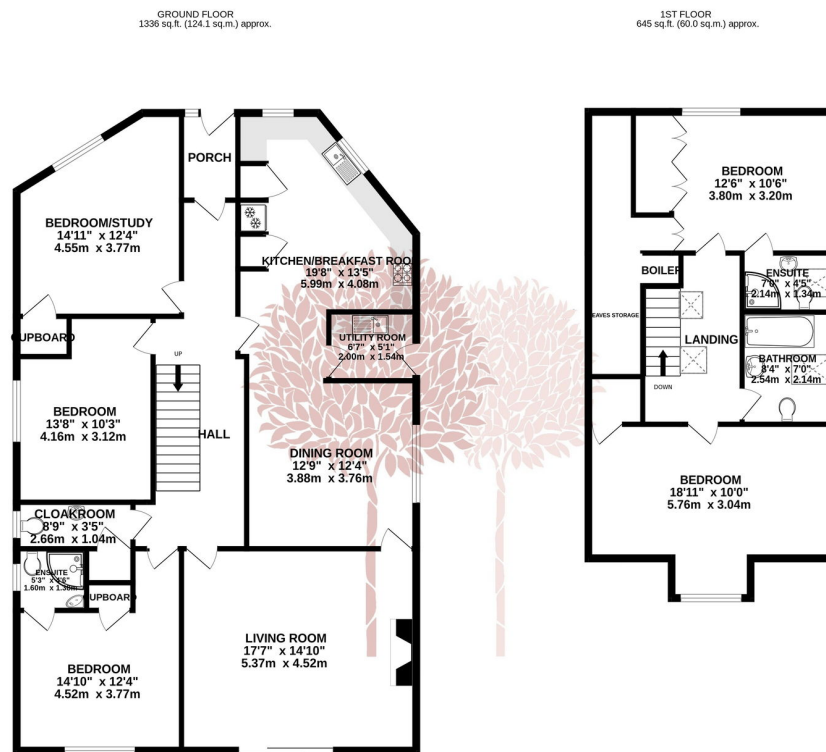

**Situation:** Churchill is a popular commuter village situated in the beautiful North Somerset countryside, which offers a range of village facilities which include a shop, pubs, churches, and primary school ([www.churchill-pri.n-somerset.sch.uk](http://www.churchill-pri.n-somerset.sch.uk)). Secondary schooling, both state and private, is well catered for with the ever-popular Churchill Academy & Sixth Form ([www.churchill.n-somerset.sch.uk](http://www.churchill.n-somerset.sch.uk)) on the doorstep and private schools at Bristol, Wells, Sidcot, Bath and Wraxall. Churchill is favoured by the commuter, being convenient for the cities of Bristol, Bath and Wells and the seaside town of Weston-super-Mare, and there is access to the M5 at Clevedon (junction 20) and St. Georges (junction 21). There is an international airport at Lulsgate and a mainline railway link at Yatton and Weston-super-Mare. The countryside around is well known for its beauty, with many country pursuits available including walking, Mountain biking, hunting, caving, dry skiing, sailing and fishing, and for the lover of equestrian arts, Churchill is very well served.

**Directions:** Travelling south on the A38 from Bristol, continue to Churchill traffic lights and turn right signposted to Weston-Super-Mare. Turn right at the Clock Tower and continue along Front Street, passing Orchard Walk on your right. As the sign for the Churchill Stores and Post office become visible to the right turn left just before the shop up the lane where you will find Yew Tree House towards the top on the right hand side.

What3words:  
///bulbs.bike.hedge

**Material Information:** This property operates on gas central heating. Council Tax band: F  
EPC Rating: C

