

## Stoney Batch Lane, Blagdon

£665,000

🛏 4 🚿 1 🛋 2



A beautifully positioned, four bedroom plus study, detached period cottage, enjoying exceptional panoramic views over the Wrington Vale and Chew Valley, with a delightful versatile footprint, stunning landscaped garden, off street parking and a single garage. The property also benefits from solar panels, an air source heat pump and character features.



## Key Features

- Enchanting detached period cottage set on a quiet no through lane
- Outstanding panoramic views over the Chew Valley and Blagdon lake
- Four bedrooms plus office, family bathroom and ground floor cloakroom
- Owned Solar panels and Air Source heat pump, battery and electric car charge point
- Delightful character features
- Stunning rear garden with a rich variety of flora, fauna, fruit trees and a productive vegetable plot
- Generous 'L' shaped sitting room and traditionally styled kitchen/breakfast

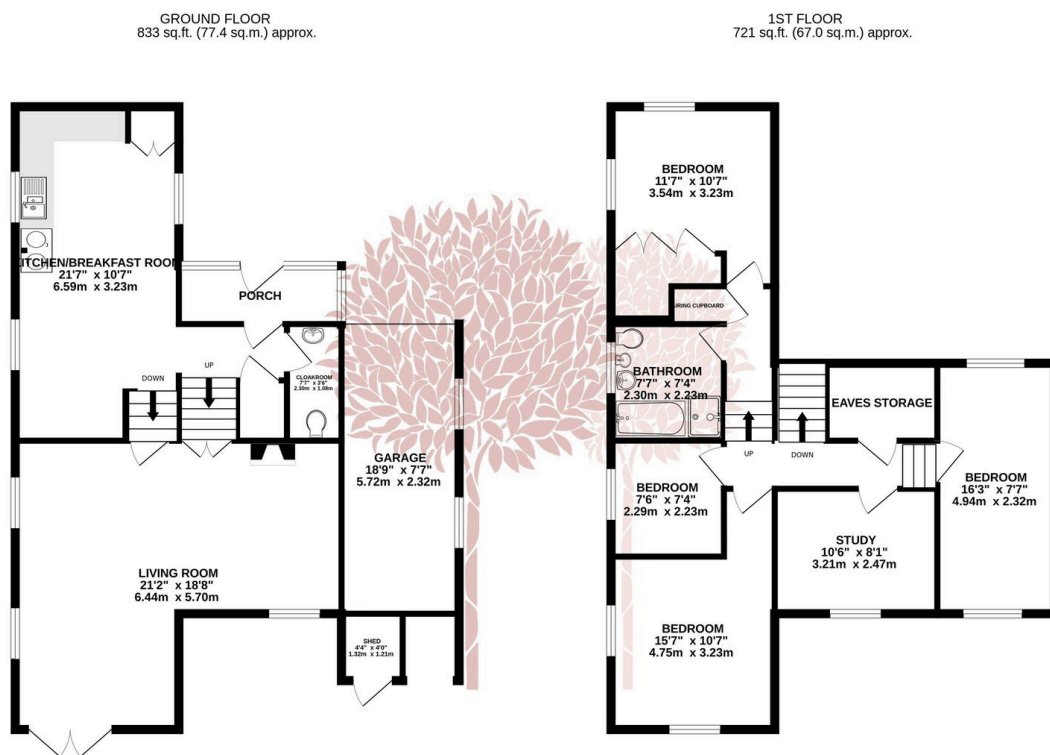

TOTAL FLOOR AREA: 1554 sq.ft. (144.4 sq.m.) approx.

Whilst every attempt has been made to ensure the accuracy of the floorplan contained here, measurements of doors, windows, rooms and any other items are approximate and no responsibility is taken for any error, omission or mis-statement. This plan is for illustrative purposes only and should be used as such by any prospective purchaser. The services, systems and appliances shown have not been tested and no guarantee as to their operability or efficiency can be given.

Made with Metropix ©2025

