

Ashford Road, Redhill

£370,000

🛏 3 🚿 1 🛋 2



UTTERLY CHARMING - Brimming with character, this attractive 1930s 3-bedroom property is set within the peaceful yet well-connected area of Redhill. Featuring classic period details and generous proportions throughout, the home offers a warm, welcoming atmosphere ideal for family living. **NO CHAIN**



Key Features

- Local Authority Tax Band D
- EPC Rated D
- Perfectly presented throughout
- No onward chain
- Perfectly positioned for easy access into Bristol or The Mendips and southwest
- Driveway parking for two/three cars
- Pretty enclosed rear gardens backing onto open fields
- Popular village location with local amenities to hand
- Attractive 1930's property with a wealth of character

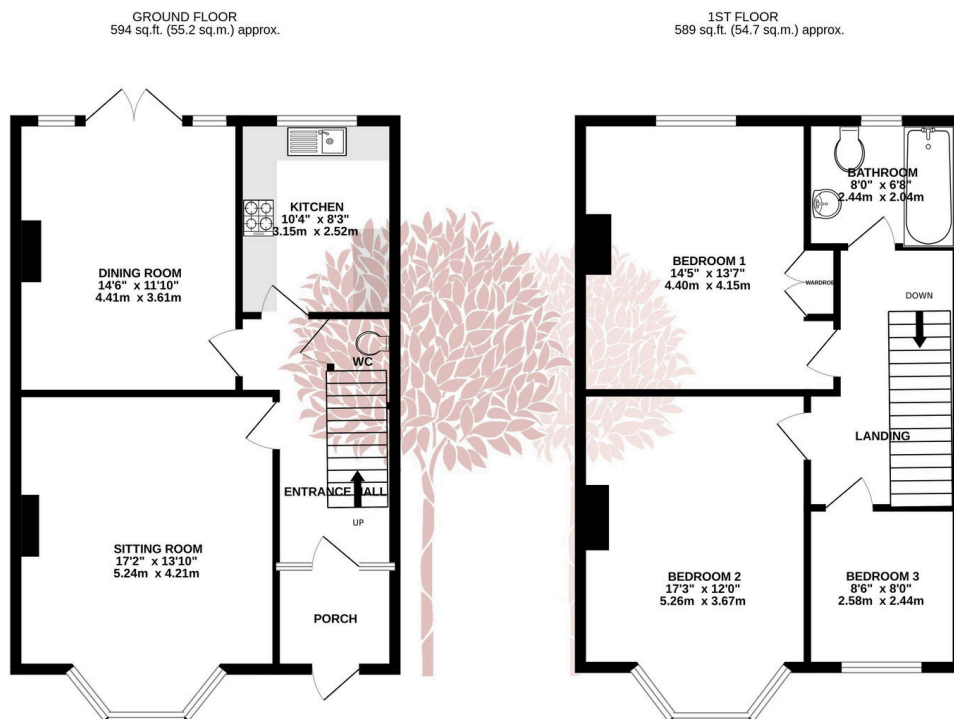

TOTAL FLOOR AREA: 1184 sq.ft. (110.0 sq.m.) approx.

Whilst every attempt has been made to ensure the accuracy of the floorplan contained here, measurements of doors, windows, rooms and any other items are approximate and no responsibility is taken for any error, omission or mis-statement. This plan is for illustrative purposes only and should be used as such by any prospective purchaser. The services, systems and appliances shown have not been tested and no guarantee as to their operability or efficiency can be given.

Made with Metropix ©2025

