

## Midway Cottage, Church Lane, Axbridge

£289,950

🛏 2 🚿 1 🛋 1



**NO ONWARD CHAIN** - A standout feature of the property is its stunning view of the nearby 13th-century Church of St John the Baptist, framed by traditional cottage windows. Outside, a private rear courtyard catches the morning sun and provides space for al fresco dining, with room for a table and chairs, a BBQ, and herb pots.

Perfectly positioned in the heart of this historic town, the location is not only steeped in history but also highly convenient, with excellent local amenities, pubs, restaurants, well-regarded schools, transport links, and beautiful countryside walks all close by.



## Key Features

- Picturesque two bedroom character cottage, set in the heart of the historic town 'Axbridge'
- Two double bedrooms
- Contemporary kitchen fitted with quality fixtures and fittings
- Situated around the corner from the amenities of Axbridge
- Semi-detached with a sunny courtyard garden
- An outstanding example of cottage aesthetic with a modern twist
- Good school catchment area and within walking distance
- EPC rating D

GROUND FLOOR  
365 sq.ft. (33.9 sq.m.) approx.

1ST FLOOR  
286 sq.ft. (26.6 sq.m.) approx.

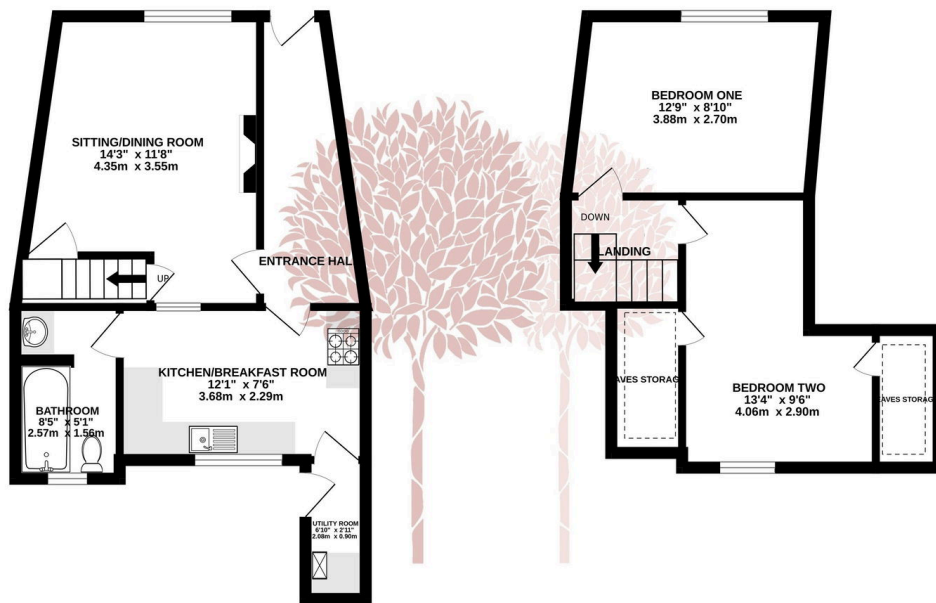

TOTAL FLOOR AREA: 652 sq.ft. (60.5 sq.m.) approx.

Whilst every attempt has been made to ensure the accuracy of the floorplan contained here, measurements of doors, windows, rooms and any other items are approximate and no responsibility is taken for any error, omission or mis-statement. This plan is for illustrative purposes only and should be used as such by any prospective purchaser. The services, systems and appliances shown have not been tested and no guarantee as to their operability or efficiency can be given.

Made with Metropix ©2025

