

Midway Cottage, Church Lane, Axbridge

£299,950

🛏 2 🚿 1 🛋 1



NO ONWARD CHAIN - Set in an evocative medieval lane near the 13th Century Church of St John the Baptist, and the historic square in Axbridge is this unique and character packed period cottage. EPC rating D.

This is the perfect home for First time buyers, downsizers or investors.

A character packed country cottage is deceptive in its accommodation and offers easy access to the plethora of amenities that Axbridge offers.



Key Features

- Picturesque two bedroom character cottage, set in the heart of the historic town 'Axbridge'
- Two double bedrooms
- Contemporary kitchen fitted with quality fixtures and fittings
- Situated around the corner from the amenities of Axbridge
- Investment property
- Semi-detached with a sunny courtyard garden
- An outstanding example of cottage aesthetic with a modern twist
- Good school catchment area and within walking distance
- EPC rating D
- Perfect for first time buyers

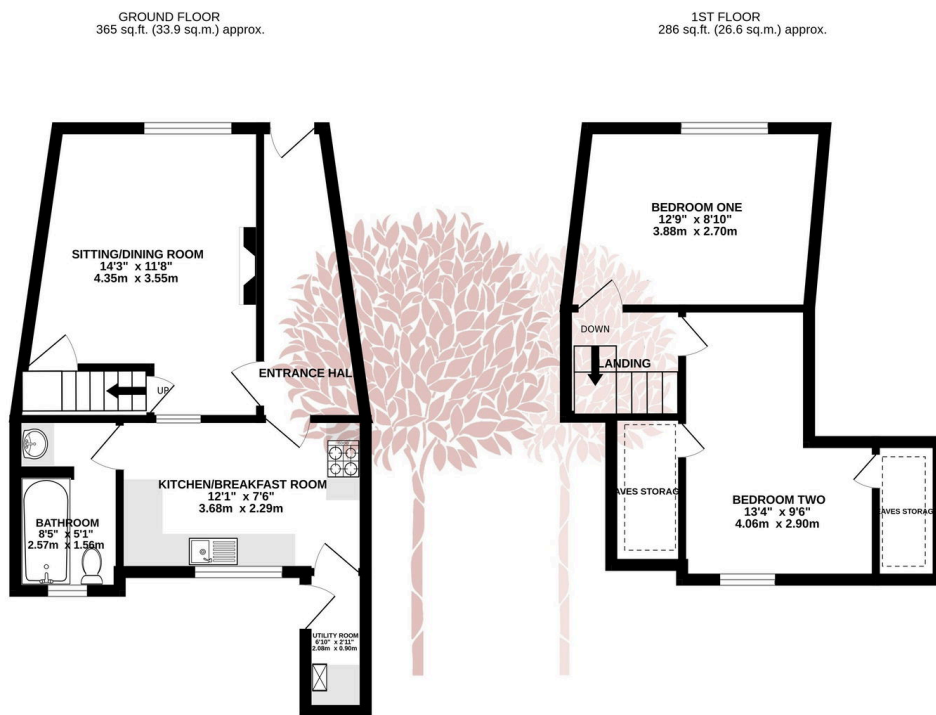

TOTAL FLOOR AREA: 652 sq.ft. (60.5 sq.m.) approx.

Whilst every attempt has been made to ensure the accuracy of the floorplan contained here, measurements of doors, windows, rooms and any other items are approximate and no responsibility is taken for any error, omission or mis-statement. This plan is for illustrative purposes only and should be used as such by any prospective purchaser. The services, systems and appliances shown have not been tested and no guarantee as to their operability or efficiency can be given.

Made with Metropix ©2025

