

The Barrows, Cheddar

£675,000

🛏 4 🍷 2 🛋 4



An enchanting three/four bedroom detached period house set in wonderful established grounds in heart of Cheddar. 'Rowberrow House' is a picture postcard character home constructed of beautiful local stone, internally it still displays many of its original period features including fireplaces, picture rails and polished wooden floorboards. The house has been sympathetically extended in more recent years, has generous off street parking, plus a large detached double garage and still so much future potential.



Key Features

- Beautiful local stone detached house
- Exceptional south/west facing rear garden
- Plethora of original period details
- Well appointed kitchen, separate utility room and ground floor cloakroom
- Lots of future potential
- Versatile accommodation with 3/4 bedrooms
- Double garage plus generous off street parking
- Sitting room/dining room/study and spacious family/garden room
- Wonderful central village position on the Barrows
- EPC rating pending

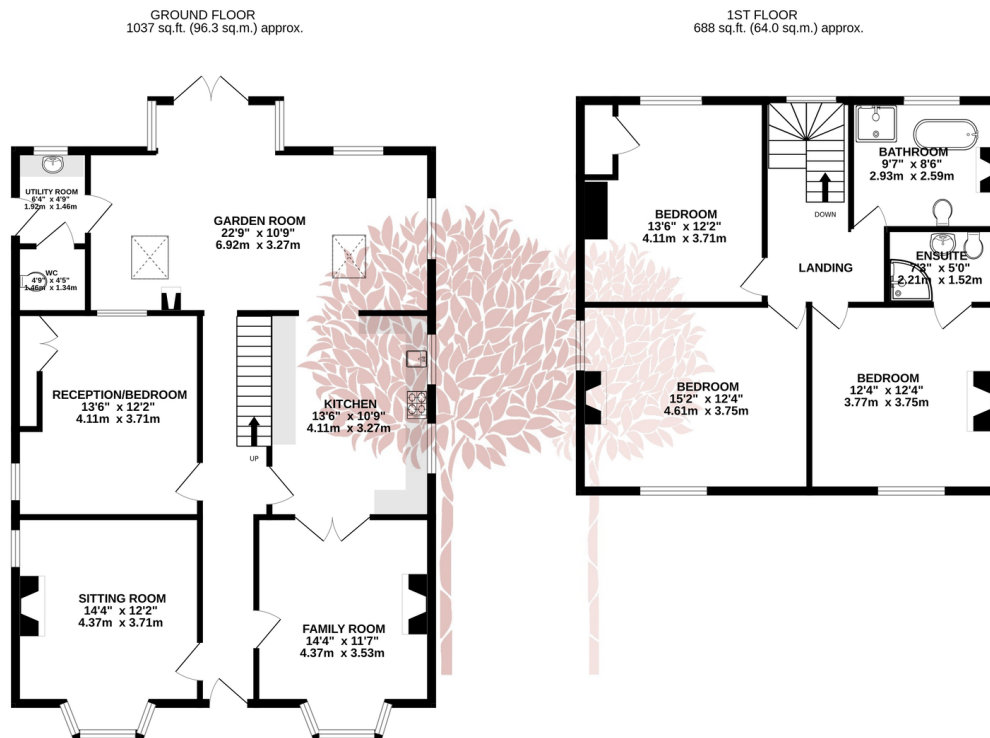

TOTAL FLOOR AREA: 1725 sq.ft. (160.3 sq.m.) approx.

Whilst every attempt has been made to ensure the accuracy of the floorplan contained here, measurements of doors, windows, rooms and any other items are approximate and no responsibility is taken for any error, omission or mis-statement. This plan is for illustrative purposes only and should be used as such by any prospective purchaser. The services, systems and appliances shown have not been tested and no guarantee as to their operability or efficiency can be given.

Made with Metropix ©2025

