

Observatory Field, Winscombe

£650,000

🛏 5 🚿 3 🛋 2



A superb five bedroom detached family home occupying a beautiful elevated position in this highly regarded development benefitting from a stunning south/west facing garden, double garage plus separate gated driveway, solar panels and exceptional views to the rear towards the Mendip Hills.



Key Features

- Superb five bedroom detached family home
- Beautiful South/West facing garden with additional side vegetable/flower garden
- Well appointed modern kitchen/breakfast room with utility room off
- Two further bathrooms including a jack and jill shared by two bedrooms
- Owned Solar Panels
- Double garage and generous gated driveway
- Triple aspect living room, plus dining room and home office/study
- Five bedrooms including master suite with dressing room and bathroom
- Tasteful decor throughout
- Fabulous views to the rear over the village towards the Mendip Hills

GROUND FLOOR

1ST FLOOR

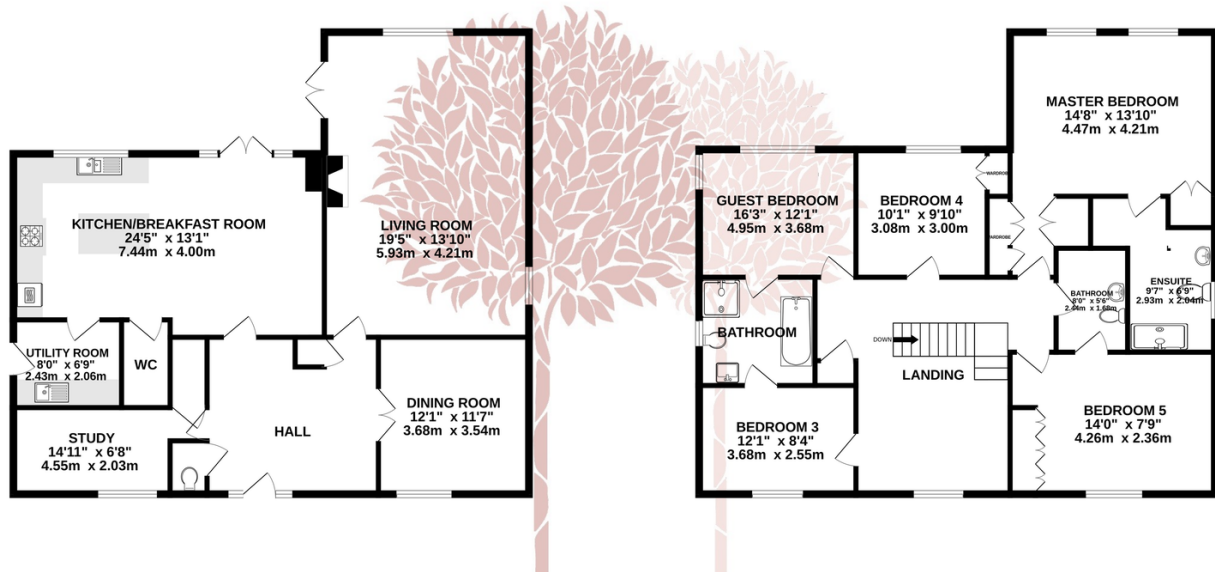

TOTAL FLOOR AREA : 2454sq.ft. (228.0 sq.m.) approx.

Whilst every attempt has been made to ensure the accuracy of the floorplan contained here, measurements of doors, windows, rooms and any other items are approximate and no responsibility is taken for any error, omission or mis-statement. This plan is for illustrative purposes only and should be used as such by any prospective purchaser. The services, systems and appliances shown have not been tested and no guarantee as to their operability or efficiency can be given.

Made with Metropix ©2025

