

debbie fortune

ESTATE AGENTS

Milton Hill, Weston-super-mare

£630,000

🛏 5 🚗 3 🚲 3



CONTEMPORARY HOME- A superb detached home, offering in excess of 2600 sq ft of beautifully appointed accommodation, offering light filled and versatile living spaces, accompanied by as many as six bedrooms. The property also benefits from no onward chain.



Key Features

- Superb bespoke contemporary home
- Five/Six bedrooms, three bathrooms
- Incredibly versatile accommodation perfect for those who work from home
- Parking for a good number of vehicles
- Council Tax Band F/EPC C
- Wonderful hillside position
- Impressive living room with vaulted ceiling, plus dining room & Gymnasium
- Beautifully appointed throughout
- Westerly orientated low maintenance rear garden

GROUND FLOOR
1509 sq.ft. (140.2 sq.m.) approx.

1ST FLOOR
910 sq.ft. (84.6 sq.m.) approx.

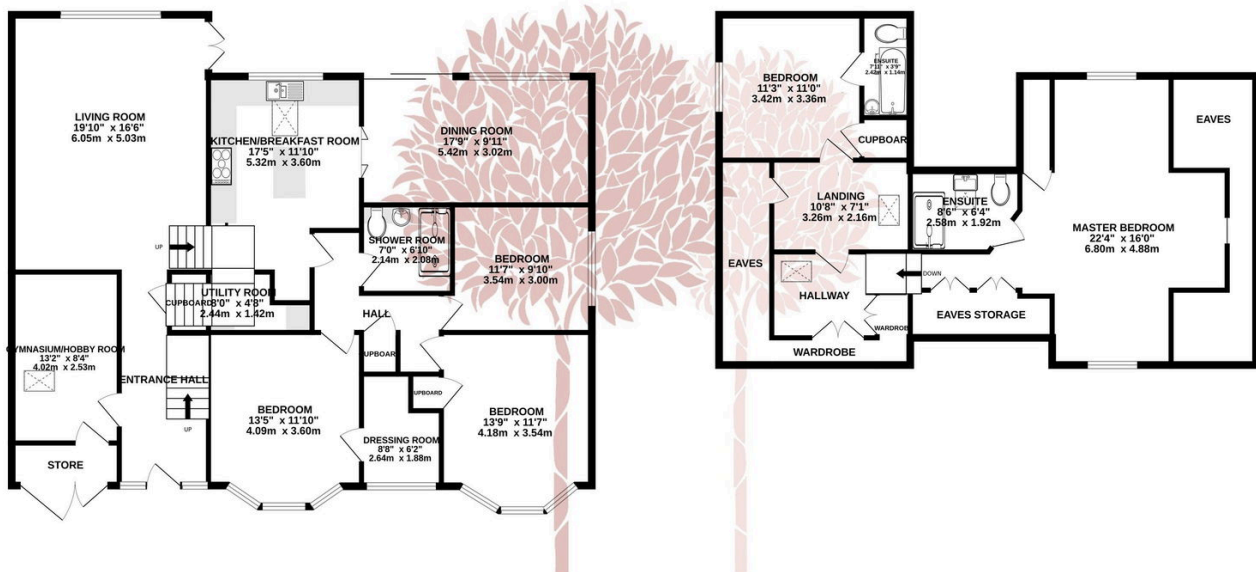

TOTAL FLOOR AREA : 2419 sq.ft. (224.7 sq.m.) approx.

Whilst every attempt has been made to ensure the accuracy of the floorplan contained here, measurements of doors, windows, rooms and any other items are approximate and no responsibility is taken for any error, omission or mis-statement. This plan is for illustrative purposes only and should be used as such by any prospective purchaser. The services, systems and appliances shown have not been tested and no guarantee as to their operability or efficiency can be given.
Made with Metropix ©2024

