

Wrington Mead, Congresbury

Offers In Region Of £350,000

3 2 1



GREAT POTENTIAL - Situated on a quiet and popular cul de sac on the northern fringes of the village of Congresbury, is this great sized three bedroom house which offers great versatility and is ideally positioned to enjoy the many excellent amenities of the village whilst being a short commute to Bristol, and on the doorstep of miles of beautiful countryside walks and scenic views.



Key Features

- Three bedroom semi-detached family home
- Off street parking and garage
- No onward chain!
- Churchill Secondary School catchment area
- Council Tax Band C
- Potential to improve and extend (subject to planning permission)
- Well-stocked, large rear garden
- Walking distance to village amenities
- EPC rating D
-

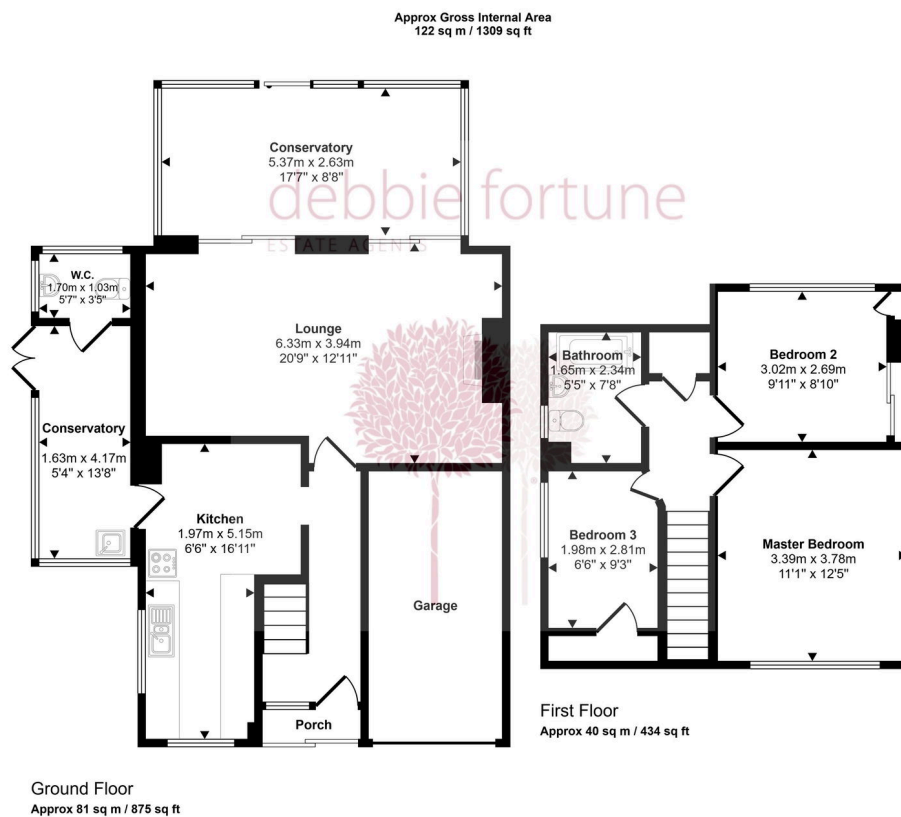

This floorplan is only for illustrative purposes and is not to scale. Measurements of rooms, doors, windows, and any items are approximate and no responsibility is taken for any error, omission or mis-statement. Icons of items such as bathroom suites are representations only and may not look like the real items. Made with Made Snappy 360.

