

# debbie fortune

ESTATE AGENTS

## Hill Park, Congresbury

£279,950

🛏 2 🚿 1 🚗 1



Situated in an elevated position on Hill Park is this lovely two bedroom bungalow with views over to the Mendips. Perfect for first time buyers, downsizers or investors.



## Key Features

- Semi-detached bungalow
- Low maintenance garden
- Outdoor storage
- Great for First time buyers, investors, or people looking to downsize
- Council tax band B
- Two double bedrooms
- Off street parking
- Views looking to the Mendip Hills
- Well proportioned rooms
- EPC rating D

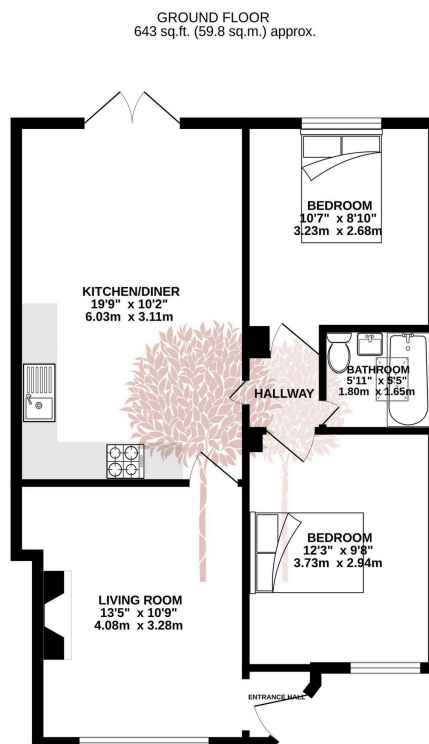

TOTAL FLOOR AREA - 643 sq.ft. (59.8 sq.m.) approx.  
Whilst every attempt has been made to ensure the accuracy of the description contained here, measurements of doors, windows, rooms and any other items are approximate and no responsibility is taken for any error, omission or mis-statement. This plan is for illustrative purposes only and should be used as such by any prospective purchaser. The services, systems and appliances shown have not been tested and no guarantee is given as to their operability or efficiency can be given.  
Made with Metropac C2024

