

Rockeries Drive, Winscombe

Guide Price £795,000

🛏 6 🍷 4 🛋 5



Strawberry Lodge really does offer an extremely inviting lifestyle or co-habiting opportunity. Currently a very unique period home arranged as a two bedroom ground floor apartment, a two bedroom first floor apartment (with attic room) and a superb 32' attached converted barn which is currently utilised as a profitable and popular Air B&B. The properties are situated on Rockeries Drive, a quiet no through lane which runs alongside the beautiful Strawberry Line foot and cycle path running all the way from Shepton Mallet to Clevedon. We are delighted to bring this property to the market and look forward to showing you around, please don't hesitate to call our team to arrange a convenient time.



Key Features

- Amazing dual occupation opportunity in a beautiful village setting
- Separate 32ft luxurious barn conversion currently utilised as an Air B&B
- Wonderful potential to re-configure the house and barn into one magnificent family home
- Close to many excellent local amenities, schools, and the wonderful Strawberry Line foot and cycle path
- Delightful south facing aspect with views towards the Mendip Hills
- Principal period home converted into a ground floor flat and first floor flat (both two beds)
- Attractive gardens and generous off street parking
- Lovely period features with contemporary modern day refinements
- Attic room to main house and large loft storage space
- EPC rating D, council tax rating pending

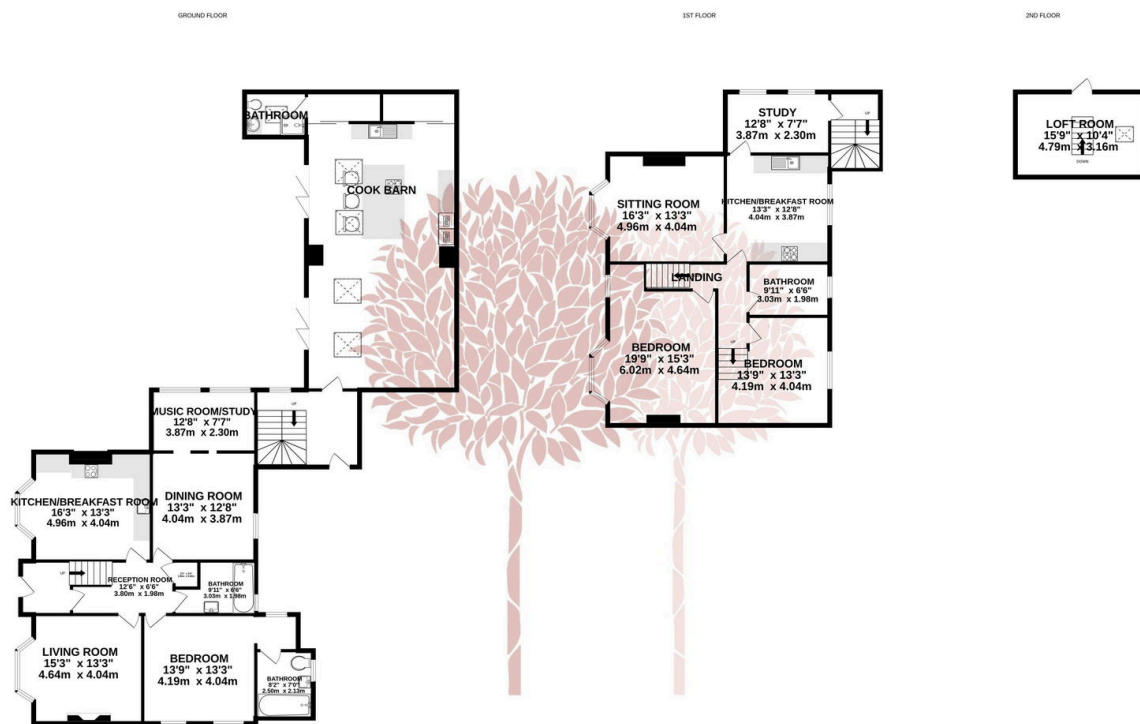

Whilst every attempt has been made to ensure the accuracy of the floorplan contained here, measurements of doors, windows, rooms and any other items are approximate and no responsibility is taken for any error, omission or mis-statement. This plan is for illustrative purposes only and should be used as such by any prospective purchaser. The services, systems and appliances shown have not been tested and no guarantee as to their operability or efficiency can be given.

Made with Metropix ©2024

