

Milliers Road, Cleeve

£585,000

🛏️ 4 🚿 3 🛋️ 2



DETACHED BUNGALOW - Situated in the convenient location of Cleeve, is this fantastic four bedroom detached bungalow with plenty of off street parking and good size garden to the rear.



Key Features

- Four bedroom detached bungalow
- Modern kitchen/diner
- Superb size master bedroom with Juliette balcony
- Good size rear garden
- Off street parking
- Backwell School catchment area
- Great transport links with easy access to Bristol and Weston-super-Mare
- Council tax band E
- EPC TBC

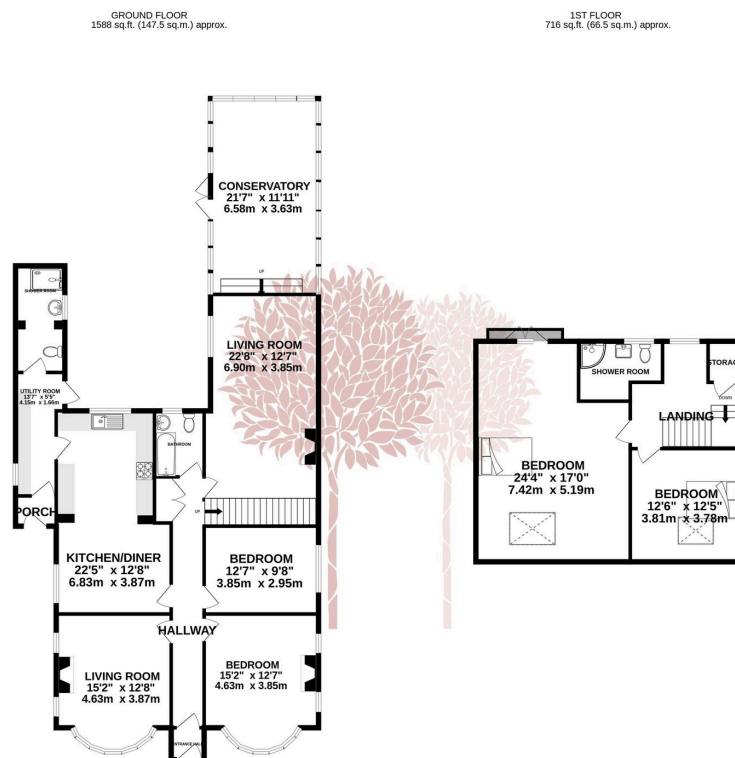

TOTAL FLOOR AREA: 2303 sq.ft. (214.0 sq.m.) approx.

Whilst every attempt has been made to ensure the accuracy of the floorplan contained herein, measurements of doors, windows, rooms and any other items are approximate and no responsibility is taken for any errors, omissions or mis-statements. This plan is for illustrative purposes only and should be used as such for any prospective purchase. The services, systems and appliances shown have not been tested and no guarantee as to their operability or efficiency can be given.

Made with Metropix ©2024

