

Williams Yard, Winford

Guide Price £450,000

🛏 3 🚿 2 🚺 2



IMPRESSIVE ECO-HOME - This highly impressive, oak framed eco-friendly house is full of charm as well as practicality! Features include solar and thermal panels, air exhaust heat pump, full underfloor heating and excellent insulation. Three double bedrooms, cloakroom, bathroom and ensuite. Large lounge with 5kw log burner, fabulous kitchen/breakfast room, stunning oak floors and a beautiful bespoke orangery plus off street parking for two cars. Ideal commute to Bristol.



Key Features

- Oak framed eco-home
- Beautiful bespoke orangery
- Air source heating, solar and thermal panels
- Under floor heating throughout
- Council Tax band D
- Three double bedrooms, bathroom and en-suite
- Off street parking for two cars
- Triple Glazing
- Village location with easy commute to Bristol
- EPC rating B

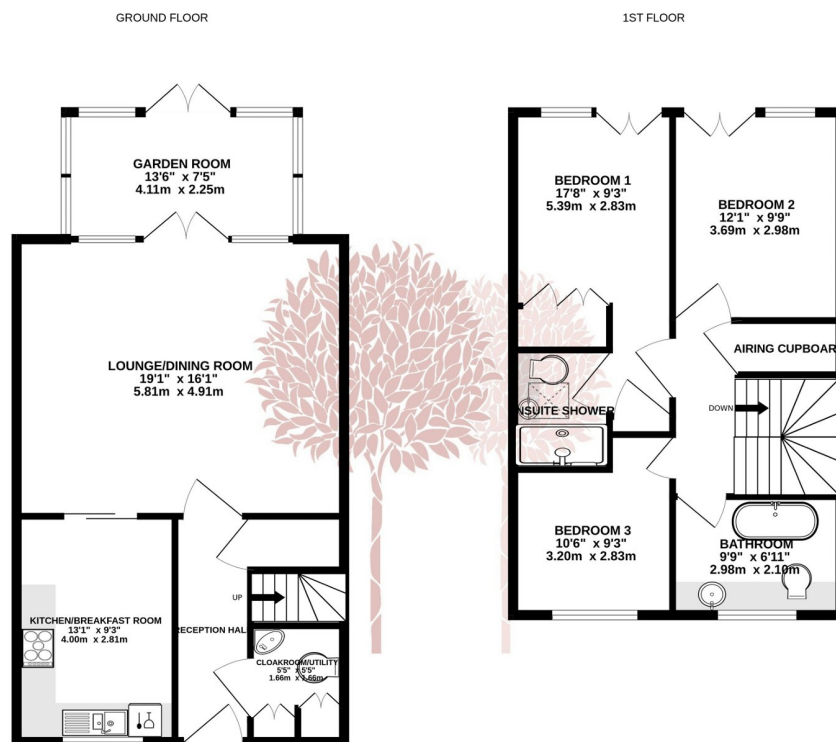

Whilst every attempt has been made to ensure the accuracy of the floorplan contained here, measurements of doors, windows, rooms and any other items are approximate and no responsibility is taken for any error, omission or misstatement. This plan is for illustrative purposes only and should be used as such by any prospective purchaser. The services, systems and appliances shown have not been tested and no guarantee as to their operability or efficiency can be given.
Made with Metropix ©2023

