

debbie fortune

ESTATE AGENTS

St. Marys Street, Axbridge

£950,000

🛏 5 🚗 3 🛋 2



A beautifully appointed former Rectory occupying a superb position within the historic market town of Axbridge. Offering versatile accommodation with as many as five bedrooms and three reception rooms, the property has a gorgeous c180' rear garden, double garage and a plethora of original features. A truly enchanting home wonderful for a family to enjoy.



Key Features

- Stunning former Georgian Rectory set in the heart of the historic village of Axbridge
- Approximately 3100 sq ft of accommodation with potential for dual occupation
- Double garage and gated off street parking
- Four/Five bedrooms with three bathrooms and two cloakrooms
- Productive fruit and vegetable garden and many established trees and plants
- Beautifully appointed throughout with wonderful period features and chic decoration
- Exceptional c180 ft south facing rear garden bounded by original stone walls
- Three Elegant reception rooms, including sitting room/dining room and spacious study
- Kitchen/Breakfast room with pantry and separate utility room
- EPC rating D. Council tax band F

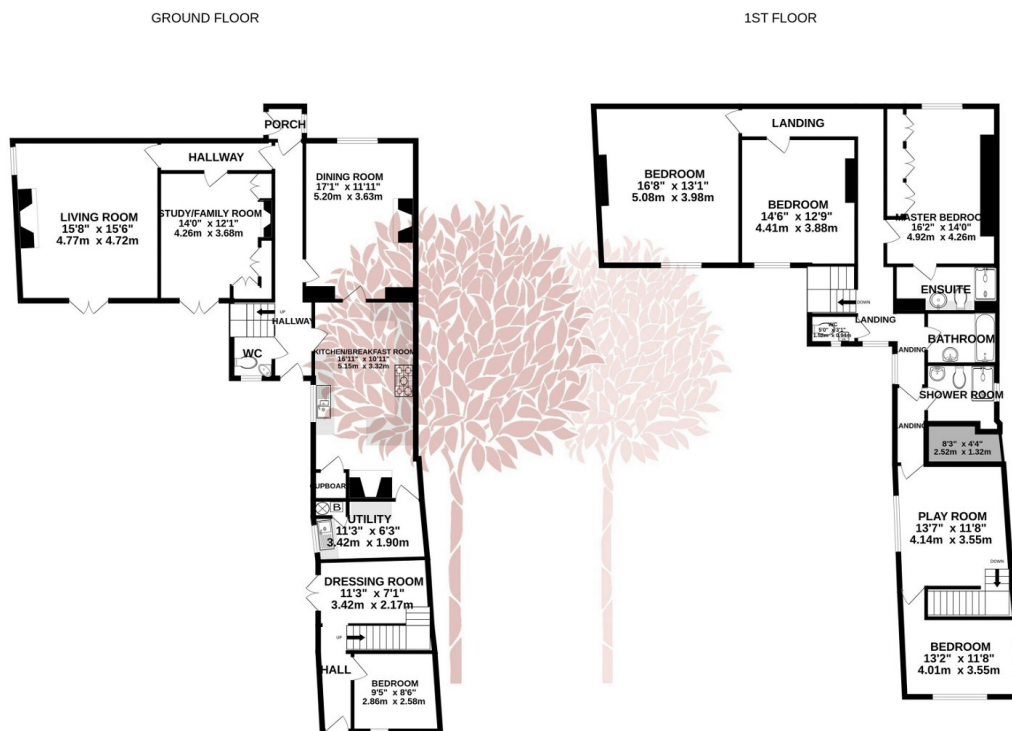

TOTAL FLOOR AREA : 2789sq.ft. (259.1 sq.m.) approx.

Whilst every attempt has been made to ensure the accuracy of the floorplan contained here, measurements of doors, windows, rooms and any other items are approximate and no responsibility is taken for any error, omission or mis-statement. This plan is for illustrative purposes only and should be used as such by any prospective purchaser. The services, systems and appliances shown have not been tested and no guarantee as to their operability or efficiency can be given.

Made with Metropix ©2024

