

Well Close, Winscombe

£349,950

🛏 2 🍷 1 🚗 1



DETACHED BUNGALOW A well looked after two double bedroom detached bungalow situated in the heart of this popular village. The property is set in pretty gardens that wrap around the property and benefits from a driveway and garage.



Key Features

- Well looked after two bedroom detached bungalow
- Off street parking and garage
- Quiet location
- Offered with no onward chain
- Council Tax Band D
- Walking distance to the amenities of Winscombe
- Modern double glazing
- Set in stunning gardens that wrap around the property
- EPC D

GROUND FLOOR
842 sq.ft. (78.2 sq.m.) approx.

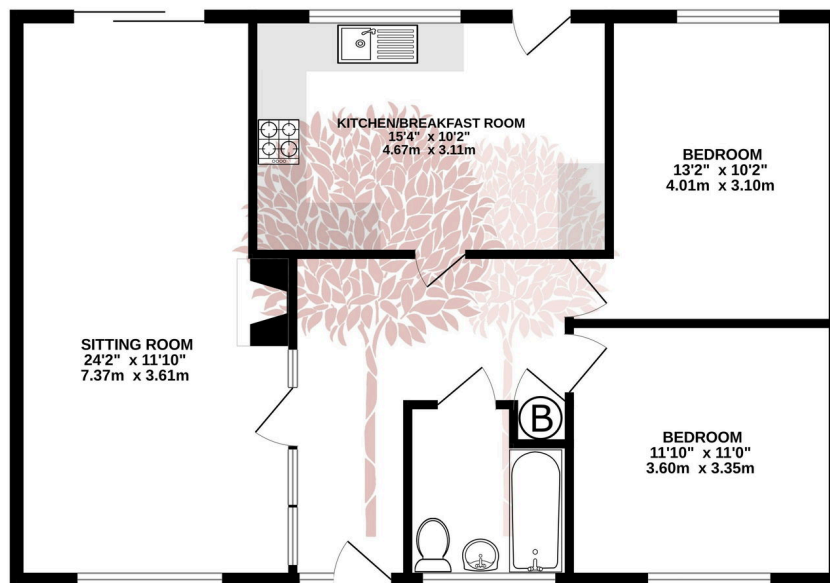

TOTAL FLOOR AREA: 842 sq.ft. (78.2 sq.m.) approx.

Whilst every attempt has been made to ensure the accuracy of the floorplan contained here, measurements of doors, windows, rooms and any other items are approximate and no responsibility is taken for any error, omission or mis-statement. This plan is for illustrative purposes only and should be used as such by any prospective purchaser. The services, systems and appliances shown have not been tested and no guarantee as to their operability or efficiency can be given.
Made with Metropix ©2024

