



The Brambles, St Georges

Offers Over £480,000

 4  3  2



An exceptional four bedroom detached house set in the sought after, edge of town suburb of St. Georges, favoured by families for its close proximity to good schools, Worle train Station and excellent transport links. Superbly presented throughout, the property has been much improved over recent years, including the amazing addition of an impressive 20' x 20' designer kitchen.



Key Features

- Superb four bedroom detached family home
- Beautifully presented throughout
- Fantastic extended kitchen with bi-fold doors to the garden
- Lovely south/west facing garden
- Stunning dual aspect sitting room with French doors
- Ample gated off street parking and converted garage
- Excellent location for both primary and secondary schools
- EPC rating C
- Council tax band E

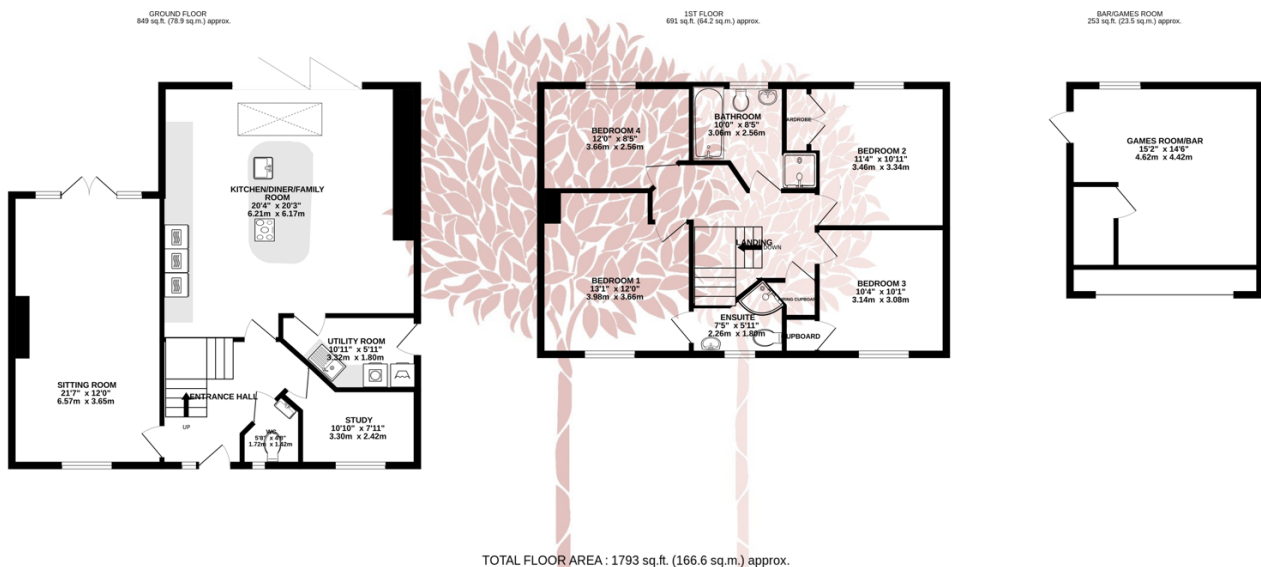

TOTAL FLOOR AREA: 1793 sq.ft. (166.6 sq.m.) approx.

Whilst every attempt has been made to ensure the accuracy of the floorplan contained here, measurements of doors, windows, rooms and any other items are approximate and no responsibility is taken for any error, omission or mis-statement. This plan is for illustrative purposes only and should be used as such by any prospective purchaser. The services, systems and appliances shown have not been tested and no guarantee as to their operability or efficiency can be given.

Made with Metropix ©2024

