

Willow Close, St. Georges

£342,500

3 2 2



FAMILY HOME - A beautifully presented, three bedroom detached home occupying a lovely corner position, with a gated driveway leading to a single garage and a private west facing garden.



Key Features

- Smart west facing garden
- Family bathroom, plus en-suite to Master bedroom
- Beautifully appointed throughout
- Smart three bedroom detached home
- Council tax band D
- Ground floor cloakroom, utility
- Dual aspect living room, plus separate dining room
- Gated off street parking and single garage
- Ideal first time buy or family purchase
- EPC rating C

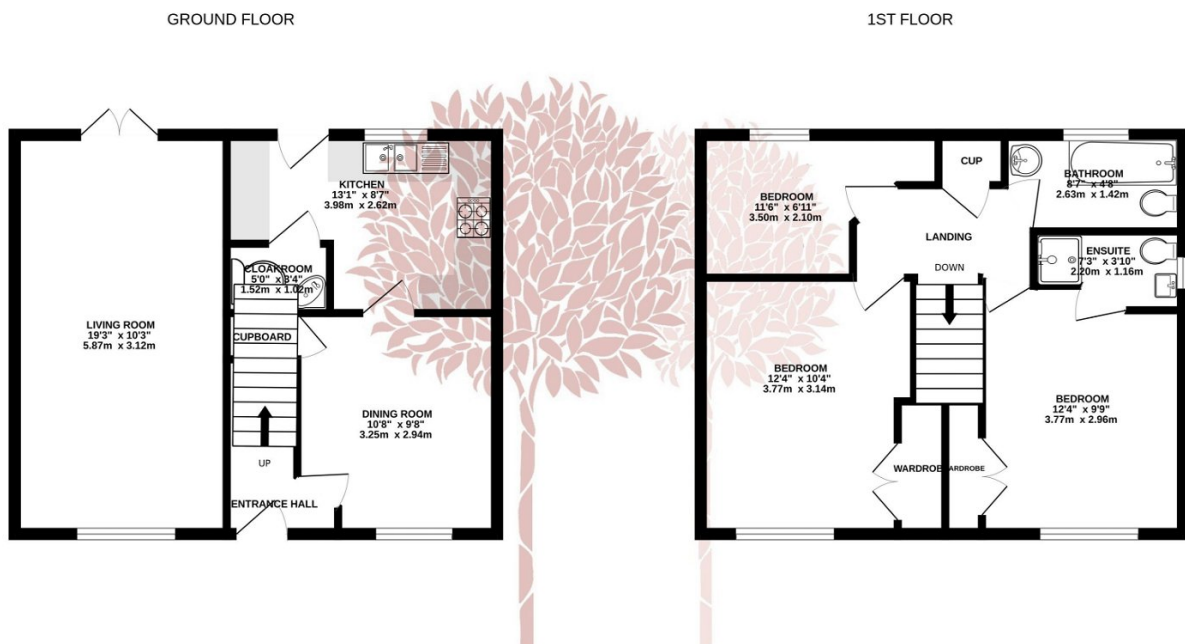

Whilst every attempt has been made to ensure the accuracy of the floorplan contained here, measurements of doors, windows, rooms and any other items are approximate and no responsibility is taken for any error, omission or mis-statement. This plan is for illustrative purposes only and should be used as such by any prospective purchaser. The services, systems and appliances shown have not been tested and no guarantee as to their operability or efficiency can be given.
Made with Metropix ©2024

