

## The Glebe, Wroughton

£199,950

🛏 2 🚿 1 🚗 1

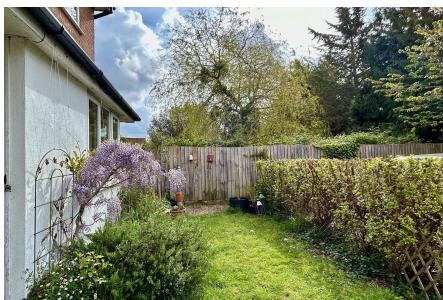

MORE PHOTOS TO  
FOLLOW  
Call for viewings

IDEAL FOR FIRST TIME BUYERS downsize or investor's purchase that occupies a lovely tucked away position within this popular development in the centre of the village of Wroughton.



## Key Features

- Modern cottage style home
- Two bedrooms
- Dual aspect kitchen
- In need of moderate updating
- Council Tax Band C
- Perfect first time buy or investment opportunity.
- Bay fronted living room
- Pretty south facing garden
- No onward chain
- 

GROUND FLOOR  
269 sq.ft. (25.0 sq.m.) approx.

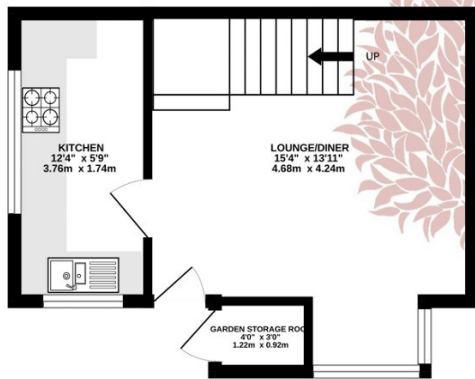

1ST FLOOR  
237 sq.ft. (22.1 sq.m.) approx.

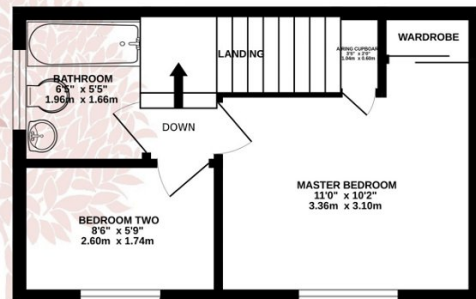

TOTAL FLOOR AREA : 507 sq.ft. (47.1 sq.m.) approx.

Whilst every attempt has been made to ensure the accuracy of the floorplan contained here, measurements of doors, windows, rooms and any other items are approximate and no responsibility is taken for any error, omission or mis-statement. This plan is for illustrative purposes only and should be used as such by any prospective purchaser. The services, systems and appliances shown have not been tested and no guarantee as to their operability or efficiency can be given.  
Made with Metropix ©2023

