

Church Lane, East Harptree

£850,000

🛏 4 🚿 3 🛋 3



LARGE CHALET BUNGALOW WITH FOUR DOUBLE BEDROOMS AND COUNTRYISDE VIEWS - in a prominent position within the village of East Harptree with four large double bedrooms, two ensuite bathrooms, three reception rooms and conservatory, there a lot to love about this home.



Key Features

- Four bedroom detached house
- Excellent condition having been well maintained
- Three reception rooms and conservatory
- Feature fireplace
- Garage
- Popular village location
- Four double bedrooms, two ensuite bathrooms, third bathroom downstairs
- Vast amount of storage
- Large enclosed garden with countryside views
- EPC D

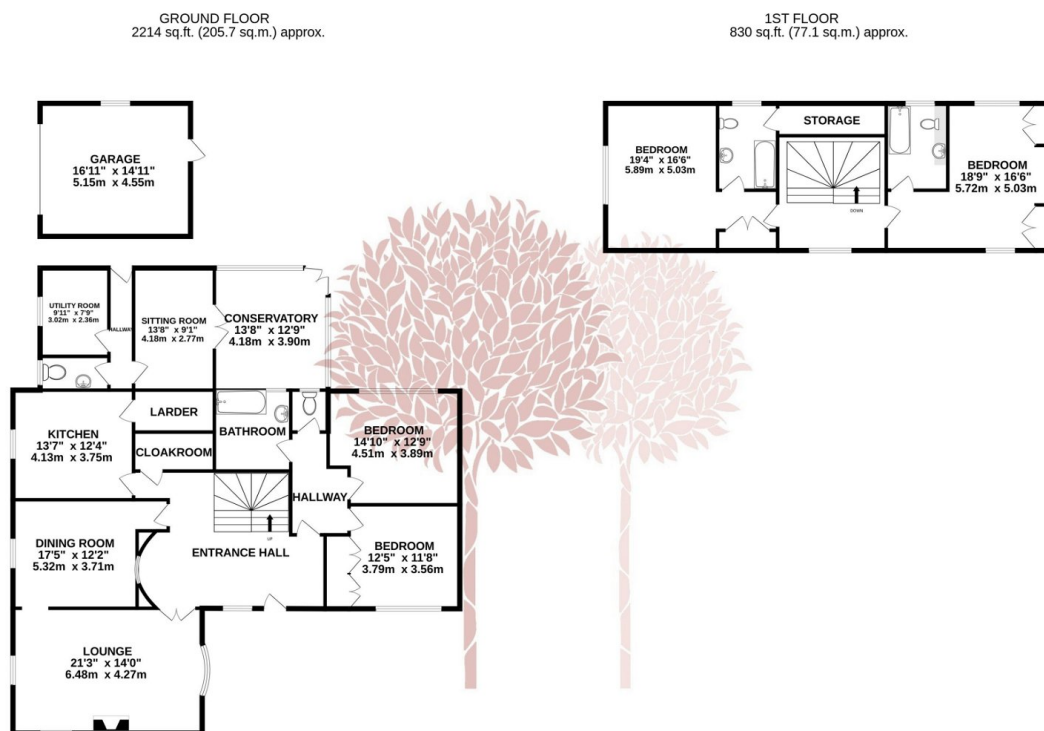

TOTAL FLOOR AREA : 3045 sq.ft. (282.8 sq.m.) approx.

Whilst every attempt has been made to ensure the accuracy of the floorplan contained here, measurements of doors, windows, rooms and any other items are approximate and no responsibility is taken for any error, omission or mis-statement. This plan is for illustrative purposes only and should be used as such by any prospective purchaser. The services, systems and appliances shown have not been tested and no guarantee as to their operability or efficiency can be given.
Made with Metropix ©2024

