



Richmont Place, East Harptree

Offers Over £800,000

 4  2  2



A SUPERIOR FOUR BED IN EAST HARPTREE - This wonderful family home has an excellent layout out and exquisite interiors. A real must see for anyone looking in the Harptree's area of the Chew Valley.



Key Features

- Four bedroom, one suite
- Open plan kitchen, diner, family room
- Separate drawing room
- Bright, light and spacious throughout
- Excellent interior and garden design
- Off street parking
- Large double garage
- Solar Panels
- NHBC valid warranty (10 years from new)
- EPC B

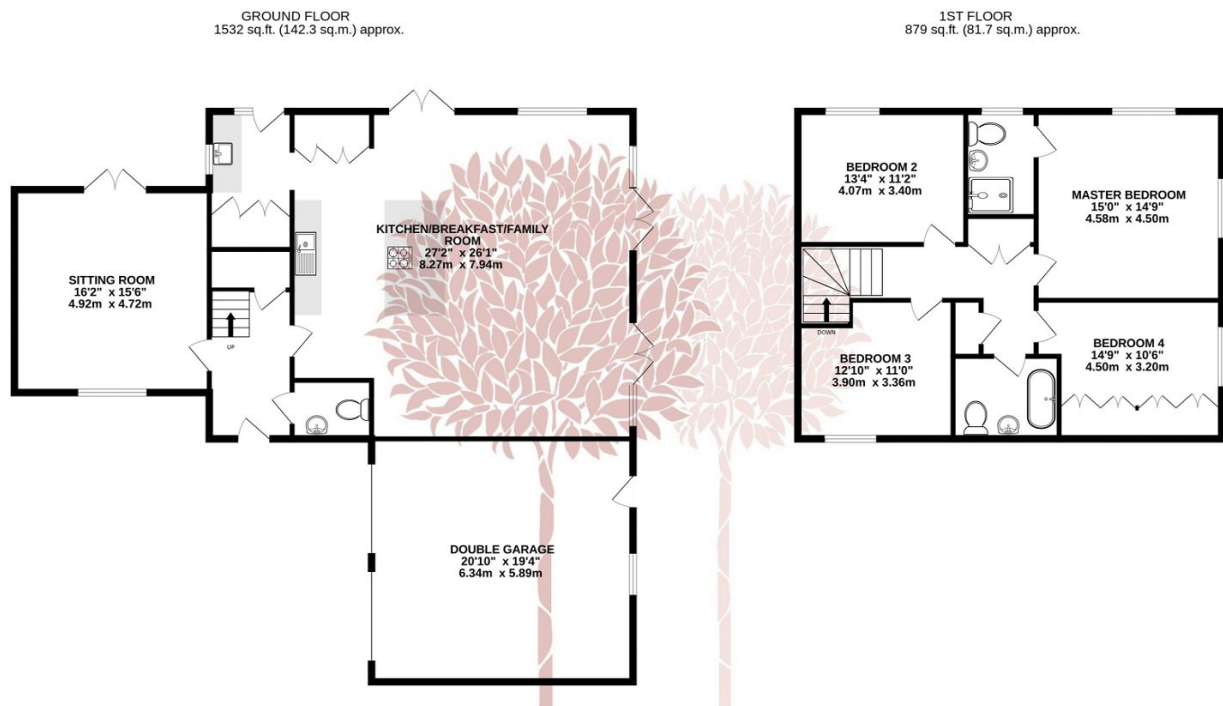

TOTAL FLOOR AREA : 2411 sq.ft. (223.9 sq.m.) approx.

Whilst every attempt has been made to ensure the accuracy of the floorplan contained here, measurements of doors, windows, rooms and any other items are approximate and no responsibility is taken for any error, omission or mis-statement. This plan is for illustrative purposes only and should be used as such by any prospective purchaser. The services, systems and appliances shown have not been tested and no guarantee as to their operability or efficiency can be given.
Made with Metropix ©2024

