

Parsons Mead, Flax Bourton

£750,000

🛏 4 🍷 2 🛋 2



A large 4 bedroom, detached family home offering stylish accommodation set in a sought after cul-de-sac. The property is perfectly situated for local schools and comes with large gardens, off street parking and a double garage.



Key Features

- Substantial detached family home with 4 double bedrooms
- Extended on the ground floor
- Front, rear and side gardens
- A short walk to Flax Bourton Church of England School
- Contemporary interior
- Newly installed air source heat pump
- Off street parking and a double garage
- En suite to the master bedroom

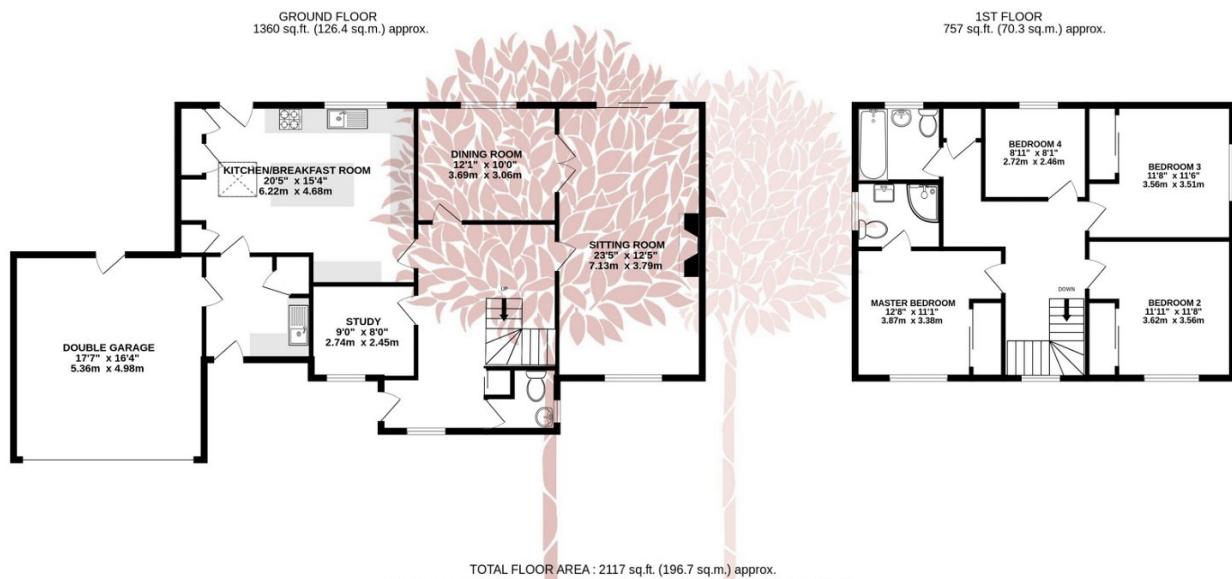

Whilst every attempt has been made to ensure the accuracy of the floorplan contained here, measurements of doors, windows, rooms and any other items are approximate and no responsibility is taken for any error, omission or mis-statement. This plan is for illustrative purposes only and should be used as such by any prospective purchaser. The services, systems and appliances shown have not been tested and no guarantee as to their operability or efficiency can be given.
Made with Metropix ©2024

