

## 11 Blackmoor Close, Langford

£495,000

🛏 3 🚿 1 🛋 2



**STUNNING SOUTH FACING GARDEN** - A spacious and versatile single level dwelling on a quiet and popular cul de sac, with a garage, plenty off street parking and large south facing garden.



## Key Features

- Superb three bedroom detached bungalow on a quiet popular cul de sac
- Large garage plus plenty of off street parking
- Chic family bathroom with clawfoot bath
- Impressive south facing private rear garden
- Plenty of potential to further enhance
- Tasteful recent renovations
- Living room with cast iron wood burner leading to lovely garden room
- Double glazing and gas central heating
- Generous utility room
- EPC D

GROUND FLOOR  
1374 sq.ft. (127.6 sq.m.) approx.

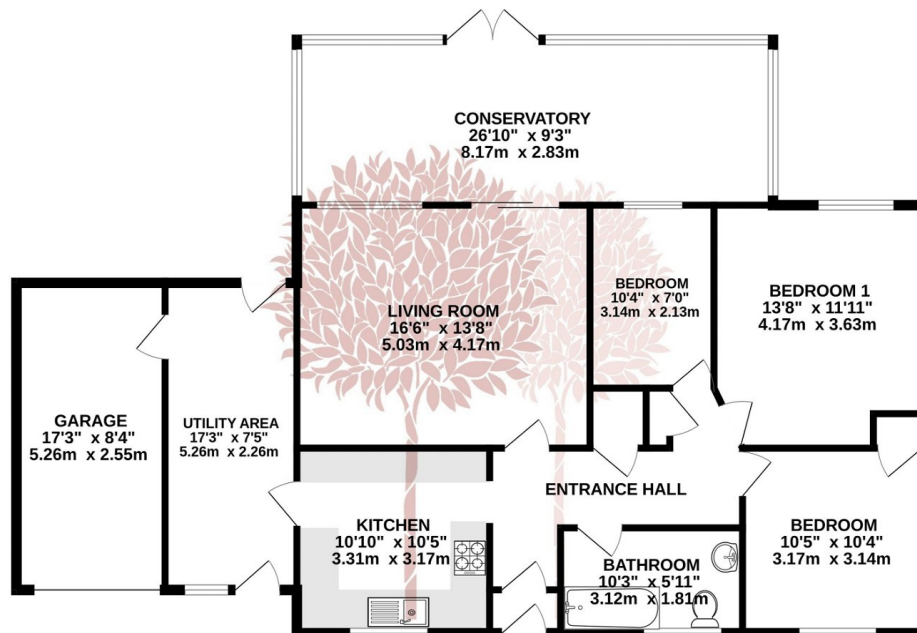

TOTAL FLOOR AREA: 1374 sq.ft. (127.6 sq.m.) approx.

Whilst every attempt has been made to ensure the accuracy of the floorplan contained here, measurements of doors, windows, rooms and any other items are approximate and no responsibility is taken for any error, omission or mis-statement. This plan is for illustrative purposes only and should be used as such by any prospective purchaser. The services, systems and appliances shown have not been tested and no guarantee as to their operability or efficiency can be given.  
Made with Metropix ©2024

