

debbie fortune

ESTATE AGENTS

Hill Park, Congresbury

£269,950

🛏️ 2 🚿 1 🛋️ 2



CHARMING - A two-bedroom semi-detached house set in a lovely, elevated position with far reaching views over Congresbury towards the Mendip Hills.



Key Features

- Perfect starter or downsize home
- Lovely, elevated position with views over the village and in the distance the Mendip Hills
- Attractive dual aspect sitting room
- First floor bathroom and downstairs cloakroom
- No onward chain
- Two double bedrooms
- Single garden, brick outbuilding and green house
- Kitchen and separate dining room
- South facing rear garden
- EPC rating D

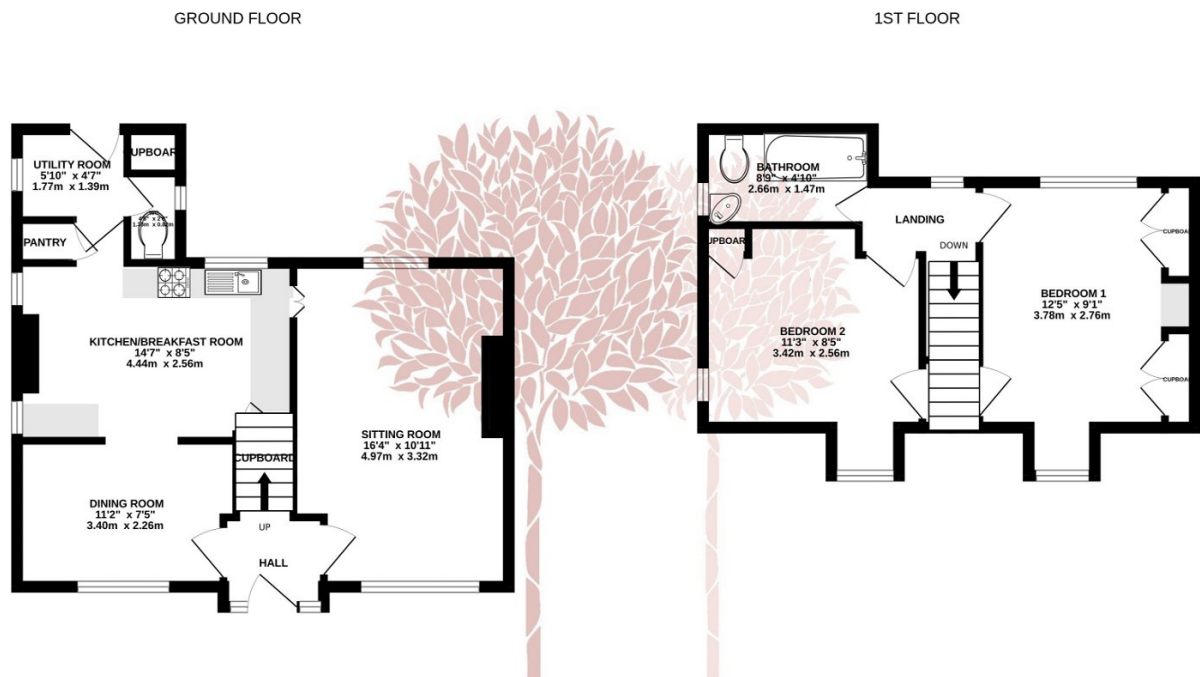

TOTAL FLOOR AREA : 871sq.ft. (80.9 sq.m.) approx.

Whilst every attempt has been made to ensure the accuracy of the floorplan contained here, measurements of doors, windows, rooms and any other items are approximate and no responsibility is taken for any error, omission or mis-statement. This plan is for illustrative purposes only and should be used as such by any prospective purchaser. The services, systems and appliances shown have not been tested and no guarantee as to their operability or efficiency can be given.

Made with Metropix ©2023

