

The Glebe, Wroughton

£245,000

2 1 1

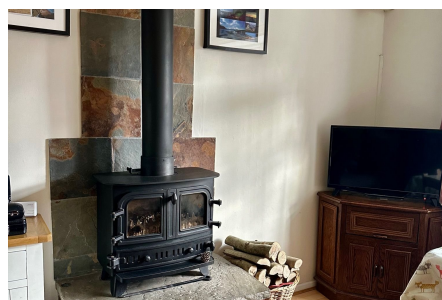

IDEAL FIRST TIME BUYERS/INVESTORS- A two bedroom end-terrace home with an open outlook and a light interior. This property benefits from allocated off street parking and pretty gardens.



Key Features

- Two bedroom end-terrace house
- Well proportioned sitting room with log burner
- Allocated off street parking for two vehicles
- Council Tax Band C
- Gas central heating
- Ideal home for First time buyers/ Investors
- Easy access to local amenities, shops and schools
- Pretty front and rear gardens
- EPC tbc
- Double glazed windows

GROUND FLOOR
273 sq.ft. (25.3 sq.m.) approx.

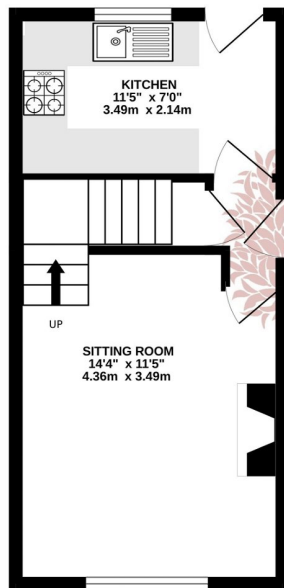

1ST FLOOR
279 sq.ft. (25.9 sq.m.) approx.

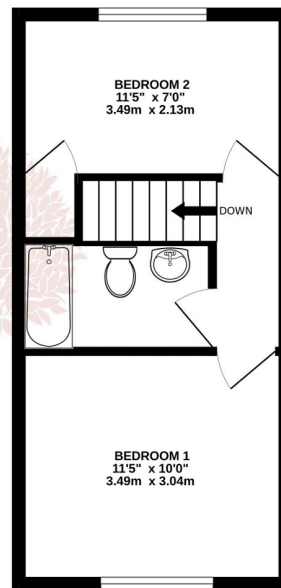

TOTAL FLOOR AREA - 552 sq.ft. (51.3 sq.m.) approx.

Whilst every attempt has been made to ensure the accuracy of the floorplan contained here, measurements of doors, windows, rooms and any other items are approximate and no responsibility is taken for any error, omission or mis-statement. This plan is for illustrative purposes only and should be used as such by any prospective purchaser. The services, systems and appliances shown have not been tested and no guarantee as to their operability or efficiency can be given.

Made with Metropix ©2024

