



Hubert Grove, SW9

£725,000

This impressive ground-floor period conversion has been artfully extended to create a home that is both contemporary and functional in equal measure. The accommodation is beautifully presented throughout and comprises a vast open plan reception room which includes a comfortable seating area, ample room to dine and a modern kitchen. Bi-folding doors open onto a low-maintenance, landscaped, southwest-facing garden. Towards the front of the property are two well-proportioned double bedrooms with fitted wardrobes and a bathroom.

Hubert Grove is a quiet residential street, ideally located for easy access to the many restaurants, shops and bars of Clapham & Brixton. Clapham North, Stockwell & Brixton Stations are just a short stroll away.

Features

- Ground Floor Garden Flat
- Open Plan Reception Room
- Modern Kitchen
- Two Double Bedrooms
- Share Of Freehold
- Southwest Facing Garden

Hubert Grove, London, SW9

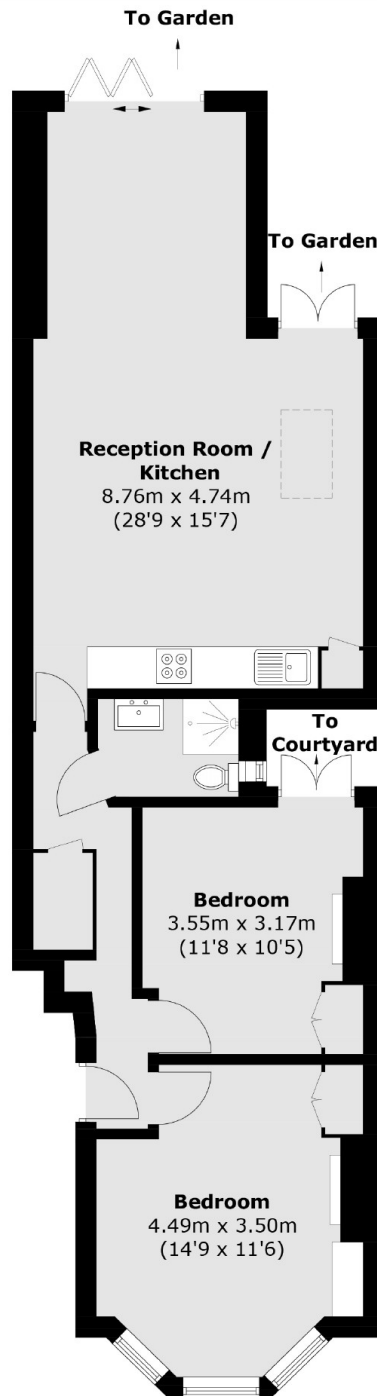

Total area (approx.): 71.8 sq. m (772.8 sq. ft)