



Englewood Road, SW12

£775,000

A spacious two double bedroom lateral conversion occupying the ground floor of a handsome double fronted Victorian family home moments from the Common.

The property is located on Englewood Road, just off Clapham Common South Side, which is a sought-after residential street popular due to its closeness to Clapham South tube, Clapham Common itself and Abbeville Village.

Features

- Lateral Conversion
- Double Fronted Victorian Home
- Two Double Bedrooms
- Eat In Kitchen
- Mature & Established Rear Garden
- No Chain



Englewood Road, SW12

The property has been well maintained and retains a number of original features, mainly the ceiling plasterwork and fireplaces. It also benefits from high ceilings with large bay windows.

The accommodation is made up of a spacious reception room, separate eat in kitchen/breakfast room, two double bedrooms with fitted wardrobes, a modern four-piece bathroom and cellar. To the rear and covering the full width of the building is a lovely landscaped garden which is part decked and part lawned garden with mature flower beds.



Englewood Road, London, SW12

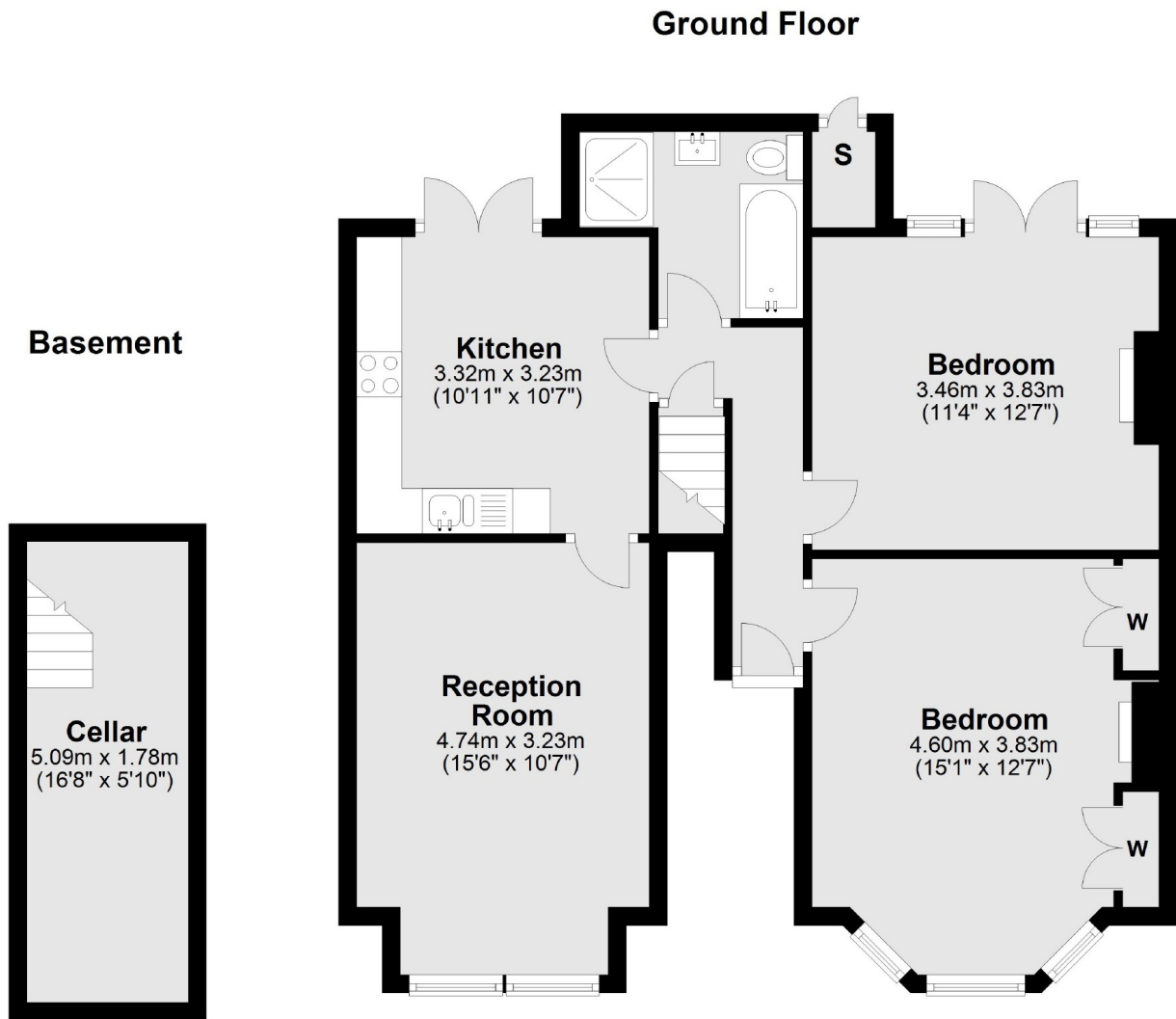

Total area: approx. 75.7 sq. metres (814.3 sq. feet)