



Bedford Hill, SW12

£765,000

Dexters



Bedford Hill, SW12

This truly impressive ground-floor period conversion exemplifies sophisticated living and meticulous design, offering generous, bright, and airy spaces for both relaxing and entertaining. The property boasts a 58 ft private, directly south-facing garden and allocated off-street parking.

Extensively refurbished to an exacting standard throughout by the current owners, this wonderful home makes an immediate impression. The well-planned accommodation includes a spacious open-plan reception room, combining a stylish seating area with a modern kitchen fitted with a range of sleek wall and base units, integrated appliances, and a central island ideal for both everyday living and entertaining. Further highlights include a principal bedroom with fitted wardrobes and an adjoining sunroom, a second double bedroom, and a beautifully presented contemporary bathroom.

Bedford Hill is ideally located in the very heart of Balham, offering convenient access to both Balham Mainline and Underground Stations (Northern Line). Residents benefit from a vibrant selection of shops, bars, and restaurants, all just a short stroll away. The expansive green spaces of Tooting Bec Common are also nearby. Additionally, the area boasts an excellent selection of high-performing state and private schools.

Features

- Period Conversion
- Modern Kitchen
- Open Plan Reception Room
- Two Double Bedrooms
- South Facing Garden
- Off-Street Parking







Bedford Hill, London, SW12

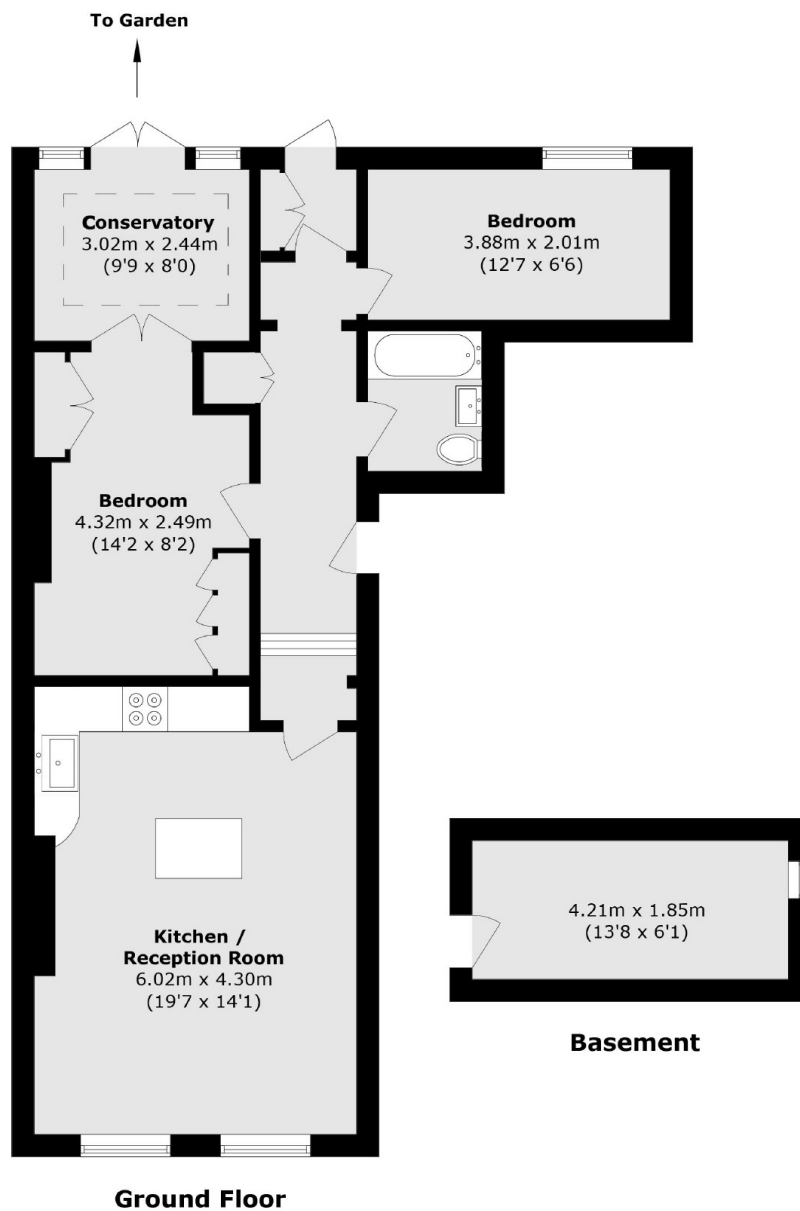

Total area (approx.) (including basement) 75sq. m (807.48 sq. ft)

Dexters

Clapham Sales
28 Abbeville Road
London
SW4 9NG
Sales
020 8742 4140

Energy Rating: D. We aim to make our particulars both accurate and reliable. However they are not guaranteed; nor do they form part of an offer or contract. If you require clarification on any points then please contact us, especially if you're traveling some distance to view. Please note that appliances and heating systems have not been tested and therefore no warranties can be given as to their good working order.

 **RICS** | Regulated
Estate Agent
and Letting Agent

dexters.co.uk