



## Bellamy Street, SW12

### £825,000

An exciting opportunity to acquire an unextended freehold house situated in the heart of the Nightingale Triangle, comprising a double reception room, a kitchen, two bedrooms and a further cloakroom, outside there is a garden.

Bellamy Street is a stone's throw away from Clapham South Underground Station (Zone 2) providing direct links to the City and the West End. The numerous cafes, restaurants, shops and bars local to Clapham Old Town, Northcote Road, Clapham South, Balham and Abbeville are also within a short stroll of this highly desirable flat, as are the green open spaces of Clapham Common.

### Features

- Freehold House
- Double Reception Room
- Kitchen
- Two Bedrooms
- Garden
- Chain Free

# Bellamy Street, London, SW12

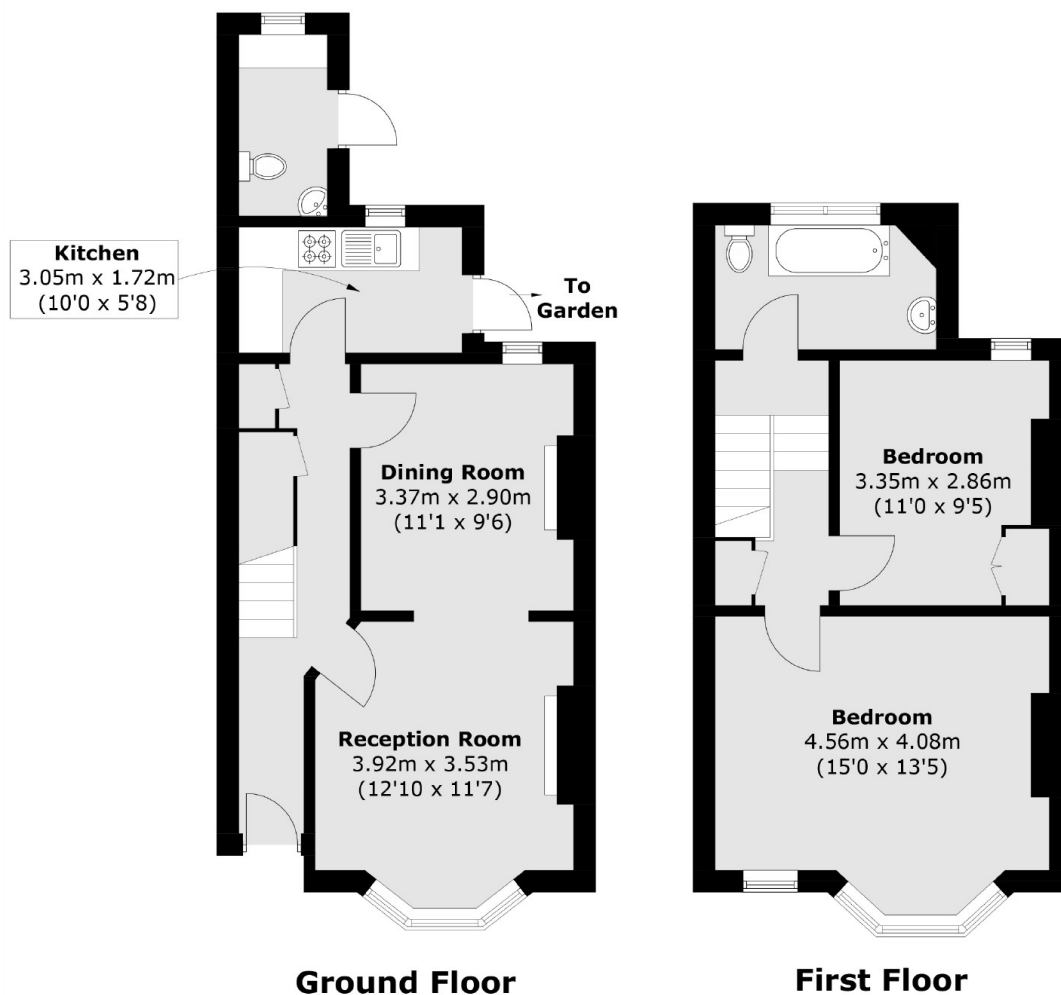

Total area (approx.): 76.2sq. m (820.2 sq. ft)  
External Bathroom: 3.1 sq. m (33.4 sq. ft)